



BUGLIT™

LED BIKE LIGHT

With its whimsical design and serious functionality the Nite Ize® BugLit™ -LED Bike Light keeps you safely visible on those early morning/late evening rides - with distinction!

The BugLit™ -LED Bike Light puts an innovative twist on bicycle safety with its universally recognized white (for front) and red (for rear) lights, to keep your bike safely seen by other commuters when you're out riding in the dark. The BugLit™ -LED Bike Light body is actually our powerful INOVA® Microlight—a tough micro LED flashlight encased in a durable polycarbonate plastic housing, with four functions (high power, low power, strobe, and signal). This bright LED has an effective range of up to 50 feet, and one-mile visibility. Securely attached legs are two flexible, "grippy" 6-inch Nite Ize® Gear Ties®, which can be wrapped around your bike's handlebars, basket, frame, bike rack or seat post. The lightweight plastic S-Biner® also allows you to hang or attach it to any convenient location. The BugLit™ -LED Bike Light's legs also fold neatly around the body for compact attachment to zippers or keys.

- + Available in Red & White LED colors
- + Four functions – High, Low, Strobe and Signal Mode
- + Includes easily replaceable batteries – 2 x 2016 3V Lithium
- + Weather resistant
- + Easy to attach and detach - no tools required!
- + Features Gear Tie® Technology
 - Can be easily removed and replaced
 - UV resistant – will not be damaged or destroyed by extended sun exposure
 - Strong wire inside holds its shape to attach securely wherever you twist it!
 - Won't scratch or mark
 - Twist it, tie it, reuse it
- + Size #0 S-Biner® is a durable, lightweight double gated carabiner clip – attach or store nearly anywhere!
- + Try it packaging

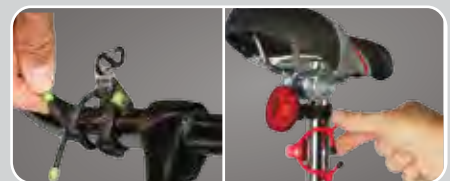

ANSI/NEMA FL1 STANDARDS



(for white only)

Retail Packaging
Dimensions:
8.5" H x 4.1" L x 0.7" D

