



GENESIS[®] RECHARGABLE LED FLASHLIGHT

Operating and Maintenance
Instructions
Notice d'utilisation et d'entretien
und Wartungsanleitung

www.princetonotec.com

ENGLISH

Charging

• **NOTE:** Fully charge battery before use.

To charge the 18650 battery, insert the appropriate end of cable into battery USB port, and the other end of cable into suitable charger. An acceptable charger has a USB port with output between 500 mA and 2,000 mA. The red LED on the battery should light to indicate charging has begun.

WARNING: During charging, positive (+) battery terminal serves as a heat sink for internal charge circuitry. Please do not touch the terminal during or immediately after charging to avoid risk of burn.

LED Charging Indicators

The LED on the positive end of the battery housing lights when the cable is correctly installed.

- **Charging** - Red LED is illuminated.
- **Charged** - Green LED is illuminated.

Charge time is approximately 4.5 hours.

IMPORTANT: Maximum charging temperature range is 20°F to 115°F with optimal temperature range between 50°F and 86°F. A safety circuit prevents charging outside the maximum range and the red charge LED will pulse rapidly. When temperature is within an acceptable range charging will resume.

Battery Installation

– See Battery Installation Diagram

Genesis uses one 18650 Lithium Battery, as supplied by Princeton Tec. It is also compatible with CR123 batteries.

When not using Genesis, separate the head and tail by turning counterclockwise approximately one turn. This will prevent accidental activation. Remove batteries when storing Genesis.

Observe proper battery polarity when installing the batteries. Improper installation of the batteries will damage light and void warranty.

Princeton Tec cares about the environment and recommends recycling batteries. For more information about battery recycling, please go to:
www.batteryrecycling.com

WARNING ⚠

- **CAUTION:** To reduce risk of fire, electrical shock, or personal injury, do not use a damaged charger.
- Do not disassemble or try to repair the battery. Return it to a qualified service facility or the factory.
- Recycle worn out or damaged batteries properly.
- **CAUTION:** To reduce risk of fire, electrical shock, or injury, handle the battery carefully and never allow it to short circuit. Do not incinerate the battery.
- Genesis is designed primarily for use under water. While the flashlight can also be used above water, extended use should be avoided. Always take care to avoid overheating and damaging the flashlight or causing burns.

Figure 1 – Switch Operation

Opération de commutation

Schalterbetätigung



- Princeton Tec calculates total burn time as the time it takes for the light source to produce a minimum of 0.25 lux at 2 meters. 0.25 lux is about the equivalent of a full moon on a clear night.
- Princeton Tec berechnet die Gesamtbrenndauer bezogen auf eine von der Stirnlampe erzeugte minimale Beleuchtungsstärke von 0,25 Lux in 2 Meter Abstand. 0,25 Lux entsprechen in etwa der Beleuchtungsstärke des Vollmonds in einer klaren Nacht.
- Princeton Tec définit la durée totale d'éclairage comme le temps nécessaire à la source lumineuse pour produire un minimum de 0,25 lux à 2 mètres. 0,25 lux équivaut à peu près à la luminosité d'une pleine lune dans un ciel nocturne dégagé.

Figure 2 – Battery Replacement

Remplacement des piles

Betriebsartenswitcher



Figure 2 – Charging

Charge

Ladevorgang

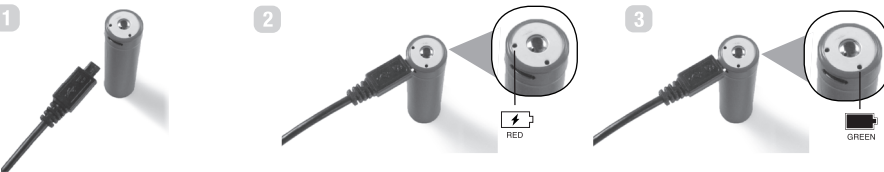

- Never mix fresh and used batteries.
- Never mix different battery brands or chemistry types.
- Always remove drained batteries immediately.
- Remove batteries during long periods of storage.

NOTE: Lithium batteries offer extended constant brightness time, 10 year shelf life, extreme cold weather performance, and lighter weight than other battery types.

Genesis has waterproof seals. It is important to keep these seals free from dirt and away from harsh chemicals to preserve waterproof integrity. Inspect seals every time the battery is changed. If dirt is present, wipe gently with a damp cloth and mild soap until dirt is removed. Add silicone lubricant to the seals if they appear dry or after cleaning. Do not use petroleum based products to lubricate seals.

Switch Operation

– See operation diagram

A single press of the recessed switch activates Genesis, while subsequent presses cycle through modes and turn the light off. Genesis has high output, low output, and SOS modes.

The integrated Power Indicator glows blue during regular burn time, turning red with approximately 25% of burn time remaining.

O-Ring and Lens Cap

Occasionally clean and lightly lubricate the O-ring and Lens Cap threads. Use only silicone grease, never use aerosol spray lubricants. Certain types of aerosol sprays can cause damage the plastic and void the warranty.

General Maintenance

As with any outdoor equipment, the light should be kept clean with mild soap and water. Avoid getting dirt on the o-ring and in the threads of the lens cap. If this should occur, take the light apart, remove the o-ring, light module and batteries, then clean the light body, lens and o-ring re-lubricate the o-ring and reassemble the light.

Troubleshooting

- If the Genesis fails to light:
- Check the batteries for proper installation.
 - Replace batteries if proper installation is confirmed.
 - Check the light for water contamination. The light will resume normal operation once the water is shaken or blown out and the light is left open until completely dry. If the light has been contaminated with salt water, flush the unit with fresh water and dry as described above

USA– International 1-Year Warranty

WARRANTY – Princeton Tec warrants this product to be free from defects in workmanship and materials under normal use for one year from the original date of purchase. This warranty covers all of the component parts of the product except batteries. This warranty does not cover deterioration due to normal wear or damage due to misuse, alteration, negligence, accidents, or unauthorized repair. Princeton Tec will repair or replace parts which are defective in workmanship or materials. Your authorized Princeton Tec Dealer and Princeton Tec are the only facilities authorized to repair the product. After (3) unsuccessful attempts (within the warranty period) to repair the product, you have the right to elect replacement of the product or a refund of the purchase price less allowance for use of the product. **NO INCIDENTAL OR CONSEQUENTIAL DAMAGES ARE INCLUDED IN THIS WARRANTY.** (Some states do not allow the exclusion or limitation of incidental or consequential damages, so the above limitations or exclusions may not apply to you.) This warranty gives you specific legal rights, and you may also have other rights which vary from state to state.

Princeton Tec reserves the right to change product specifications without notice.

Return Policy

If your light fails to operate, follow these simple steps:

1. Check batteries. Replace if necessary.
2. To send your light in for repair or replacement, first contact Princeton Tec customer service on **1-800-257-9080** to request an RMA number. Please have your light model, date of purchase and a brief description of the fault you are experiencing. No warranty repairs will be accepted without an RMA number.
3. Return the light without batteries to: Princeton Tec, **PO Box 8057 Trenton NJ 08650**. Postage due and freight collect items will not be accepted.
4. Upon receipt your light will be processed in about two weeks. Please allow additional time for return transportation from NJ

Princeton Tec
PO Box 8057,
Trenton, NJ 08650
Phone: 609-298-9331
Fax: 609-298-9601
www.princetonotec.com
© 2018 Princeton Tec



