

CROWN HEAD II - EXPLODED PARTS VIEW (Manufactured after June 2002)

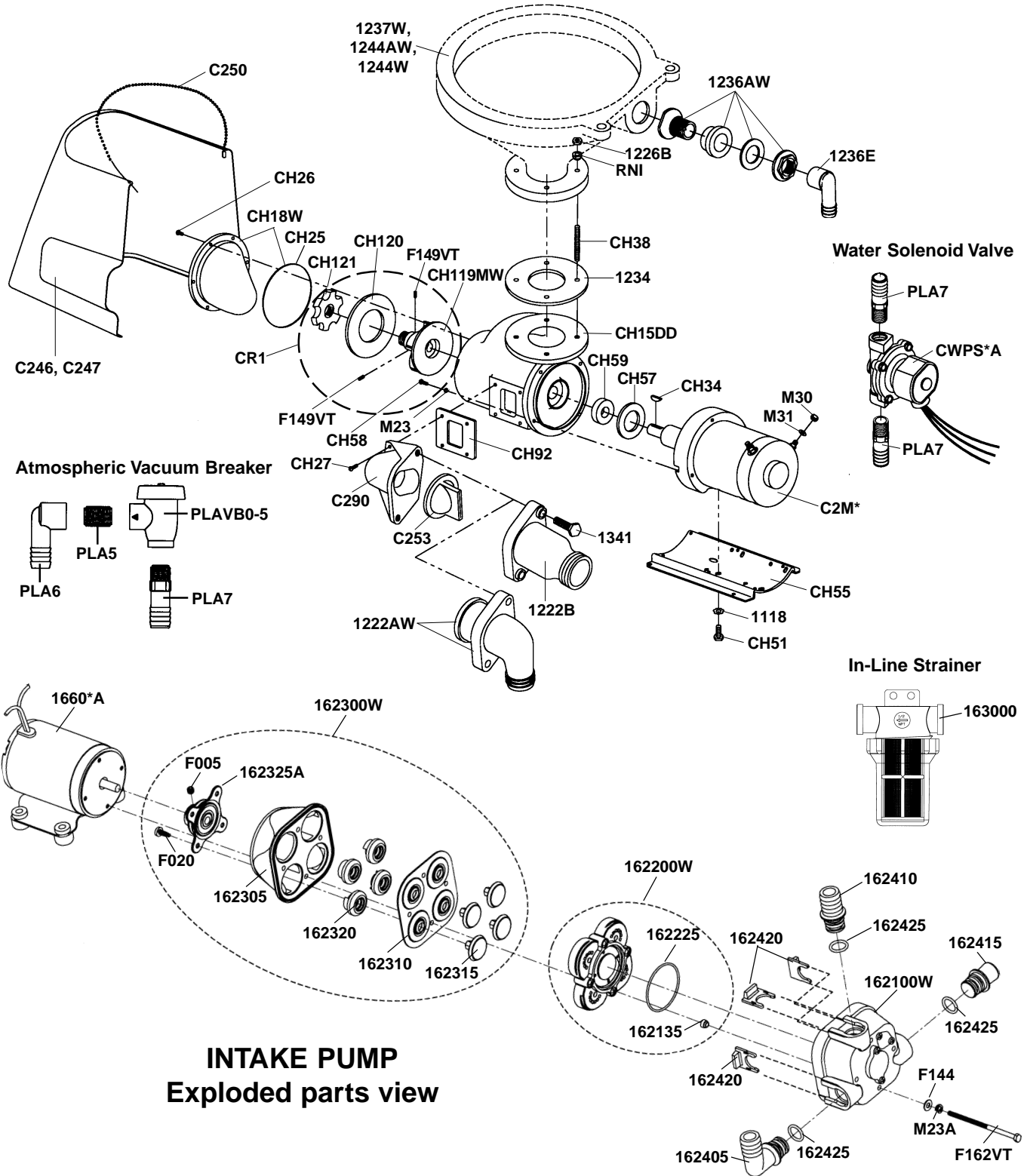

INTAKE PUMP
Exploded parts view



RARITAN
Engineering Company, Inc.

530 Orange Street, P.O. Box 1157, Millville, NJ 08332 USA
 Telephone: 856-825-4900 FAX: 856-825-4409
 www.raritaneng.com
 Southern Office and Plant:
 3101 SW Second Avenue, Fort Lauderdale, FL 33315 USA
 Telephone: 954-525-0378 FAX: 954-764-4370

CROWN HEAD II - Parts List

Part #	Description	Part #	Description
1118	Lockwasher (4)	CH119MW	Discharge Impeller Assy. includes CH119M, F149VT [2])
1222AW	90 Degree discharge (opt.)	CH120	Discharge Pump Wall
1222B	Straight discharge	CH121	Macerator
1226B	1/4" - 20 S/S Hex Nut (4)	CH15DD	End Bell
1234	Bowl Gasket	CH18W	Front Cover w/"O" Ring
1236AW	Bowl Spud Assembly	CH25	Front Cover "O" Ring
1236E	Bowl Elbow	CH26	Front Cover Screw (6)
1237W	Marine-size Bowl Assembly (White) (Not shown)	CH27	Mounting Screw (4)10-32x5/8" S/S
1238A	Marine-size Seat and Cover (White) (Not shown)	CH34	Woodruff Key
1244AW	Household-style Bowl Assembly, (Bone) includes 1236AW	CH38	Bowl Stud (4)
1244W	Household-style Bowl Assembly, (White) includes 1236AW	CH51	Base Mounting Screw (4)
1245	Household-style Seat and Cover (White) (Not shown)	CH52	Rubber Mounting Strip (2), (Not shown)
1245A	Household-style Seat and Cover (Bone) (Not shown)	CH55	Base Plate
1341	Discharge Screw (2)	CH57	Rubber Slinger
162000W	Intake Pump Assembly includes 162100W, 162200W, 162300W	CH58	Fillister Head Screw (4) 10-32x3/4" S/S
162100W	Upper Housing Assembly	CH59	Seal
162200W	Middle Housing Assembly	CH92	Square Rubber Gasket
162300W	Lower Housing Assembly	CR1	Discharge Impeller and Macerator Assembly includes CH120, CH121, F149VT(2), CH119MW
162135	Cone Seal	F005	Set Screw
162225	O-Ring	F020	Piston Fastener (4)
162305	Lower Housing includes 162315	F144	Mounting Bolt Washer (4)
162310	Diaphragm includes 162315	F149VT	Set Screw (2)
162315	Piston (4)	F161	Cap Fastener (4)
162320	Piston Seat (4) includes 162315	F162VT	Mounting Bolt
162325A	Bearing Plate Assembly includes F005, 162315	LWPLUG	3/8" Plastic Plug
162405	3/4" Hose Barb - 90° Fitting	M23A	#10 Lockwasher (4)
162410	3/4" Hose Barb - Straight Fitting	M30	1/4" - 20 Brass Nut (4)
162415	Plug Fitting	M31	#14 Brass Washer (4)
162420	Fitting Clip (3)	RNI	Nylon Shoulder Washer (4)
162425	Fitting O-Ring (3)	WATER SOLENOID VALVE	
163000	In-line Strainer	CWPS*A	1/2" GC Solenoid Valve
164000	Heavy Duty Push Button Switch (Not shown)	CWPSMB	Mounting Bracket for CWPS (Not shown)
1660*A	Remote Motor	PLA7	Male Adapter 1/2 MNPTx3/4 Barb (2)
166000	Diaphragm Intake Pump Assembly 12V includes 162100W, 162200W, 162300W, 1660*A	ATMOSPHERIC VACUUM BREAKER	
166100	Diaphragm Intake Pump Assembly 24V includes 162100W, 162200W, 162300W, 1660*A	PLAVB0-5	Atmospheric Vacuum Breaker
166200	Diaphragm Intake Pump Assembly 32V includes 162100W, 162200W, 162300W, 1660*A	PLA5	1/2" MPT PVC Nipple
31-102	Motor Shaft Seal w/316 Spring (Not shown)	PLA6	1/2" FPT to 3/4" Barbed Elbow
C2M*	Crown Head II Motor, 12, 24, 32 VDC	PLA7	Male Adapter 1/2 MNPTx3/4 Barb
C246	Lower Cover, Bone, Household-style	ADDITIONAL ACCESSORIES AVAILABLE	
C247	Lower Cover, White, Household-style	C2DC*	Crown II Deluxe Control (Not shown)
C250	Beaded Wire Tie	FWSC	Fresh Water Strainer (Not shown)
C253	Joker Valve	RTC*	Raritime Solid State Timer with solenoid (Not shown)
C290	Discharge Adapter	SH	Sanitation Hose (Not shown)
		SWF100+	Flush Control (Not shown)
		TWK	Toilet Water Kit (Not shown)
		VL1½W	Vented Loop 1½" (Not shown)

* Specify Voltage

+ Specify Color