

## Waterproof LED Controller



### Technical Parameter

Input voltage: DC12/24V  
 Output channel: RGB three channels  
 Output current: 6A per channel  
 Output power: 216W (12V input) /432W (24V input)  
 Waterproof: IP65

Group control (one remote controller can control several controllers)  
 When the remote is on the state of active, pressing key 1-9 then the"#" can change the remote's address code.(For example, Once pressing 1,#,the address code of remote is 1;if pressing 1,3, #,the address code will change to 13.)  
 (For detailed information, please refer to the specifications of LLB-45AR-08-OD Remote)



### Features

The LLB-45AR-08 waterproof controller is designed for normal RGB LED strips and low voltage RGB LED luminaries. It has 16 pre-positioned patterns. The controller is easy to use by the unique touch interface technology and the humanized design. Not only the touch interface but also a paired wireless remote control (two remote control optional: 8 key remote control and touch remote control) within the distance of 30m can be used. With the learning function, it applies to the same model remote control in different encodings addresses. The controller is compatible with 12V DC and 24V DC, so it can be used for most RGB LED products in the market. Besides, the controller set a MCU internal PWM dimming hardware to achieve flickerless dimming. High-power MOS drive, and the total current of RGB three channels drive reach 18A.

### Dimensions

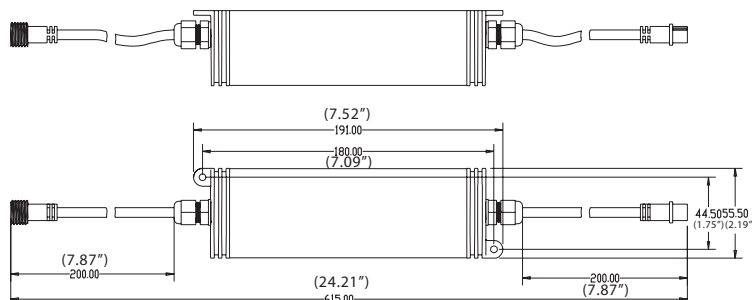

### Function Descriptions

1. 16 color patterns, for example, seven colors static (individually adjustable), jump, and gradual change (with pausing function)
2. 50 levels of brightness adjustment
3. 50 levels of speed regulation

## Color Patterns

---

- |                  |                          |                                |
|------------------|--------------------------|--------------------------------|
| 1. Static red    | 6. Static cyan           | 11. Blue gradual change        |
| 2. Static green  | 7. Static white          | 12. Yellow gradual change      |
| 3. Static blue   | 8. Seven-color jump      | 13. Purple gradual change      |
| 4. Static yellow | 9. Red gradual change    | 14. Cyan gradual change        |
| 5. Static purple | 10. Green gradual change | 15. White gradual change       |
|                  |                          | 16. Seven-color gradual change |

## Operation Descriptions

---

- |  |   |
|--|---|
| 1) keys function description   | 8 -> POWER  |
| 1.POWER key, power switch  | 7 -> PAUSE  |
| 2.PAUSE key, you can pause in gradient mode, and static color invalid  | 6 -> MODE+  |
| 3.MODE+, Model plus  | 5 -> MODE-  |
| 4.MODE-, Model reduction   | 4 -> SPEED+   |
| 5.SPEED+, Gradient speed plus, static color invalid  | 3 -> SPEED-   |
| 6.SPEED-, Gradient speed reduction, static color invalid   | 2 -> BRT+   |
| 7.BRT+, Brightness increases, the gradient mode is invalid   | 1 -> BRT-   |
| 8.BRT-, Brightness reduce, the gradient mode is invalid  |   |
| 2) the key role description of 8 key remote control (when the 8 key remote control is optional)<br>The key roles of remote control | 3) Remote address learning (applies to the same model remote control in different encodings addresses, the 8 key remote control and touch remote control are in the same learning way)<br>1.Touch the POWER key, close the waterproof controller<br>2.Touch the PAUSE key, light red light, the controller enter the address learning mode<br>3.Press the POWER key,light green light,the remote address learning success |

## Safety Information

---

- (1) Please be sure each channel has the max. load 6A. Overload in current may destroy the controller.
- (2) The controller uses constant voltage driving mode, so its working voltage as the same as its feeding power supply. Please choose the right DC power supply to avoid destroying the luminaries.
- (3) Please use the DC 12V/24V power supply for the controller. Do not use the civil high voltage power supply directly.

## LED Remote Controller

### Technical Parameter

1. Battery capacity: 800mAh
2. Standby current:  $<50 \mu A$
3. Standby time: 1 year
4. Battery running: 10 hours
5. Charge time: 4 hours
6. Number of Charge cycles: 500 times



### Features

The Touch remote control is match with the RGB and the LLB-45AR-08 controller of Lunasea. It can change the color, the pattern and the variation rate choice, and adjust the light, when the change suspends the light can be adjusted and so on. The whole control panel is touching method, no machinery wears which is good for the control's life. The user only needs to touch the key for the wireless control, especially suitable for lives.

### Dimensions

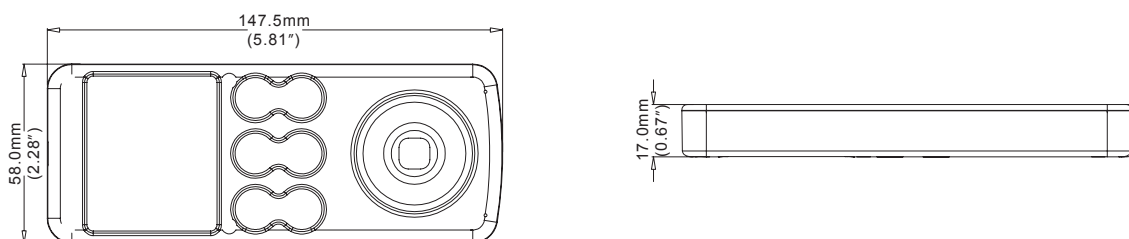

### Function Descriptions

- 1) More than 60 kinds of colors choice
- 2) Can show the color which the control sets
- 3) More than 90 kinds of scene choice
- 4) Auto sleep function after 60 seconds, save energy
- 5) Group control (one remote controller can control several controllers)

## Operation Descriptions

---

### 1) Match the remote control address with the control

First: After the controller joins RGB LED product, on the electricity, presses the "POWER" key, the controller output closure.

Second: Press the "Pause" key, the controller output will be in the red light to show it have been in the state of indentifying the address.

Third: Press any key of the remote controller, the controller output will be in the green light to show it has received the signal of controller.

Forth: Press the power key to test whether the set is ok, if not please try again,

### 2) The Function description of the key

Color pulley: Sliding a finger on the color pulley to choose a receptor output color of 64 colors choice. (The correct way of operation: clockwise sliding your finger on the color pulley)

Function keys: MODE+, MODE- Mode selection

SPEED+, SPEED- Speed selection

BRT+, BRT- Brightness selection

### 3) Group control (one remote controller can control several controllers)

When the remote is on the state of active, pressing key 1-9 then the "#" can change the remote's address code. (For example, Once pressing 1,#, the address code of remote is 1; if pressing 1,3,#, the address code will change to 13.)

Application examples: a remote control A, B, C, D four receptors

First, please set a different address respectively for receptor A, B, C, D according to the step of "pair address of receptors and remotes". (For example, set receptor A to 1, receptor B to 2, receptor C to 3 and receptor D to 4. The address can be set to a 1-digit or 2-digit optionally, but you must remember it. Please set the address again if you forget.)

Second, when the receptor and remote are paired up, you can press digital key 1, then the key "#" to control the receptor A (Because the address of receptor A has been set to 1 when you pairing the address of receptors and remotes). Pressing digital key 2, then "#" is to control the receptor B, and you can control other receptors like that. Only when you switch between different receptors will need to reset the address of the remote to match the receptor. The remote will save the last address when the power is turned off.

### 4) In order to guarantee the life of battery, we set up 60 seconds auto dormancy function for the remote. That is, without using remote for 60 seconds, it will enter into a state of auto dormancy. To awaken it, please press the power key.

## Safety Information

---

(1) Please connect the USB terminal with the computer USB connector or other connector which can supply 5V power.

(2) The red light will be on when in charging, if finished the light will be off.

(3) The charging time should be 8h to 10h for the first four times which will be good for the battery.