



# REAL-FEEL™ FOOT PEDAL INSTRUCTIONS

## TOOLS

- Fine-tip Marker
- Electric Drill
- 9/64" Drill Bit
- Phillips Head Bit

## INCLUDED HARDWARE

LABEL	ITEM #	DESCRIPTION	QTY.
A	SA-0032	Foot Pedal Assembly	1
B	AVG-MH-WS-0283	Small Stainless Washer	4
C	AVG-MH-SC-0278	#10 x 1 1/4" Panhead Sheet Metal Screw	4
D	AVG-MP-1003	Heat Shrink Butt Connector, 14-16 AWG	1
E	AVG-MP-1011	Heat Shrink Ring Terminal, 14-16 AWG #10	2
F	AVG-MP-1012	Heat Shrink Ring Terminal, 14-16 AWG, 3/8"	2
G	AVG-MP-0934	Fuse Holder, ATC, and ATO, 14 AWG, Red Leads	1
H	magnet-bot-PP	Pairing Magnet	1

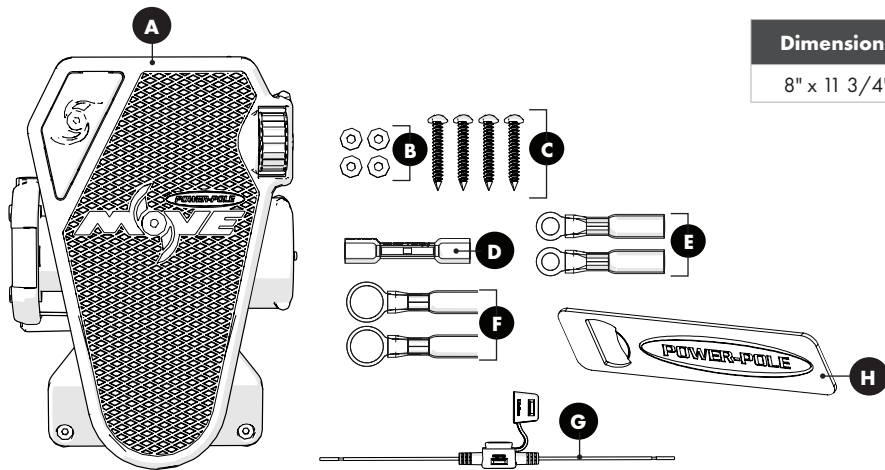

Dimensions	Cord Length	Wire Gage	Fuse Size
8" x 11 3/4"	~5'	14 AWG	3 Amp Mini



Check the area beneath where the Foot Pedal will be mounted to ensure there are no hoses, wires, lines, tanks, or other sensitive components.

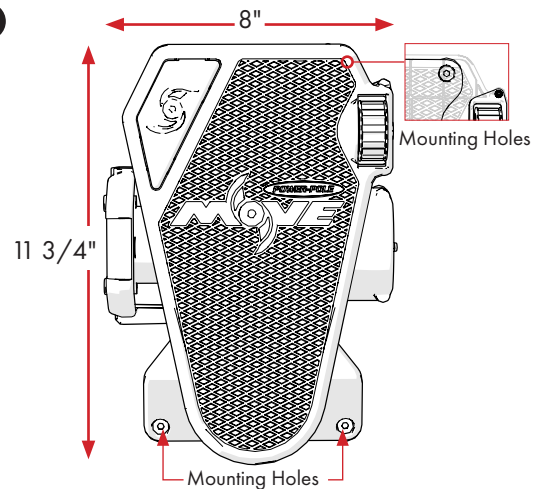

## DRILL MOUNTING HOLES

**STEP 1** Choose a flat surface with adequate space to mount the **Foot Pedal** **A**.

**STEP 2** Using the included mounting template, mark and drill (4) pilot holes for **Mounting Screws** **C** using a **9/64" Drill Bit**.

**IMPORTANT!** If installing to gel-coat, follow the drilling procedure in **Appendix A** of the Installation & Owner's Guide to ensure you do not crack or chip the gel-coat.

Need help? Contact our Technical Support Team at **1 + 813.689.9932 Option 2**



## REAL-FEEL™ FOOT PEDAL INSTRUCTIONS

### INSTALL MOUNTING HARDWARE

Using a **#2 Phillips Head Bit** and **Electric Drill**, install mounting hardware in order and tighten snug.

1. (4) **#10 x 1 1/4" Panhead Screws** **C**
2. (4) **Washers** **B**
3. **Foot Pedal Assembly** **A**

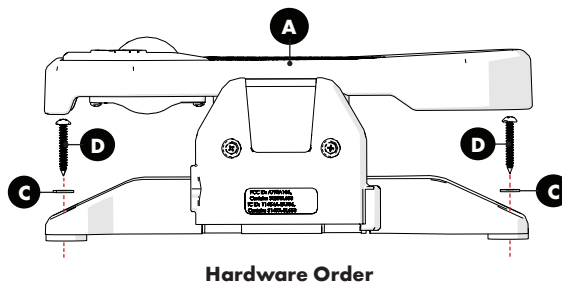

### CONNECT TO POWER

**NOTICE:** Follow **Appendix B** of the Installation & Owner's Guide for proper ring terminal and butt connector installation procedures.

**STEP 1** Route wire to power.

**STEP 2** Attach the **Fuse Holder** **G** to the **positive (+)** lead from the **Foot Pedal** **A** using **Butt Connector** **D**.

**STEP 3** Depending on post size, attach the appropriate **Ring Terminal** **E** or **F** and connect to power, connecting the **positive (+)** lead to the positive post and **negative (-)** lead to the negative post.

**NOTICE:** All Move accessories are compatible with 12v, 24v, and 36v systems.

### PAIRING PROCEDURE

Wave a **Magnet** **H** over the circuit board cover (see diagram). **This will open a 10 second pairing window.** During this time, the Foot Pedal will beep steadily. Finally, tap the **L** and **R** on the Move Remote at the same time, opening the pairing window on the Move. The Foot Pedal will chime, indicating it is now paired.

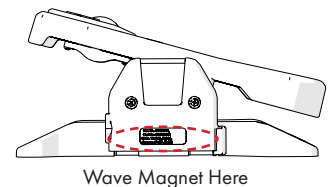

**NOTICE:** To open the pairing window, the Hybrid Remote must be within 2ft. of Base Circuit Board.

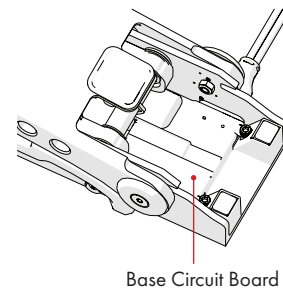

Need help? Contact our Technical Support Team at **1 + 813.689.9932 Option 2**



## REAL-FEEL™ FOOT PEDAL INSTRUCTIONS

### REAL-FEEL™ FOOT PEDAL TERMINOLOGY

The Foot Pedal is used for controlling the direction of the trolling motor, speed of the trolling motor, and for propeller operation. Use the information below to familiarize yourself with the layout, features and functions of the Foot Pedal.

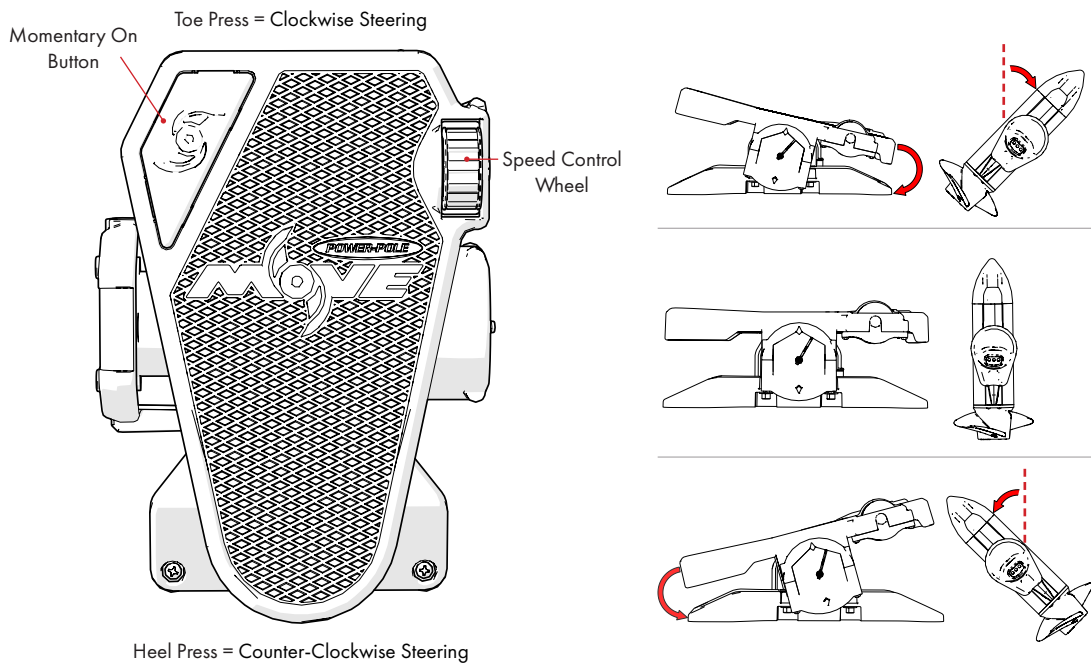

### MOMENTARY ON BUTTON

Pressing and holding the **Momentary On Button** will turn the propeller on. The propeller will continue to operate while the button is being held down. When the button is released, the propeller will stop operating.

### SPEED CONTROL WHEEL

The **Speed Control Wheel** determines the speed at which the propeller spins. Turning the **Speed Control Wheel** clockwise (forward) will increase speed. Turning the **Speed Control Wheel** counter-clockwise (backward) will decrease speed. The Foot Pedal will make a single beep each time the speed is increased or decreased. The speed will be shown on the Info Display.



# REAL-FEEL™ FOOT PEDAL INSTRUCTIONS

### General Statement (for all devices)

Warning: Changes or modifications to this device not expressly approved by JL Marine Systems, Inc. could void the user's authority to operate the equipment.

### FCC Specific Statement

NOTE: This equipment has been tested and found to comply with the limits for a Class B digital device, pursuant to Part 15 of the FCC Rules. These limits are designed to provide reasonable protection against harmful interference in a residential installation. This equipment generates, uses, and can radiate radio frequency energy and, if not installed and used in accordance with the instructions, may cause harmful interference to radio communications. However, there is no guarantee that interference will not occur in a particular installation. If this equipment does cause harmful interference to radio or television reception, which can be determined by turning the equipment off and on, the user is encouraged to try to correct the interference by one or more of the following measures:

- Reorient or relocate the receiving antenna.
- Increase the separation between the equipment and receiver
- Connect the equipment into an outlet on a circuit different from that to which the receiver is connected
- Consult the dealer or an experienced radio/TV technician for help

**FCC Part 15.19 Warning Statement** – (Required for all Part 15 devices) THIS DEVICE COMPLIES WITH PART 15 OF THE FCC RULES. OPERATION IS SUBJECT TO THE FOLLOWING TWO CONDITIONS: (1) THIS DEVICE MAY NOT CAUSE HARMFUL INTERFERENCE, AND (2) THIS DEVICE MUST NOT ACCEPT ANY INTERFERENCE RECEIVED, INCLUDING INTERFERENCE THAT MAY CAUSE UNDESIRE OPERATION.

**FCC Part 15.21 Warning Statement** – NOTE: THE GRANTEE IS NOT RESPONSIBLE FOR ANY CHANGES OR MODIFICATIONS NOT EXPRESSLY APPROVED BY THE PARTY RESPONSIBLE FOR COMPLIANCE. SUCH MODIFICATIONS COULD VOID THE USER'S AUTHORITY TO OPERATE THE EQUIPMENT.

### FCC/ISED RF Exposure

ENGLISH: This equipment complies with radiation exposure limits set forth for an uncontrolled environment. This equipment is in direct contact with the body of the user under normal operating conditions. The transmitter must not be co-located or operating in conjunction with any other antenna or transmitter.

FRENCH: Cet équipement est conforme aux limites d'exposition aux radiations dans un environnement non contrôlé. Cet équipement est en contact direct avec le corps de l'utilisateur dans des conditions de fonctionnement normales. Cet émetteur ne doit pas être co-localisées ou opérant en conjonction avec tout autre antenne ou transmetteur.

ENGLISH: This device complies with Industry Canada license-exempt RSS standard(s). Operation is subject to the following two conditions: (1) this device may not cause interference, and (2) this device must not accept any interference, including interference that may cause undesired operation of the device.

FRENCH: Le présent est conforme aux CNR d'Industrie Canada applicables aux appareils radio exempts de licence. L'exploitation est autorisée aux deux conditions suivantes: (1) l'appareil ne doit pas produire de brouillage, et (2) l'utilisateur de l'appareil doit accepter tout brouillage radioélectrique subi, même si le brouillage est susceptible d'en compromettre le fonctionnement.

MODEL NUMBER	FCC ID:	IC:
MV-AC-FOOT-PDL	Contains: SQGBL653	Contains: 3147A-BL653