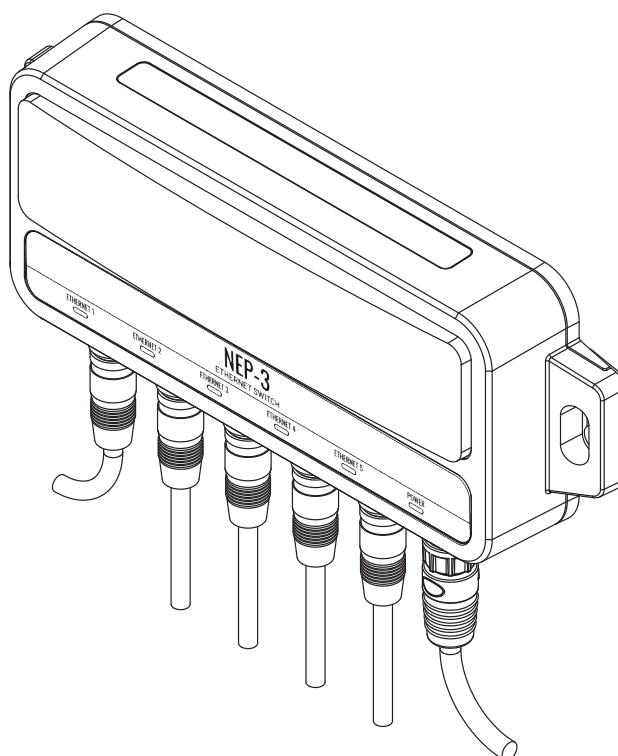

NEP-3

Ethernet switch

Installation guide

**EN**

In the box

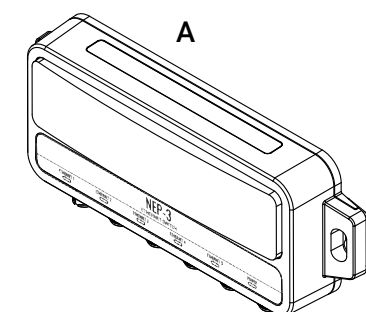
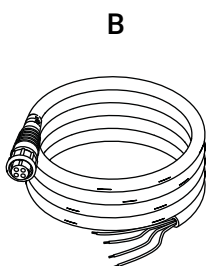
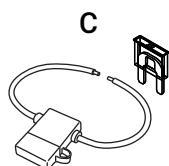
**A****B****C****D****E****F**

- A 1x NEP-3 Ethernet switch
- B 1x power cable
- C 1x 1 A fuse and fuse holder
- D 2x #8 x 3/4" SS Phillips self-tapping screws
- E 3x connector caps
- F Product documentation

Ethernet requirements

The NEP-3 supports network speeds up to 1 Gbps. This enables high-bandwidth applications and more advanced sensors and devices. The NEP-3 is compatible with yellow 5-pin Ethernet devices via an optional adapter, but the NEP-3 will transmit data at a lower rate.

→ **Note:** Only one X-coded M12 GbE to yellow Ethernet adapter can be used between devices.

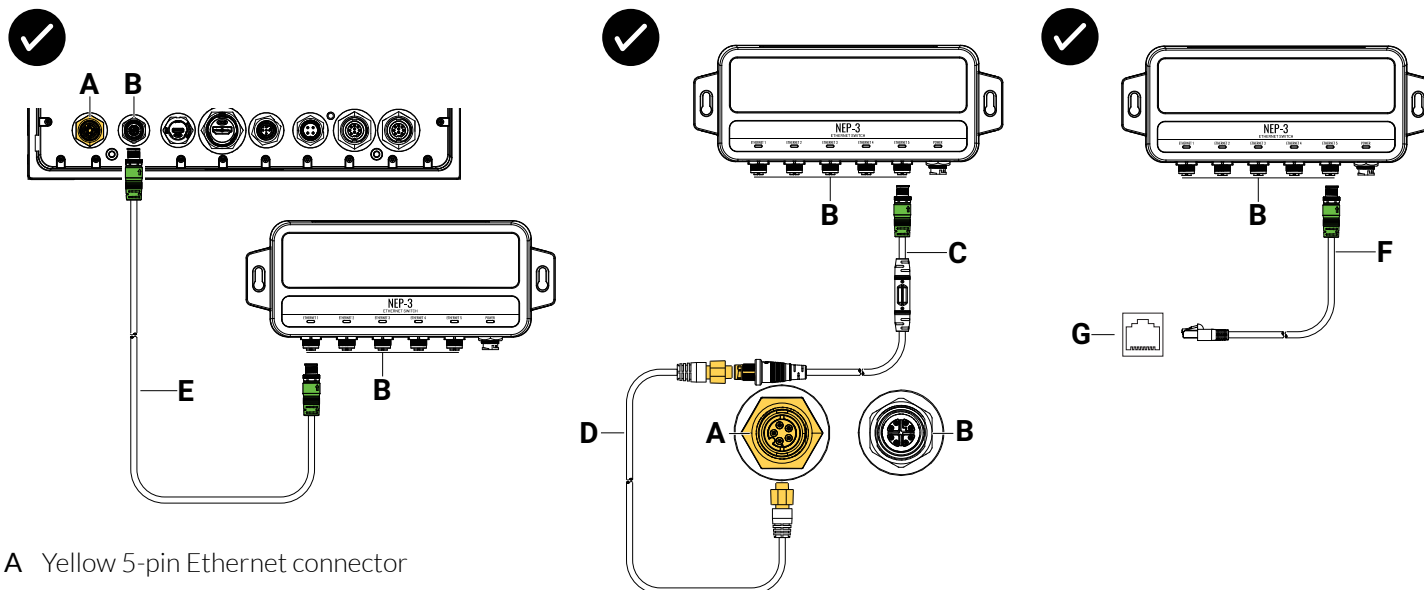

- A Yellow 5-pin Ethernet connector
- B X-Coded M12 GbE connector
- C M12 GbE to yellow 5-pin Ethernet adapter
- D Yellow 5-pin Ethernet cable
- E M12 GbE cable
- F M12 GbE to RJ45 Ethernet cable
- G RJ45 Ethernet connector

Do not use more than one X-Coded M12 GbE to yellow 5-pin Ethernet adapter when connecting devices.

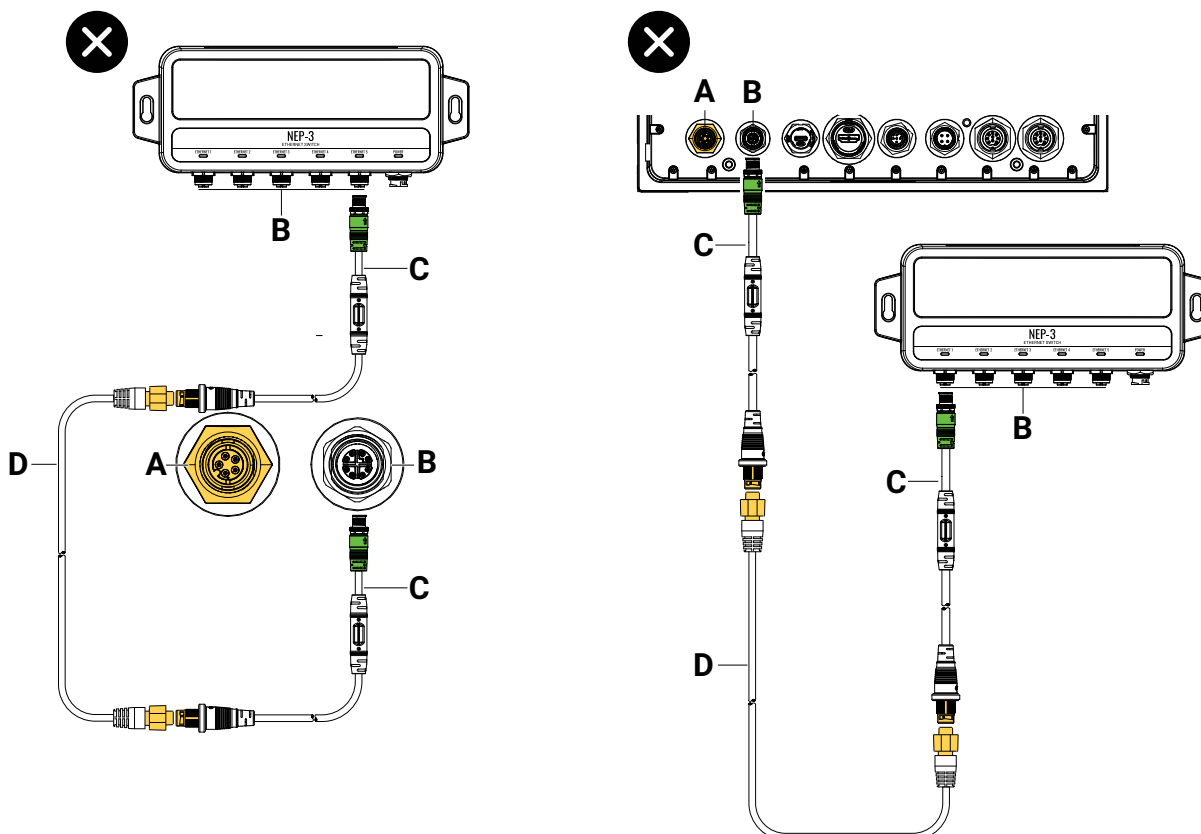

Ethernet connector (X-Coded M12, GbE) details

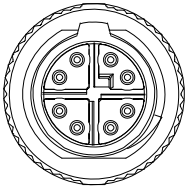

Only use Navico Group cables or other high-quality Cat6 SF/FTP Ethernet cables.
Navico Group X-coded M12 GbE cables have keyed connectors to prevent accidental damage to the connector pins. The NEP-3 is compatible with all standard X-coded M12 GbE connectors.
Connector caps should be fitted when the connectors are not in use.

Power

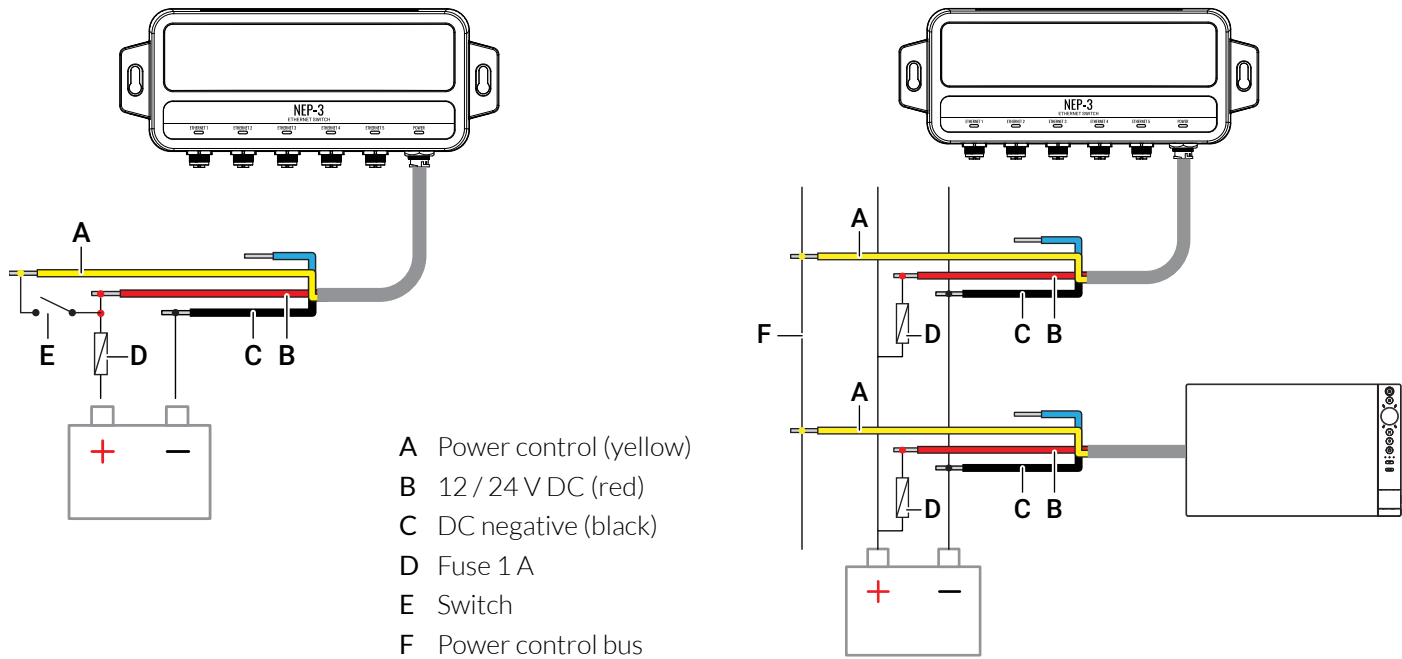

LEDs

Connector	LED	Status
A Ethernet	Off	No connection
	Green	Active connection
	Flashing amber	Activity
B Power	Off	No power
	Amber	Power applied, system off
	Red	System fault or overvoltage
	Green	System operating

Mounting

Recommended pilot holes	
Material	#8 self-tapping screws included
Soft materials e.g. Plywood	Ø 2.7-3.1 mm (7/64")
Hard materials e.g. Fiberglass, acrylic, hardwoods	Ø 3.2-3.5 mm (1/8")

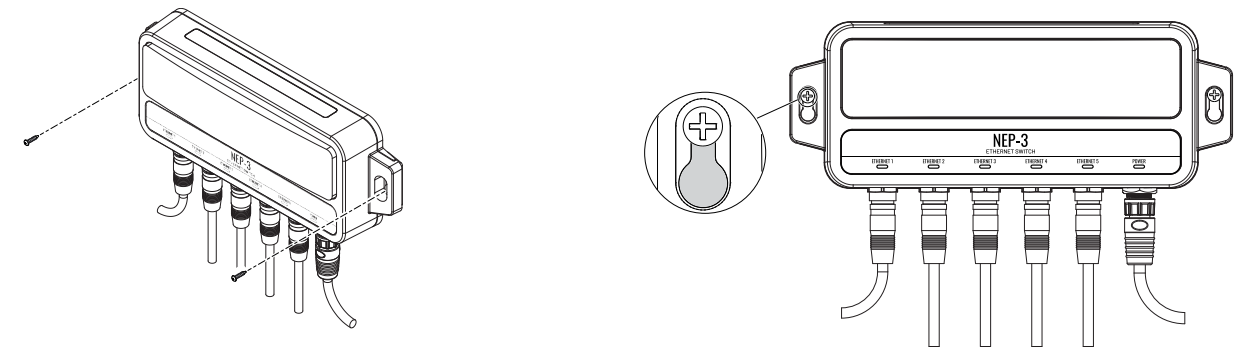

Technical specifications

Environmental	
Operating temperature range	-15° C to 55° C (5° F to 131° F)
Storage temperature range	-20° C to 60° C (4° F to 140° F)
Waterproof rating	IPX6 and IPX7
Electrical	
Supply voltage	12 - 24 V DC (10.4 - 31.2 V DC)
Recommended fuse rating	1 A
Power consumption (maximum)	2.5 W (0.18 A at 13.8 V DC)
Physical	
Weight	0.48 kg (1.07 lbs)
Compass Safe Distance	0.5 m (1.6 ft)
Interface/Connectivity	
Ethernet	5 connectors (X-coded M12, GbE)

Dimensions

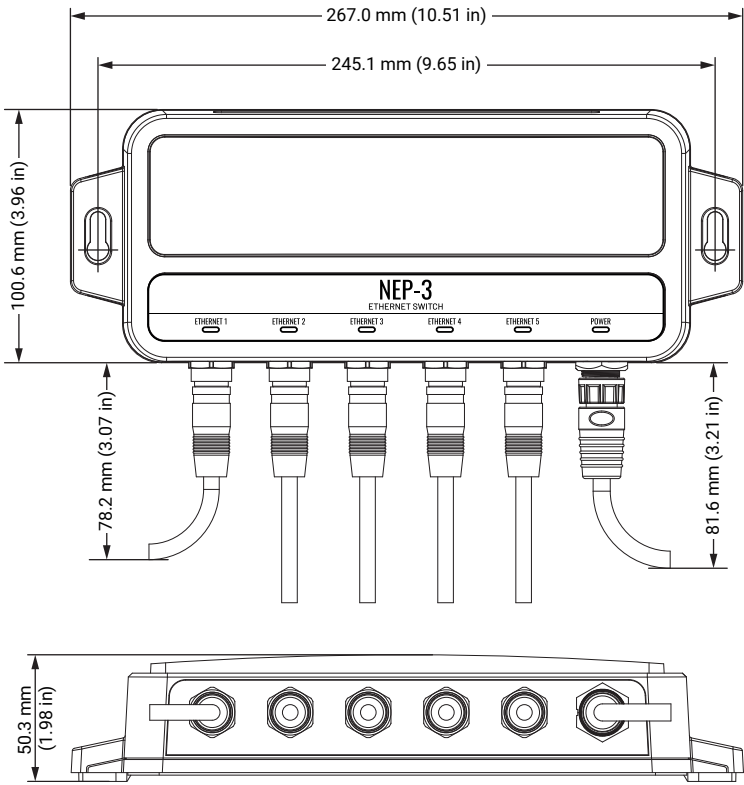

Accessories

Item number	Description
000-16448-001	Ethernet adapter — green, X-coded M12, 8-pin male - yellow 5 pin female, 0.37 m (1.2 ft)
000-16075-001	Ethernet cable — green, X-coded M12, 8-pin male - male, 1.8 m (6 ft)
000-16076-001	Ethernet cable — green, X-coded M12, 8-pin male - male, 5 m (16.5 ft)
000-16077-001	Ethernet cable — green, X-coded M12, 8-pin male - male, 15 m (49.2 ft)
000-16078-001	Ethernet cable — green, X-coded M12, 8-pin male - RJ45 male, 1.8 m (6 ft)
000-16079-001	Ethernet cable — green, X-coded M12, 8-pin male - RJ45 male, 5 m (16.5 ft)
000-16080-001	Ethernet cable — green, X-coded M12, 8-pin male - RJ45 male, 15 m (49.2 ft)

For a complete list of compatible accessories, visit:

- www.bandg.com
- www.lowrance.com
- www.simrad-yachting.com

More information

For the latest version of this document in supported languages and other related documentation, visit:

- www.bandg.com/downloads
- www.lowrance.com/downloads
- www.simrad-yachting.com/downloads

Safety, disclaimer, and compliance

This product's safety, disclaimer, and compliance statements are supplied as a separate document.

Warranty

This product's warranty is supplied as a separate document.

Copyright

© 2024 Navico Group. All Rights Reserved. Navico Group is a division of Brunswick Corporation.

Trademarks

®Reg. U.S. Pat. & Tm. Off, and ™ common law marks. Visit www.navico.com/intellectual-property to review the global trademark rights and accreditations for Navico Group and other entities.