

ITEM NO.	PART NUMBER	DESCRIPTION	QTY.
1	SVSLWBP	SEAVIEW ANGLED WEDGE BASE	1
2	SVSLFOAM	12" FOAM STRIP	2
3	CG30PW	CABLE SEAL	1
4	516SSW	5/16" STAINLESS STEEL WASHER	4
5	516NW	5/16" NYLON WASHER	4
6	ADASPG3AP	STARBOARD ADAPTER PLATE	1
7	1420SQUARENUT	1/4-20 SQUARE NUT	4
8	M6SB	M6 SHOULDER BUSHING	4
9	M6SSW	M6 STAINLESS STEEL WASHER	4
10	M6LW	M6 LOCK WASHER	8
11	M6BHCS	M6x 1.0x 45 BHCS	4
12	14SSW	1/4" STAINLESS STEEL WASHER	4
13	1420HEXBOLT	1/4-20 x 1.25 HEX BOLT	4

NOTES:
1. ITEM (7) WILL COME ALREADY PRESSED INTO ADASPG3AP (ITEM (6)).
2. BEFORE BEGINNING THIS INSTALLATION, BE SURE THAT YOUR CABLES ARE ROUTED PROPERLY.

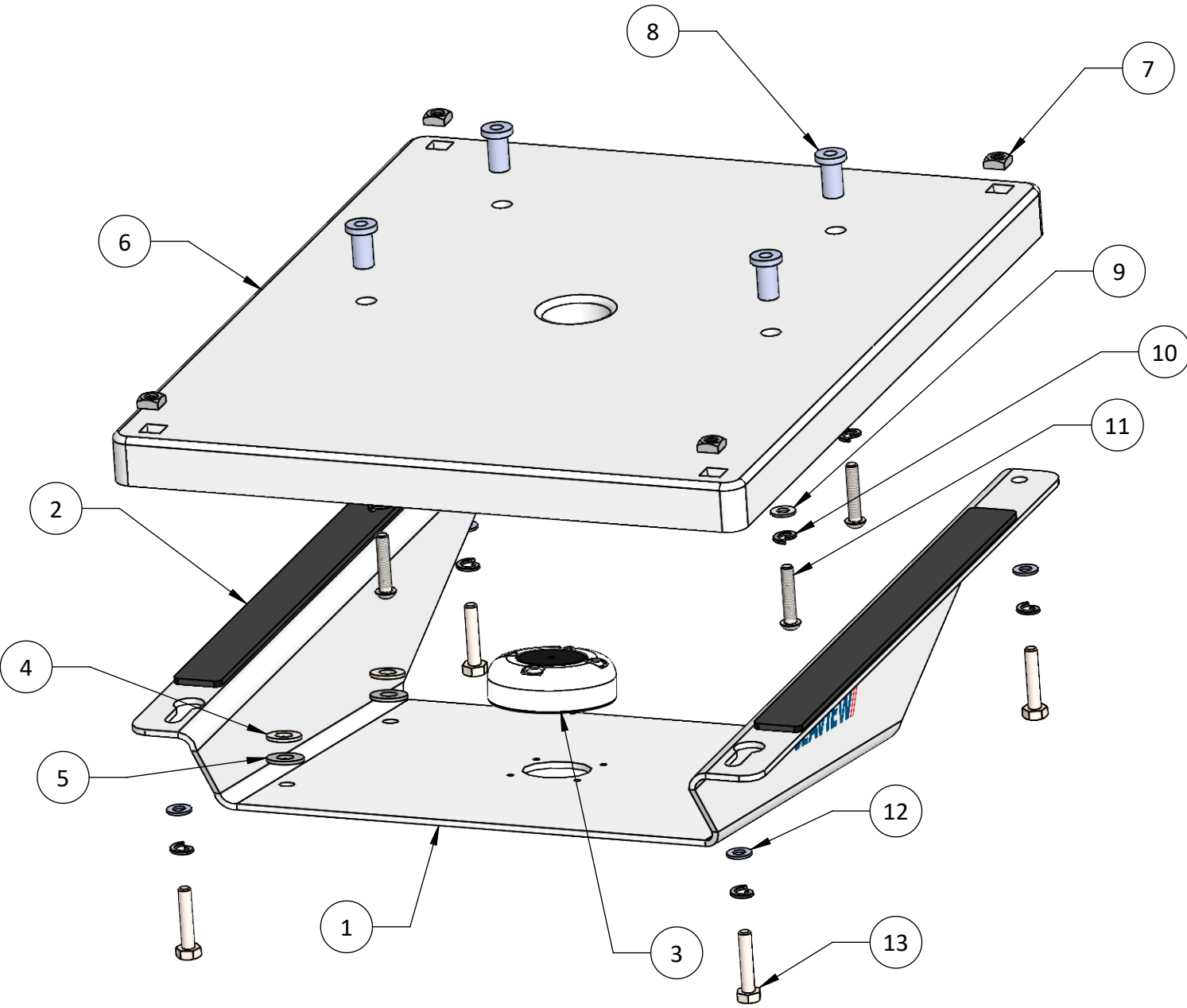

SRM300WB8

- Please note that some dimensions may not be shown (applies to all pages)
- Do not scale drawing (applies to all pages)
- For help e-mail info@seaviewglobal.com; ph. 1-800-655-7922

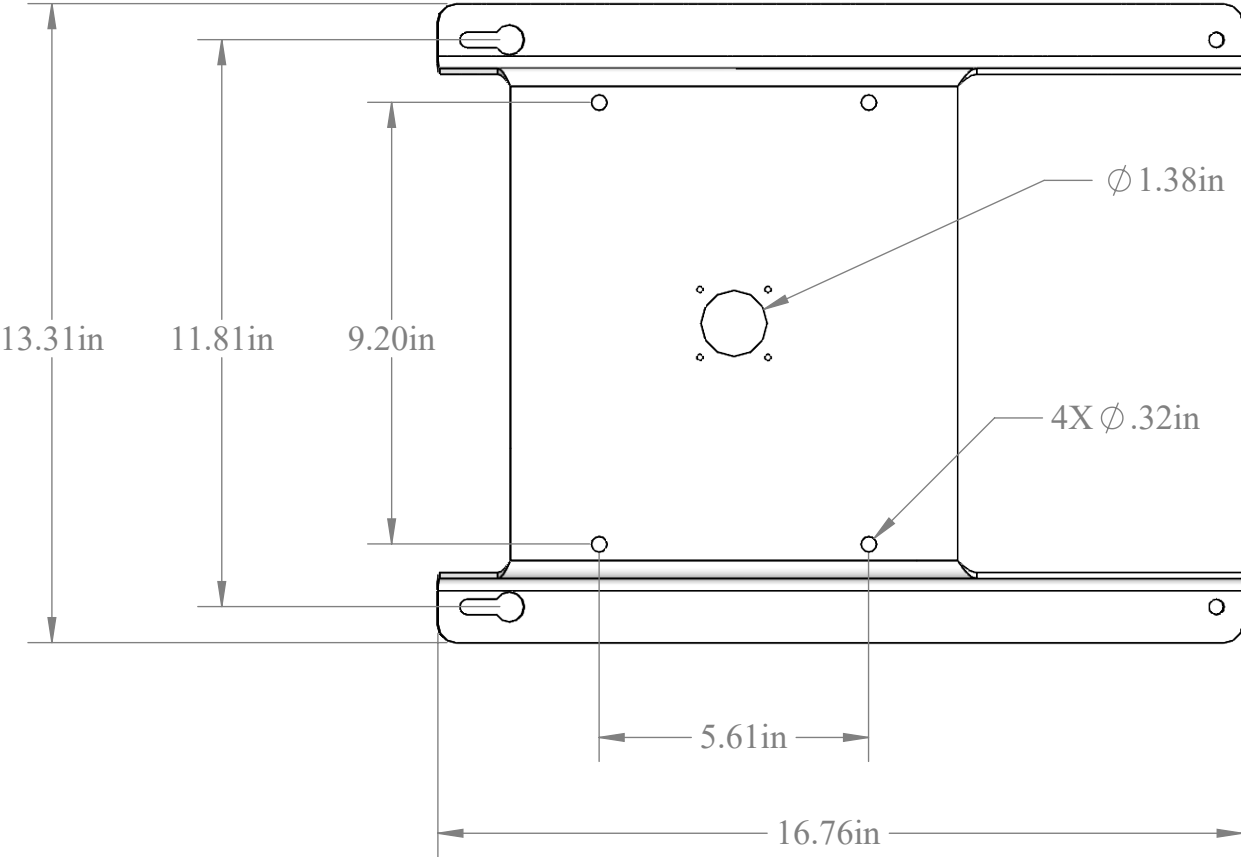
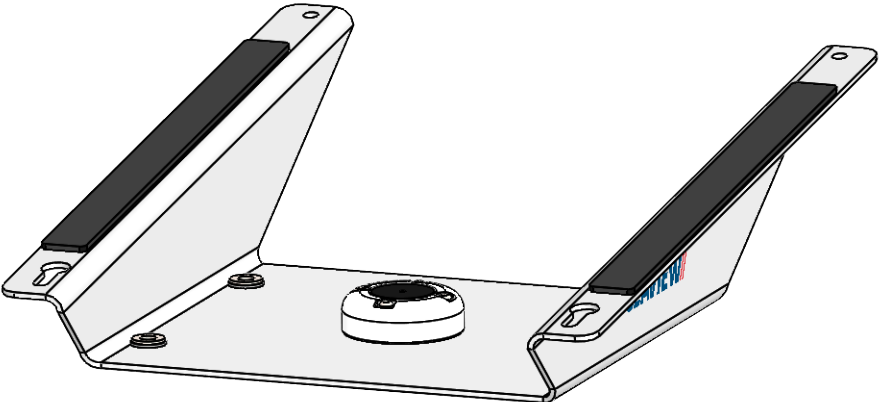
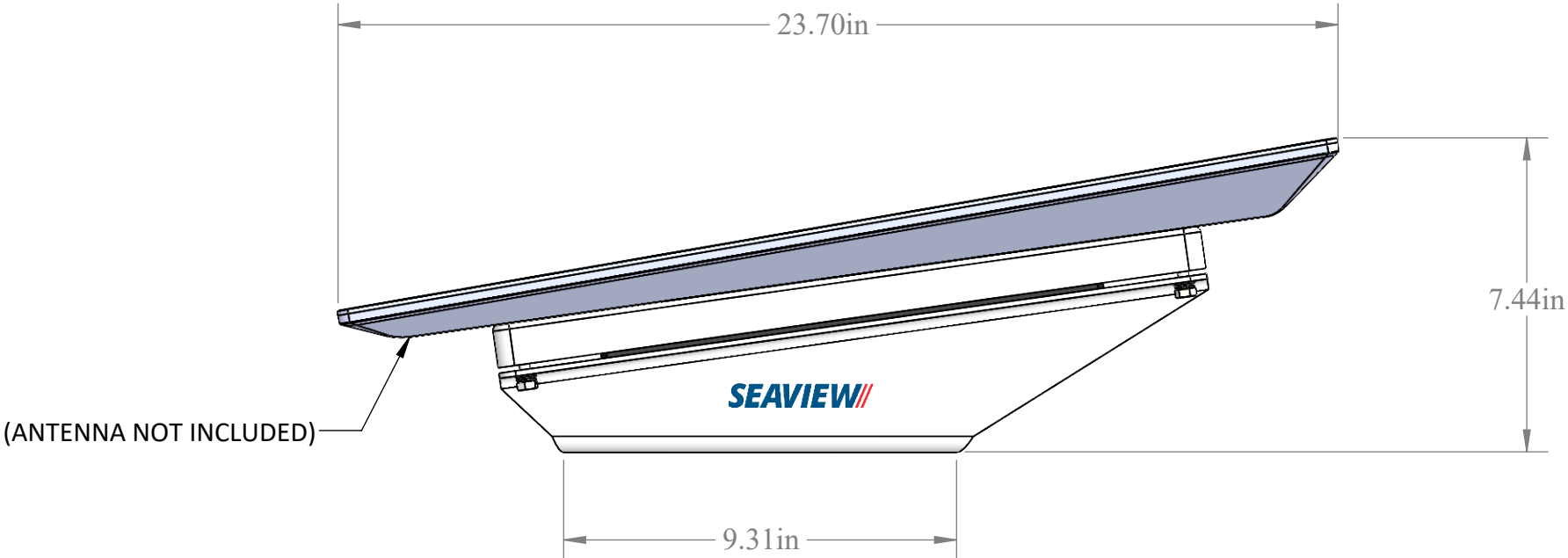

SRM300WB8

For help e-mail
info@seaviewglobal.com
ph. 1-800-655-7922

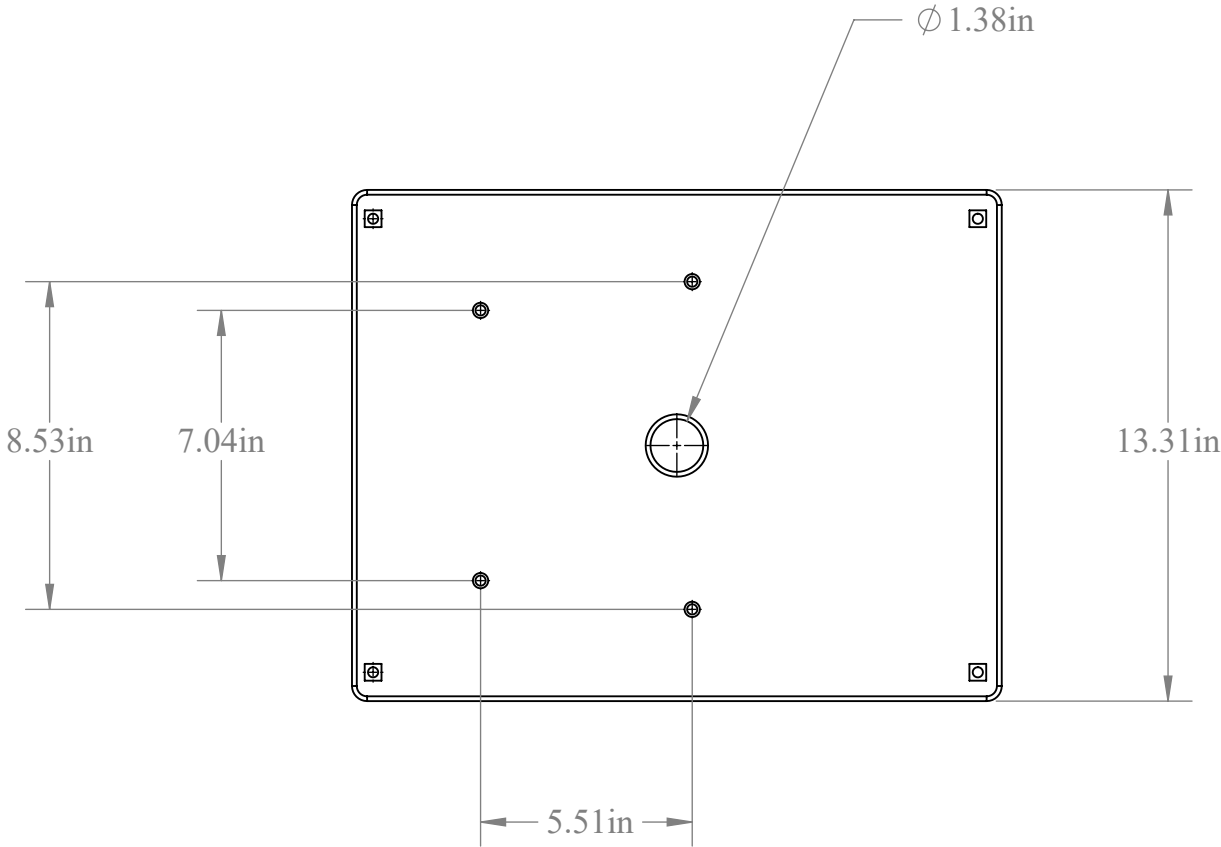

CORNER THRU HOLES ARE FOR MOUNTING TO SVSLWB (ITEM 1).

COUNTERBORES FOR SHOULDER BUSHINGS (THESE HOLES ARE FOR ATTACHING TO STARLINK PERFORMANCE GEN 3 ANTENNA)

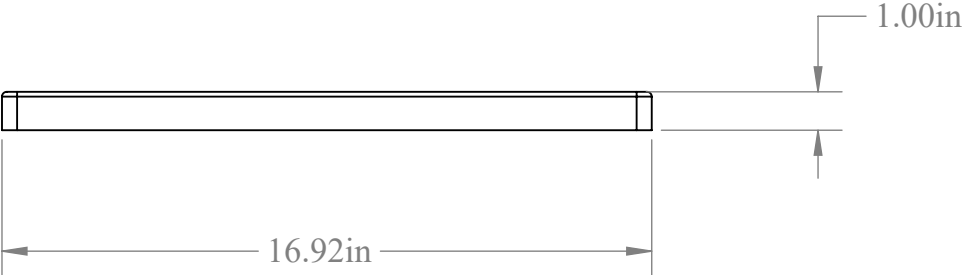
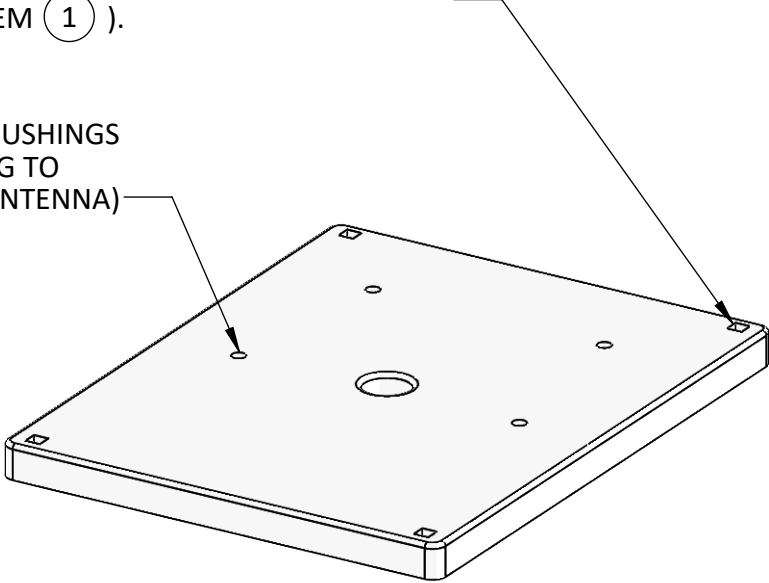

SRM300WB8

For help e-mail
info@seaviewglobal.com
ph. 1-800-655-7922

INSTALLATION INSTRUCTIONS BEGIN ON NEXT PAGE

NOTE: It is strongly advised that all installations are carried out by an authorized installer who possesses the necessary expertise and experience in marine equipment installation. Furthermore, prior to the final installation process, we recommend performing a dry fit assembly of all components. This entails fitting the components in their designated positions on the boat without permanently affixing them. This step allows for careful assessment of compatibility, alignment, and any potential adjustments that may be required before proceeding with the actual installation.

For help e-mail
info@seaviewglobal.com
ph. 1-800-655-7922

- 1** Using the wedge base as a guide, mark and drill the 4 holes in the desired mounting location. Please note where the cable is routed when deciding. It is recommended that the low end of the wedge faces forward.

SEAVIEW

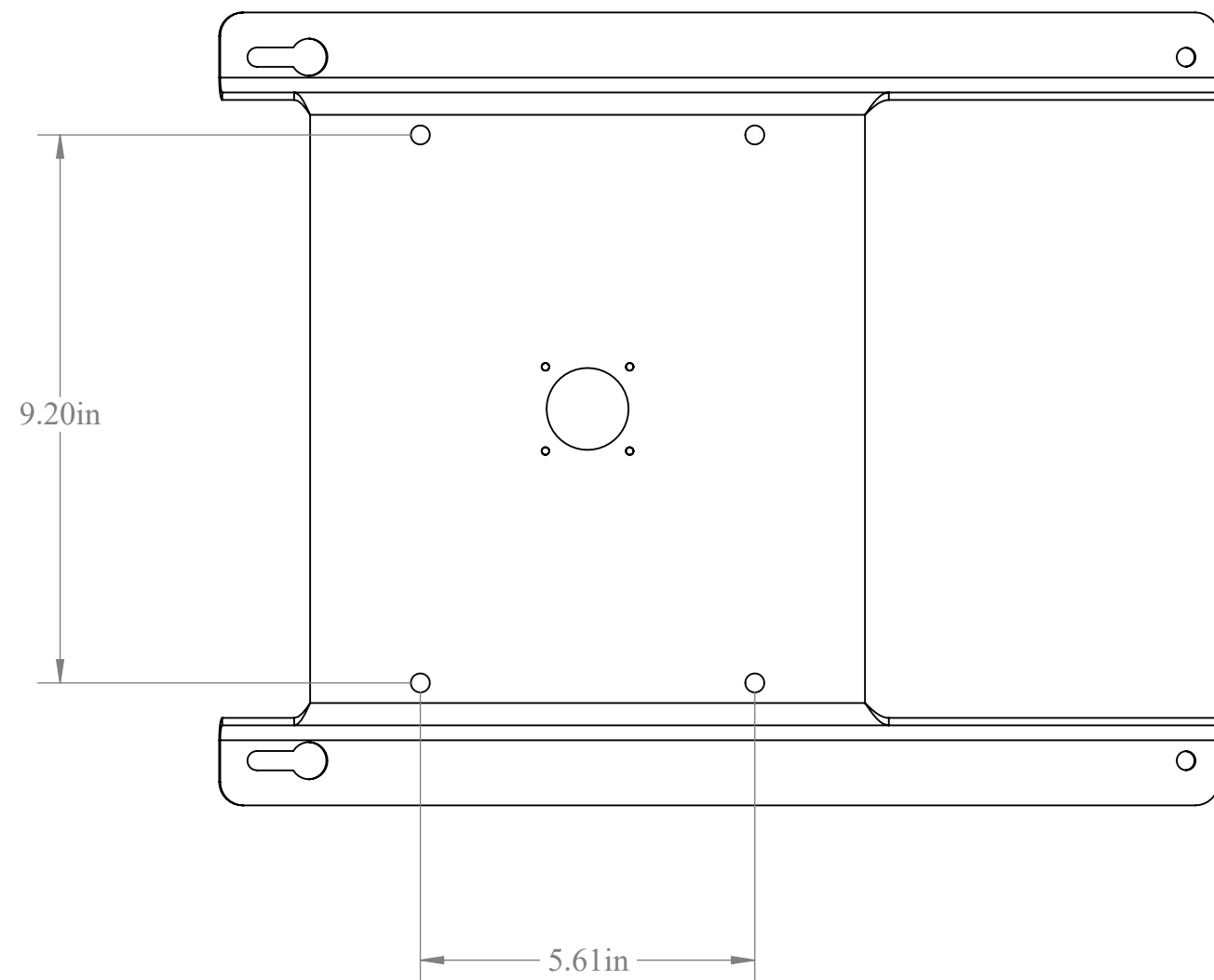

SRM300WB8

For help e-mail
info@seaviewglobal.com
ph. 1-800-655-7922

2 Using items (4) and (5), bolt the wedge base (item 1) down using nyloc nuts (or similar). Due to varying mounting surface types and thicknesses, ensure the correct mounting bolts and hardware are used (bolts/nuts for this step are not included in this kit).

SEAVIEW

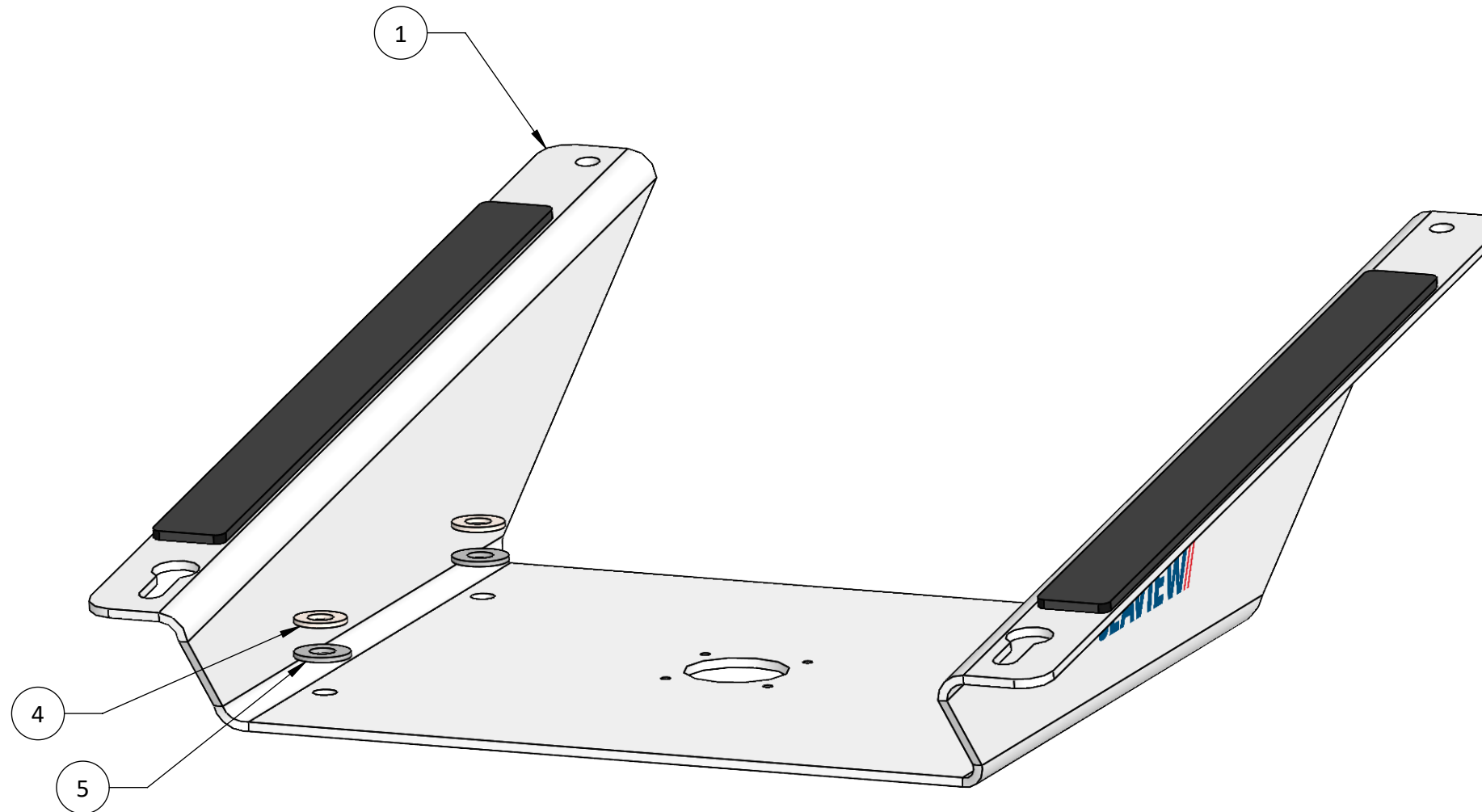

SRM300WB8

For help e-mail
info@seaviewglobal.com
ph. 1-800-655-7922

3 Route antenna cable through provided cable seal (item 3). Please note that the holes in the wedge base are tapped to receive the cable seal. All cable seal hardware is included. For more specific cable seal instructions refer to the following link: [click here](#)

SEAVIEW

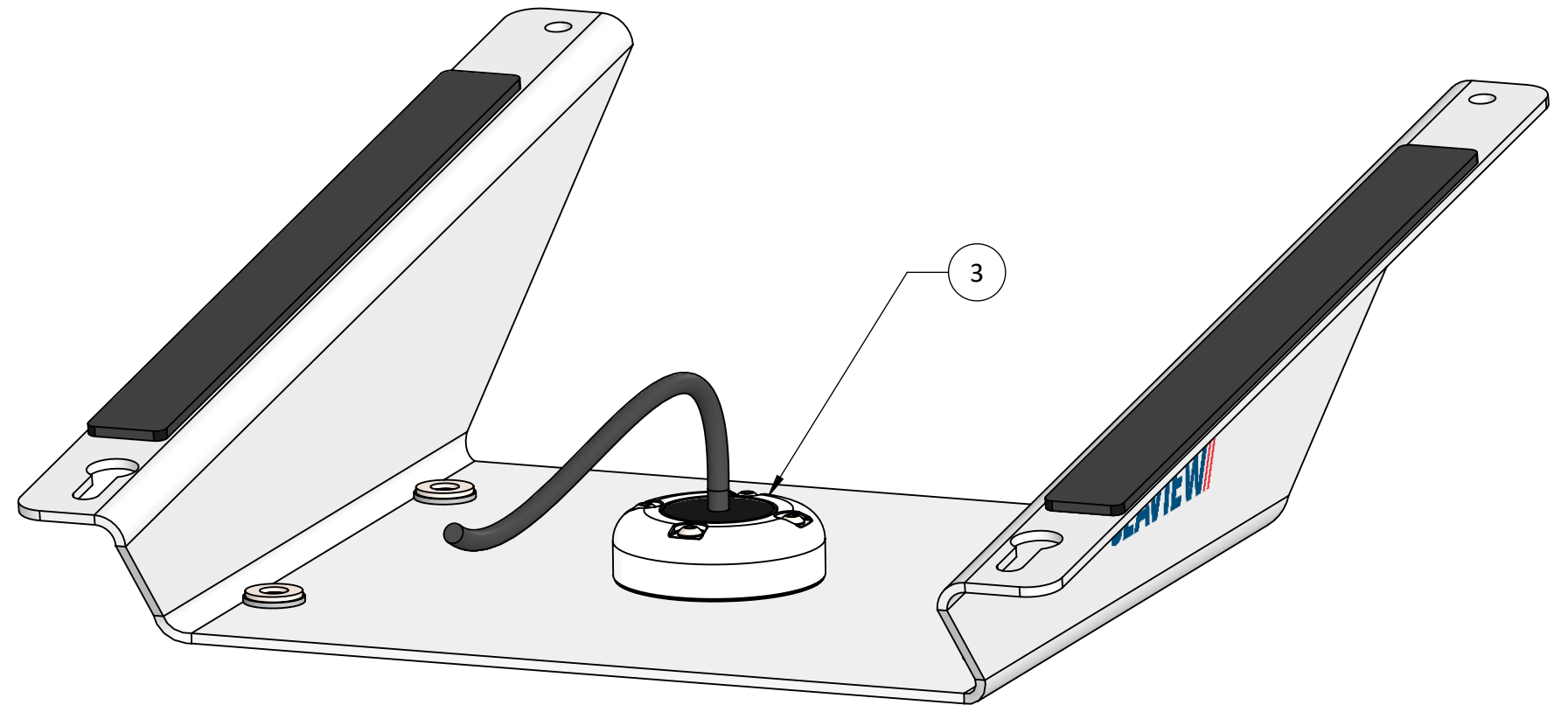
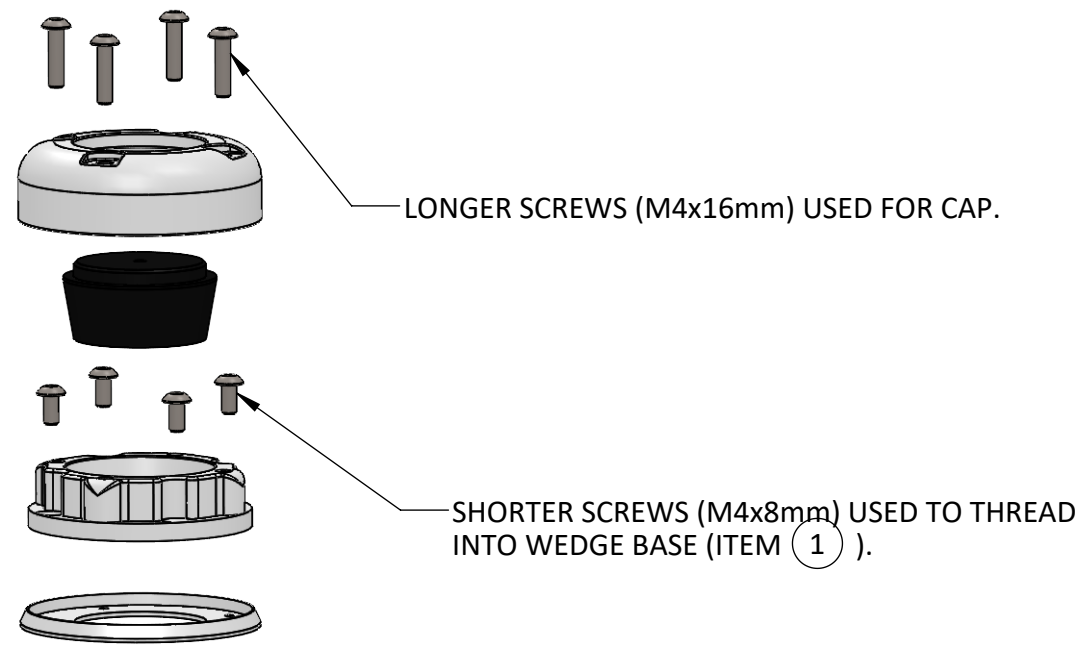

SRM300WB8

For help e-mail
info@seaviewglobal.com
ph. 1-800-655-7922

4 Press item **8** into each of the four counterbores ensuring that they are fully seated and flush with the surface of item **6**.

SEAVIEW

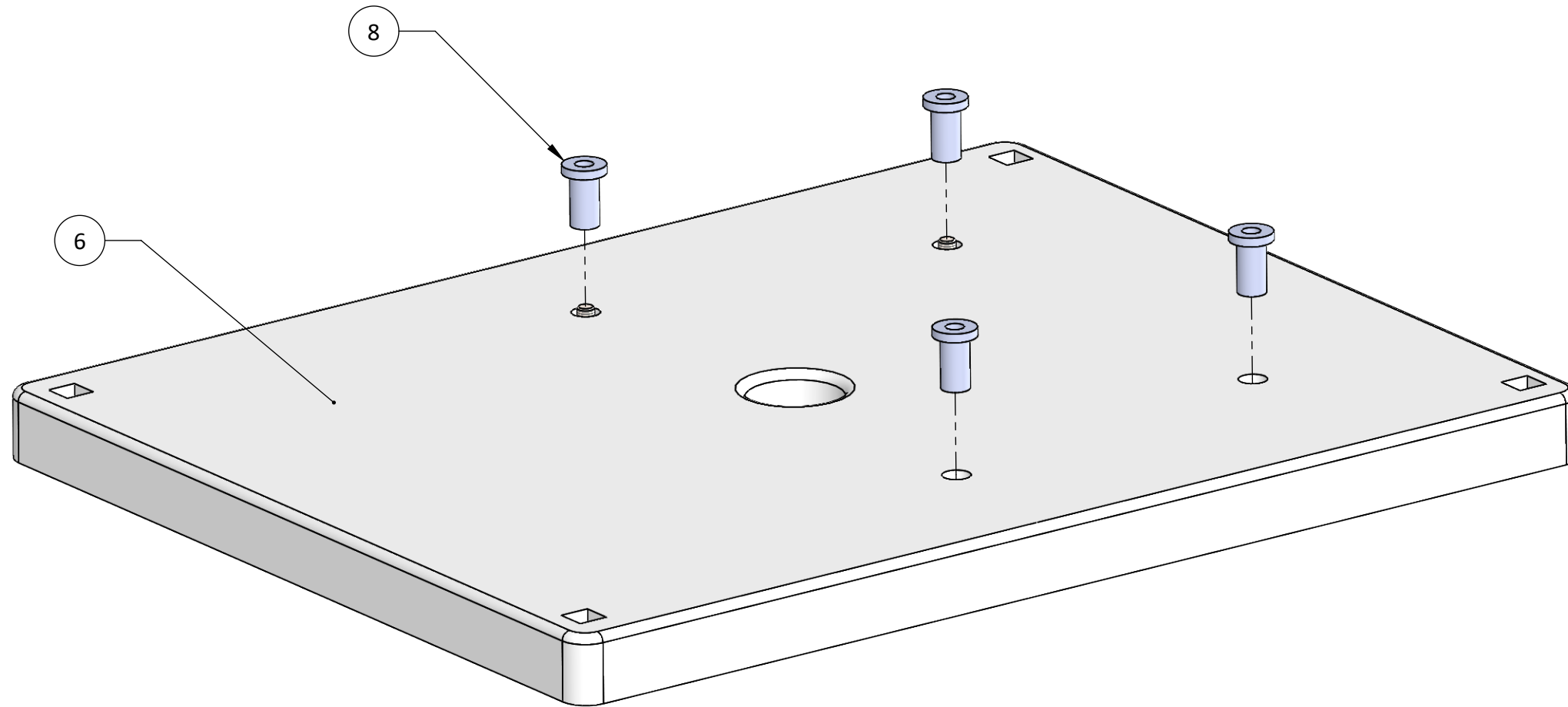

SRM300WB8

For help e-mail
info@seaviewglobal.com
ph. 1-800-655-7922

5 Route Starlink cable through the large center hole on item (6) and connect it to your Starlink antenna. Then place ADASPG3AP on the underside of antenna in alignment with the four mounting holes before using items (9) - (11) to fasten the plate to the antenna.

SEAVIEW

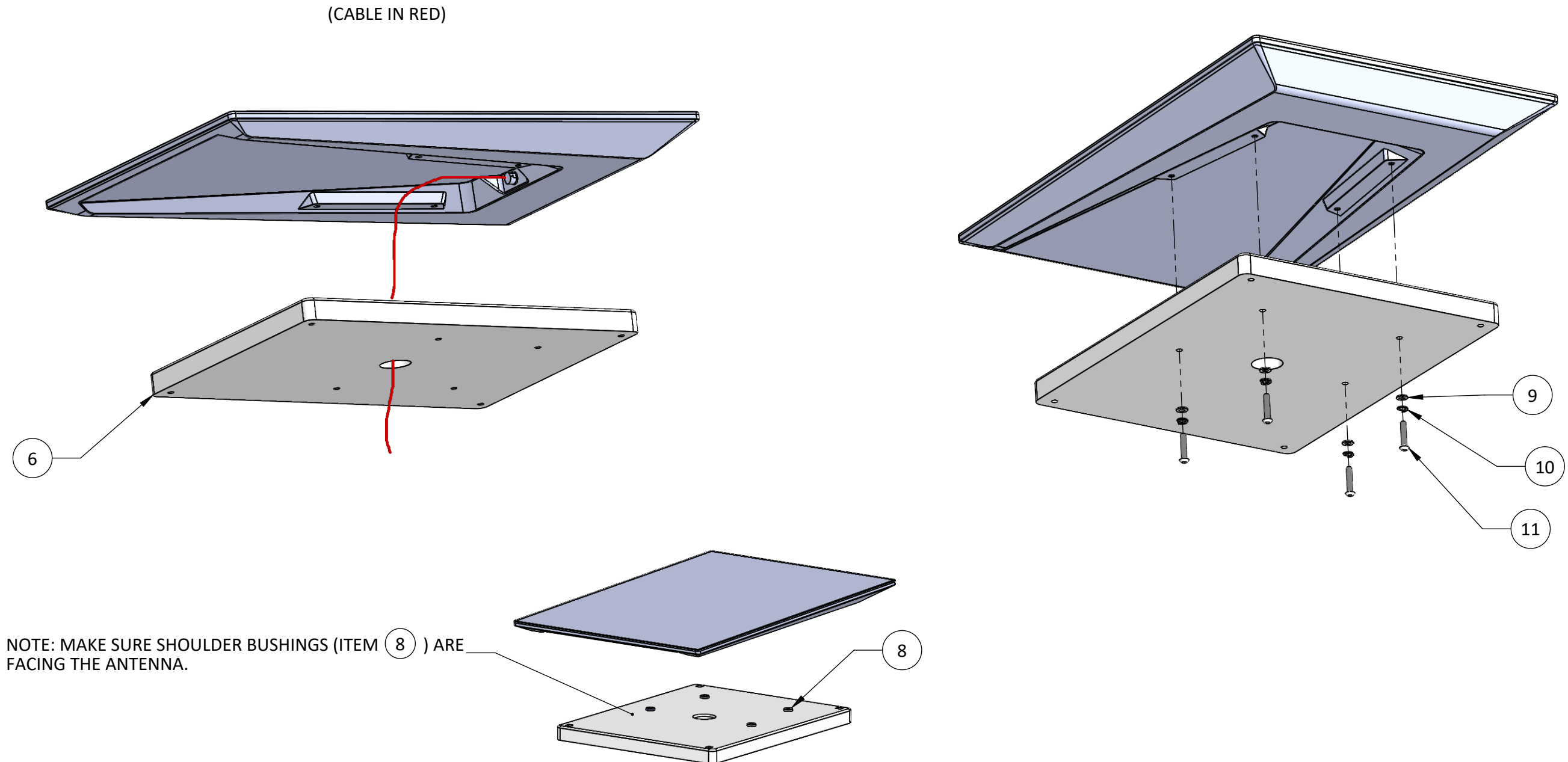

SRM300WB8

For help e-mail
info@seaviewglobal.com
ph. 1-800-655-7922

6 You are now ready to attach your ADASPG3AP (item 6) to the angled wedge base (item 1). Position the adapter plate onto the angled wedge base and use items 12, 10, and 13 to firmly secure it at all four mounting points as shown.



NOTE: THE SCREWS GOING INTO THE ANTENNA SHOULD BE ORIENTED **TOWARDS** THE HIGH END OF THE WEDGE (ITEM 1).

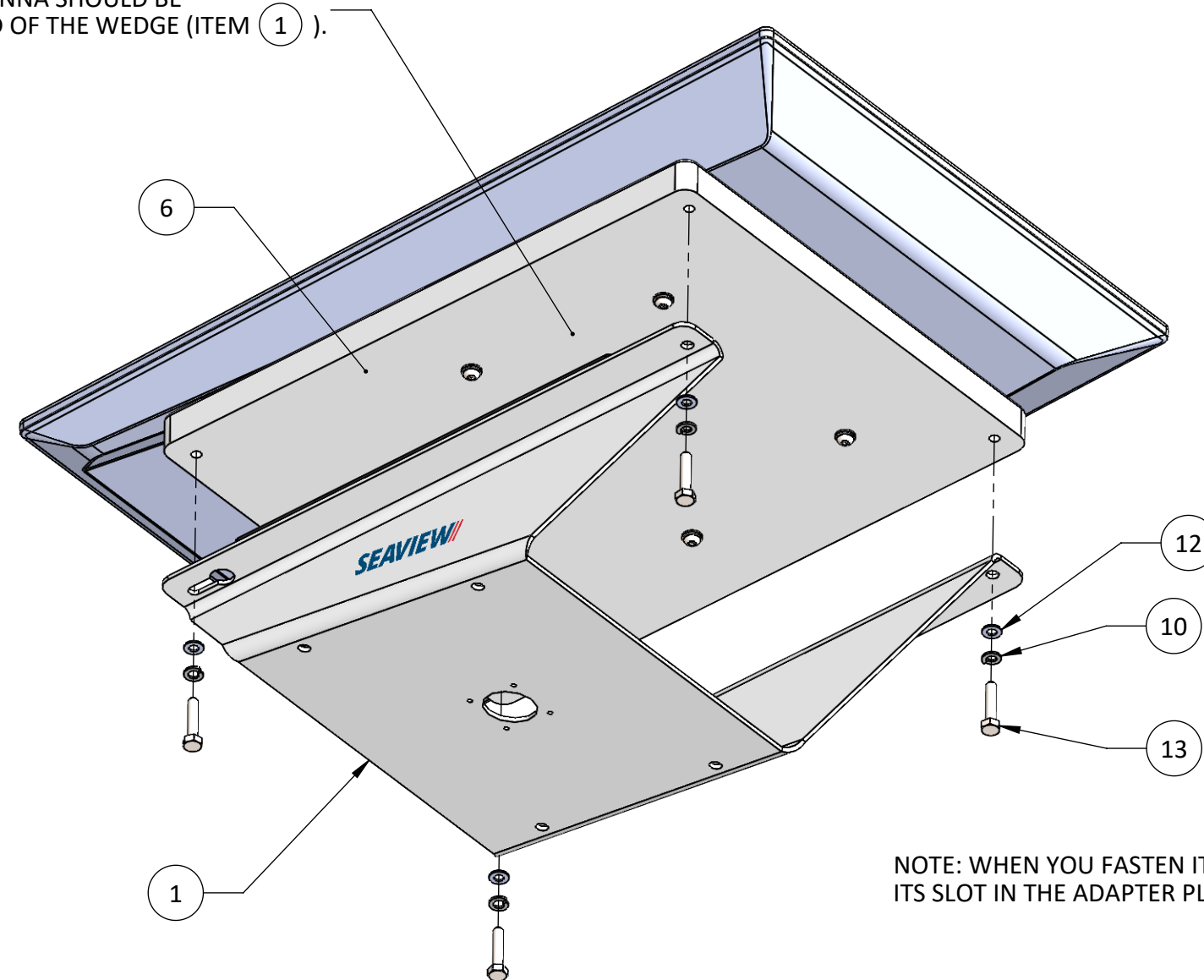

NOTE: WHEN YOU FASTEN ITEM 13 THE SQUARE NUT WILL BE PULLED FURTHER INTO ITS SLOT IN THE ADAPTER PLATE. BE SURE TO TIGHTEN ALL THE WAY DOWN.

SRM300WB8

For help e-mail
info@seaviewglobal.com
ph. 1-800-655-7922