

Specifications

Placement

Attaches between seat frame and floor board,
uses front and rear, inside seat studs

Seat Configuration

Bucket seats

Drilling Required

No drilling - uses existing seat bolts

Construction/Finish

Steel/Black powder coat

Dimensions

(A) 13.75" (B) 7.625" (C) 17.625"
(Hole Centers) 11.687"

Pole or Pedestal

Included on base

Weight

6.1 lbs.

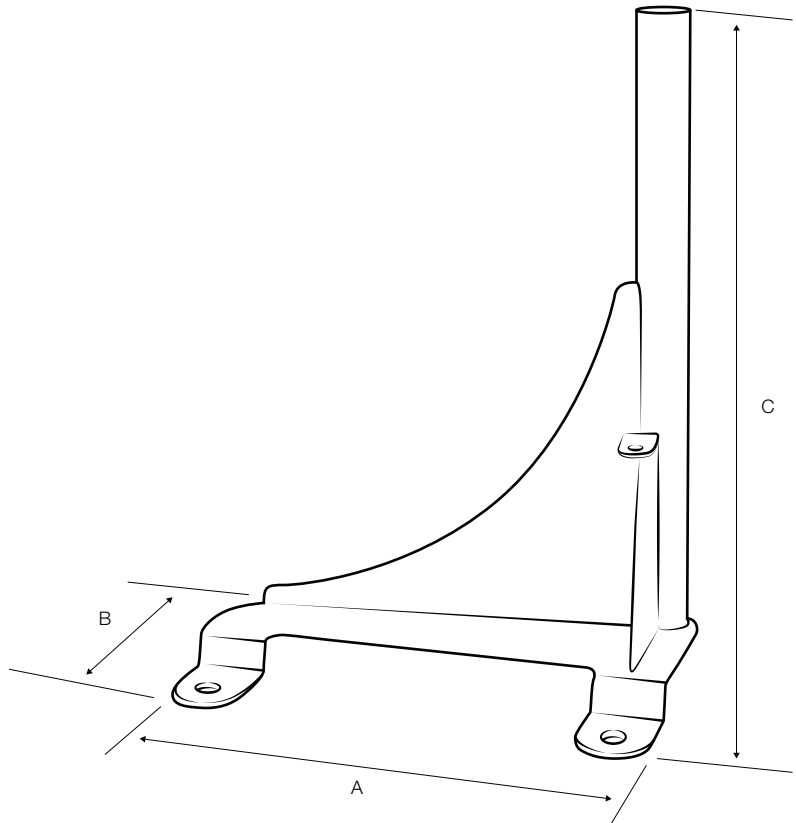

Features

Installs in minutes with no drilling required

Stabilizer bracket included

Rock solid construction

Lifetime warranty

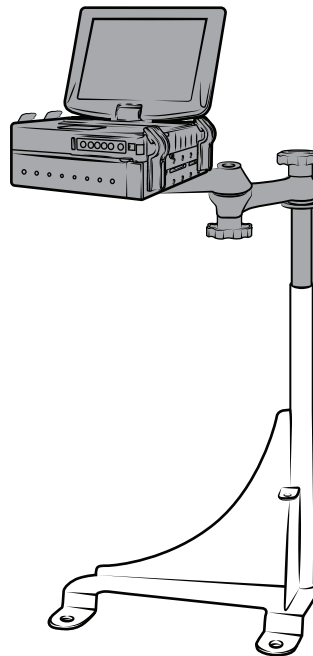

RMR-INS-VB-143



Safety Precaution

Do not install this product near or over an airbag deployment area or in a location that obstructs the driver's vision or interferes with vehicle operation. National Products, Inc does not assume responsibility or liability for any such personal injury, death or property damage.

Installation Instructions

- 1 Attach the stabilizing brace, RAM-VB-143SL to the RAM® No-Drill™ base first. Note that there is a small hole and a large hole on the brace. The small hole side goes to the RAM® No-Drill™ base, the large attaches to the seat of the vehicle. Attach the brace so that once installed, the brace angles toward the front of the vehicle. Also, the brace should be on the forward side of the RAM® No-Drill™ base, not the back. This is important for proper alignment. Place the bolt through the hole and thread on the nut only finger tight. Flip the brace into a vertical position and set aside this assembly.
- 2 Using the 18mm deep socket, loosen and remove the nuts holding the seat frame to the floor board. Once removed, gently lift the entire seat assembly up and off the studs. Place the RAM® No-Drill™ base so that it is positioned over the seat studs coming out of the floor board. The base installs to the inside front and inside rear seat studs. Once you have the base in position, make sure the stabilizing brace is in an upright or vertical position.
- 3 Lift the passenger side seat up and align the seat frame holes with the studs. Lower the seat back into place securing the RAM® No-Drill™ base in between the seat frame and floor board. Next, using the 18MM deep socket, fully tighten the nuts previously removed to 39 ft lbs.
- 4 Using the 15mm deep socket, loosen and remove the nuts holding the front seat tracks to the seat frame. At the back of the seat, you only need to loosen these nuts enough to allow you to lift the front of the seat track and clear the seat studs.
- 5 Tilt the passenger side seat back causing the seat studs to clear the seat frame holes. Now take the stabilizing leg out of the vertical and lower it down over the top of the now exposed hole in the seat frame. Keep the seat up for Step 6.
- 6 Lower the seat back down passing the seat studs through the brace and spacer and through the seat frame holes. Once the seat is back down, and prior to re-installing the seat track nuts, use the ½ inch box wrenches to tighten the stabilizer leg where it connects to the RAM® No-Drill™ base. It is easier to do this now before the seat is fully tightened back into place. Once the brace to base connection is tight, reinstall and fully tighten the nuts holding the seat to the seat frame using the 15mm deep socket. Torque to 30 ft lbs.
- 7 Using the 15MM deep socket, re-install and fully tighten the four seat track nuts to complete the installation.

RMR-INS-VB-143



Safety Precaution

Do not install this product near or over an airbag deployment area or in a location that obstructs the driver's vision or interferes with vehicle operation. National Products, Inc does not assume responsibility or liability for any such personal injury, death or property damage.

Parts Index

* Not to scale

Patented & Pats. Pend.
rammount.com/ip

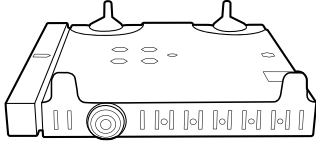

A

Tray Assembly

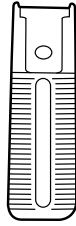

B

(x4) Long Arms



C

(x4) Short Arms



D

(x4) Angled Brackets



E

(x2) Foam Pads

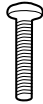

F

(x4) Screws
#8-32 x 3/4"



G

(x4) Nylock Nuts
#8-32

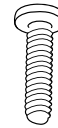

H

(x4) Screws
#10-24 x 3/4"



I

(x4) Nylock Nuts
#10-24

1 Place laptop on tray with lid open. Using a screwdriver, loosen and rotate the rear posts to seat properly against the back of your laptop.

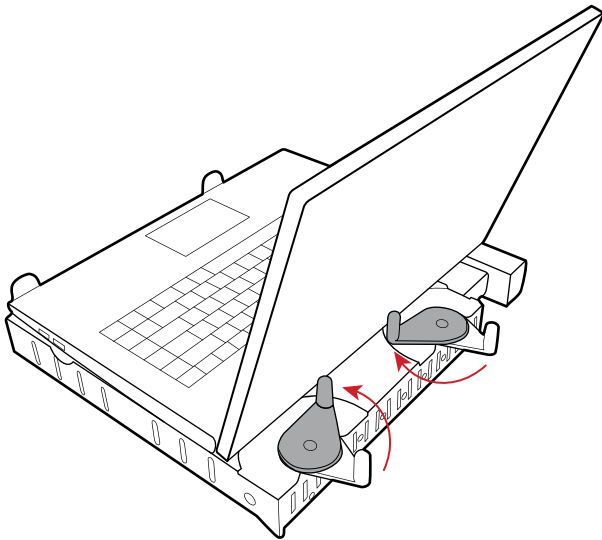

2 Select **(B)** or **(C) Arms** depending on what is most appropriate for the thickness of your laptop. Slide **(D) Angled brackets** into selected arms until you hear a satisfying "click".

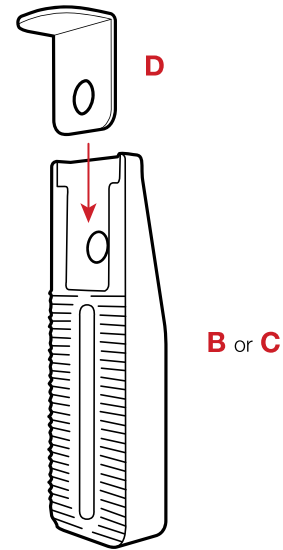

RMR-INS-2347



Safety Precaution

Do not install this product near or over an airbag deployment area or in a location that obstructs the driver's vision or interferes with vehicle operation. Electronic devices attached to this product are not to be used while vehicle is in motion. National Products, Inc. does not assume responsibility or liability for any such personal injury, death, or property damage.

- 3 Connect selected arms from Step 2 to the sides of the **(A) Tray** using **(F) Screws** and **(G) Nuts**. Select holes on the sides of the tray that will not block any necessary port or drive access.

Position the arms so that the **(D) Angled Brackets** rest flush against laptop keyboard.

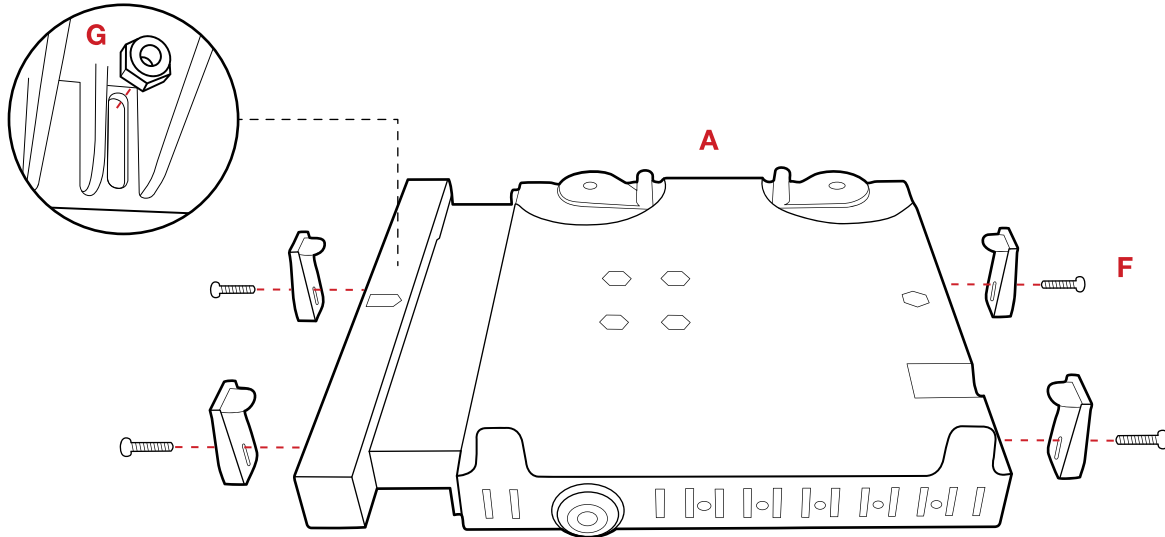

- 4 Connect **(A) Tray** to ball (not included) using **(H) Screws** and **(I) Nuts**.

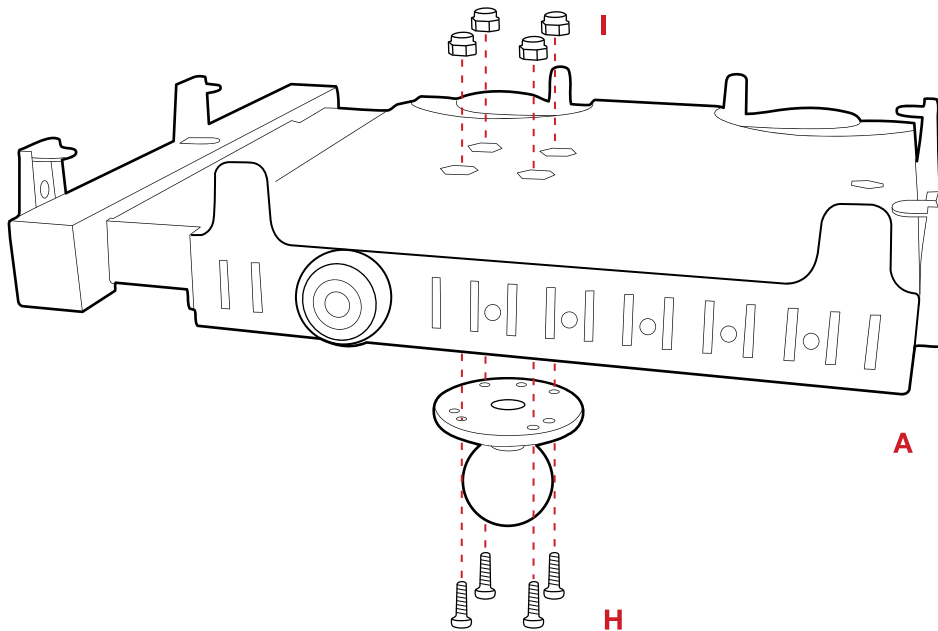

RMR-INS-2347



Safety Precaution

Do not install this product near or over an airbag deployment area or in a location that obstructs the driver's vision or interferes with vehicle operation. Electronic devices attached to this product are not to be used while vehicle is in motion. National Products, Inc. does not assume responsibility or liability for any such personal injury, death, or property damage.

Parts Index

Not to scale

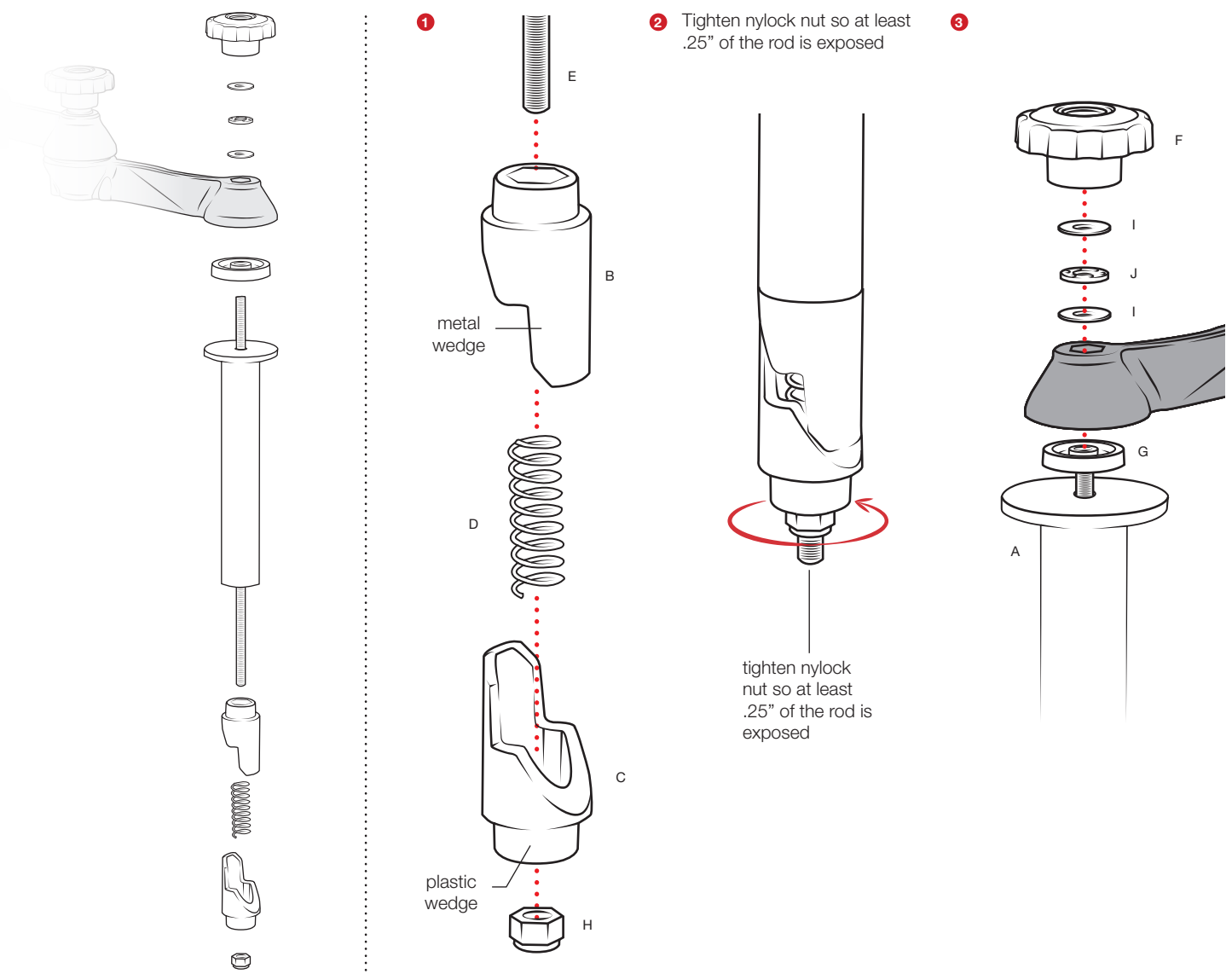
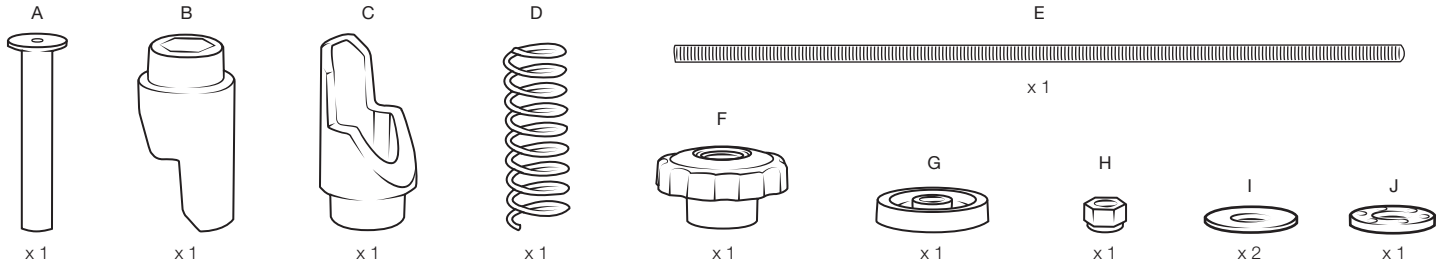

Safety Precaution

Do not install this product near or over an airbag deployment area or in a location that obstructs the driver's vision or interferes with vehicle operation. National Products, Inc does not assume responsibility or liability for any such personal injury, death or property damage.

RMR-INS-VB-TP