



Grand Slam 380 and Grand Slam 380XL Installation Instructions

Patent #7,114,283



GS-380



GS-380XL



Taco Metals, Inc., info@tacomarine.com
TacoMarine.com

Thank you for purchasing a quality Taco Marine product. As a family-owned business since 1959, Taco Marine takes pride in offering the highest quality products with excellent customer service. We stand behind our products 100%. Please visit our website, TacoMarine.com, for more detailed information on a wide variety of Sport Fishing products.

CONTENTS (GS-380 & GS-380XL)

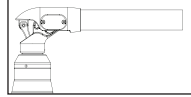

A: 2 - GS-380 Mount
A: 2 - GS-380XL Mount

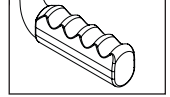

A: 2 - Rotator Handle
A: 2 - Rotator Handle



B: 8 - Vinyl Tubing Spacer
B: 8 - Vinyl Tubing Spacer

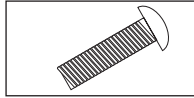

C: 8 - 5/16 x 18 x 1" Bolt
C: 8 - 5/16 x 18 x 5" Bolt



D: 8 - 5/16 x 18 Hex Nut
D: 8 - 5/16 x 18 Hex Nut



E: 8 - Nylon Washer
E: 8 - Nylon Washer

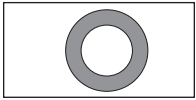

F: 8 - Stainless Washer
F: 8 - Stainless Washer

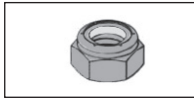

G: Not Included
G: 8 - Stainless Lock Nut

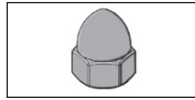

H: Not Included
H: 8 - Stainless Acorn



I: 4 - Hex Bolt for Rotator Handle
I: 4 - Hex Bolt for Rotator Handle

Tools Needed:

Electric Drill with 5/16" Drill Bit • 3/16" Allen Wrench • 1/2" Crescent Wrench

INSTALLATION OF YOUR NEW GRAND SLAM 380/380XL OUTRIGGER MOUNT BASE ON A T-TOP

Canvas Top

It is very important that your mounting surface for the "Grand Slam" (i.e., T-Top, Arch or Hard Top), be suitably constructed to provide a strong mounting area for your outrigger base. It is recommended to use Taco Marine's weld-on Grand Slam extrusions:

GSE-1939BSA20
GSE-1939BSA30-C

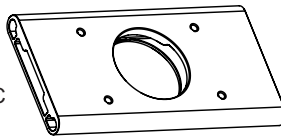

**Optional
Mounting
Plate**

These plates are pre-drilled and ready to install the Grand Slam. If you already have a plate, it should be at least 3/8" thick and 5" wide, with 3-4 welded seams to be used for the full 6" bow to stern.

When installing the Grand Slam through canvas, simply cut an X over the 3-1/8" hole. Install and bolt down the Grand Slam, then trim off the excess canvas.

◆ See Figure 3, Page 5

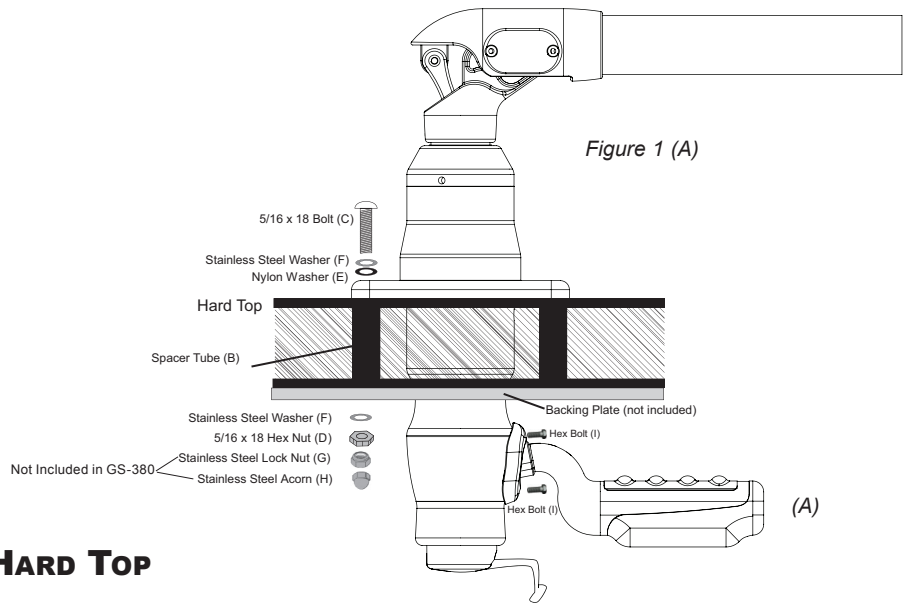

HARD TOP

When installing through a hardtop make sure the top is foam or core filled. It is recommended to use included spacers (small lengths of tubing cut to size) to fit inside where the mounting bolts pass through to ensure that when the bolts are tightened the top is not compressed.



Visit TacoMarine.com for more information

- Backing plates are available for extra strength and recommended when mounting through a hard top (part #BP150BSY-320-1).
- When installing your Grand Slam locate the center of the 3-1/8" hole at least 9-1/2" from the hard top frame, vertical post, or any other object that might hinder the movement of the handle.
- If the top has an arch to it, wedge plates can be ordered to keep the Grand Slams upright and straight (part #WP-150WHA-1).
- The maximum thickness allowable for GS-380 mounting is 2" and for GS-380XL is 4-1/2".
- The 380 and 380XL mounts are a pair of Port and Starboard units. When installing, the Pull pin to release the outrigger needs to face outboard for easy access.
- The rotation handle has 2 possible positions; they are aft and inboard at 90°. When installing the handle make sure it first goes through the larger hole (the one that is shaped like the opening of a doghouse) If reversed the unit will fail to rotate.



INSTALLATION OF YOUR NEW GRAND SLAM 380/380XL OUTRIGGER MOUNT BASE USING A SOLID PLATE

1. Before drilling your bolt holes, cut out a 3-1/8" diameter center hole.
2. When you are finished drilling your 3-1/8" hole, set the base in the hole being careful not to scratch the anodized finish of the lower components, or to damage the white angle height position indicator. **Use your outriggers to help align the base.**
3. The supplied template is only a guide to help align base for true hole positioning. Make sure nothing is rubbing in the 3-1/8" hole. There should be a small gap all the way around.
4. When the Grand Slams are aligned, mark and drill out the bolt holes.
5. Bolts, washers and nuts are provided or if you purchase your own, always use good quality stainless steel hardware when mounting the base. Please do not attempt to weld the base to anything.
6. If using a backing plate, put a bead of marine sealant on the underside of the flat plate. This prevents water drips.

Figure 2

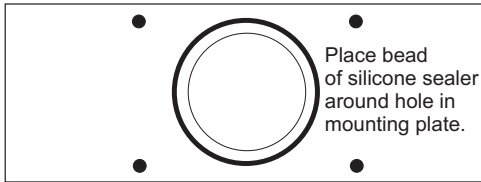

7. Securely bolt the base to the mounting surface. Install operating lever last. Insert lever from the larger open-ended slot, from stern facing position. (The bottom part of the Grand Slam can be rotated to locate this hole). Lubricate threads with marine grade oil or grease, make sure the handle is all the way in.
8. Screw the handle adapter to the mount using the 4mm Hex bolts. Place the outrigger in the arm and test. Pull down on the lever and move port to starboard. Release the lever, and it should go into locking positions. There are 20 locking positions. If the lever does not return up, push left or right until it falls into position.
9. Turn the crank handle to full up and down outrigger position to ensure the outrigger does not interfere with other top mounted accessories.
10. The pull pin to lock the outriggers is spring loaded. Simply pull out the pull pin, rotate 1/4 turn and release. Place your outrigger into the arm and turn the pull pin to snap back into position. Then turn your outrigger until it clicks in the locked position with eyelets facing aft if you are mounting aluminum poles.

Note: Always use a nylon 5/16" washer underneath any stainless steel washer to prevent corrosion of the Grand Slams anodized aluminum mounting base.

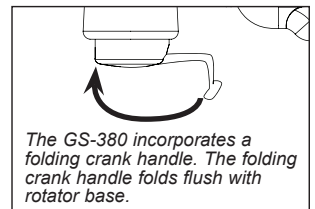
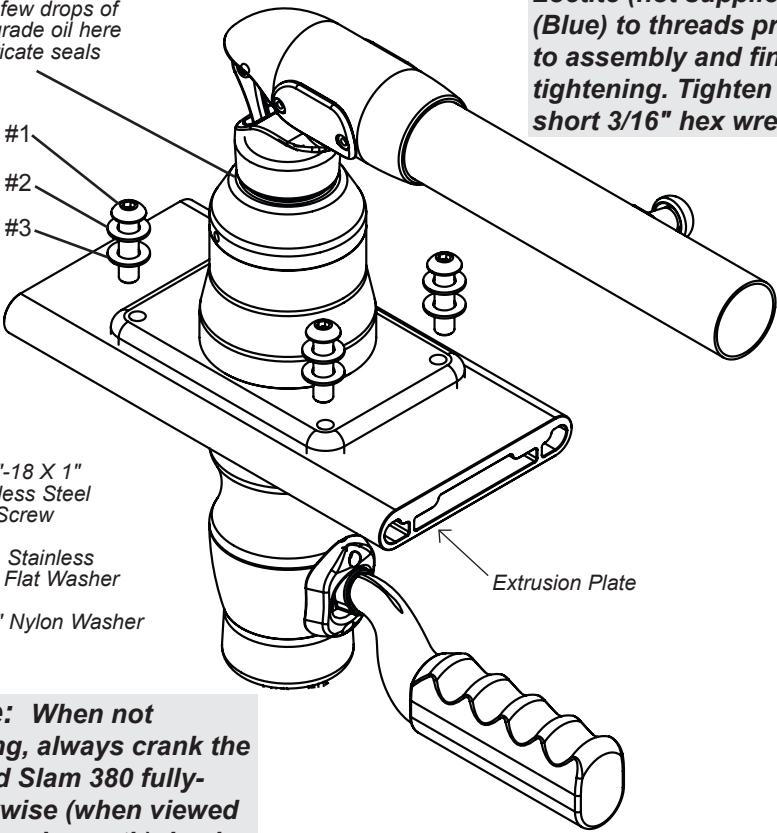

Figure 3

Note: Apply removable Loctite (not supplied) #242 (Blue) to threads prior to assembly and final tightening. Tighten using a short 3/16" hex wrench.

Place a few drops of marine grade oil here to lubricate seals



#1) 5/16"-18 X 1" Stainless Steel Cap Screw

#2) 8mm Stainless Steel Flat Washer

#3) 5/16" Nylon Washer

Extrusion Plate

Note: When not trolling, always crank the Grand Slam 380 fully-clockwise (when viewed from underneath), back to the "run" position using the crank handle and retract outriggers.

TOP MOUNT ORIENTATION

Mount orientation on top with locking pin facing outboard

CARE OF YOUR GRAND SLAMS

Rinse your Taco Marine Grand Slam Mounts and outriggers thoroughly with fresh water after each use. Do not wax or use caustic cleaning agents on any of the components as that promotes corrosion. For extra protection, use marine grade lubricant that does not wash off with rainwater, such as corrosion inhibitor by CRC.

BOW

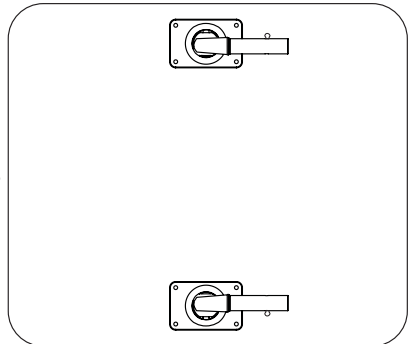

Taco Marine Premium Rigging Kit

- Single Roller Pulley Shock Cord w/Stainless Steel Snap Hook and Eye Insert
- 1/8" thick, 100' Dacron Rigging Cord in Black
- Adjustable Tension Release Clip
- Red & White Balsa Wood Stop
- Pad Eye & Pad Eye Screws
- Double Sleeve Crimp
- Swivel
- Snap Swivel
- Quick Dry Mesh Bag



Taco Marine Outrigger Line Caddy

- Eliminates tangling
- Rugged nylon



Taco Marine Backing Plate

- Additional support when mounting to hard tops and gunnels
- Sold in Pairs



Taco Marine Wedge Plate

- Injection molded plastic
- Ideal for curved t-tops
- Sold in Pairs



Taco Marine Extrusion Plate

- Pre-drilled for easy mounting
- Conceals wiring
- Sold in Pairs



Taco Marine Tele-Outriggers - Aluminum & Carbon Fiber

- Telescopes to less than 6' for bridge clearance, trailering and storage
- Used with mounts that accept 1-1/2" or 1-1/8" Outriggers
- Sold in Pairs



Patent #5,921,196

GS-380 / GS-380XL DRILL TEMPLATE

Note: Please print at 100% for accurate sizing. Slight scaling may still occur. Therefore, before drilling, it is recommended that all template dimensions are measured for accuracy. This should not be used as a drilling template unless dimensions are checked.

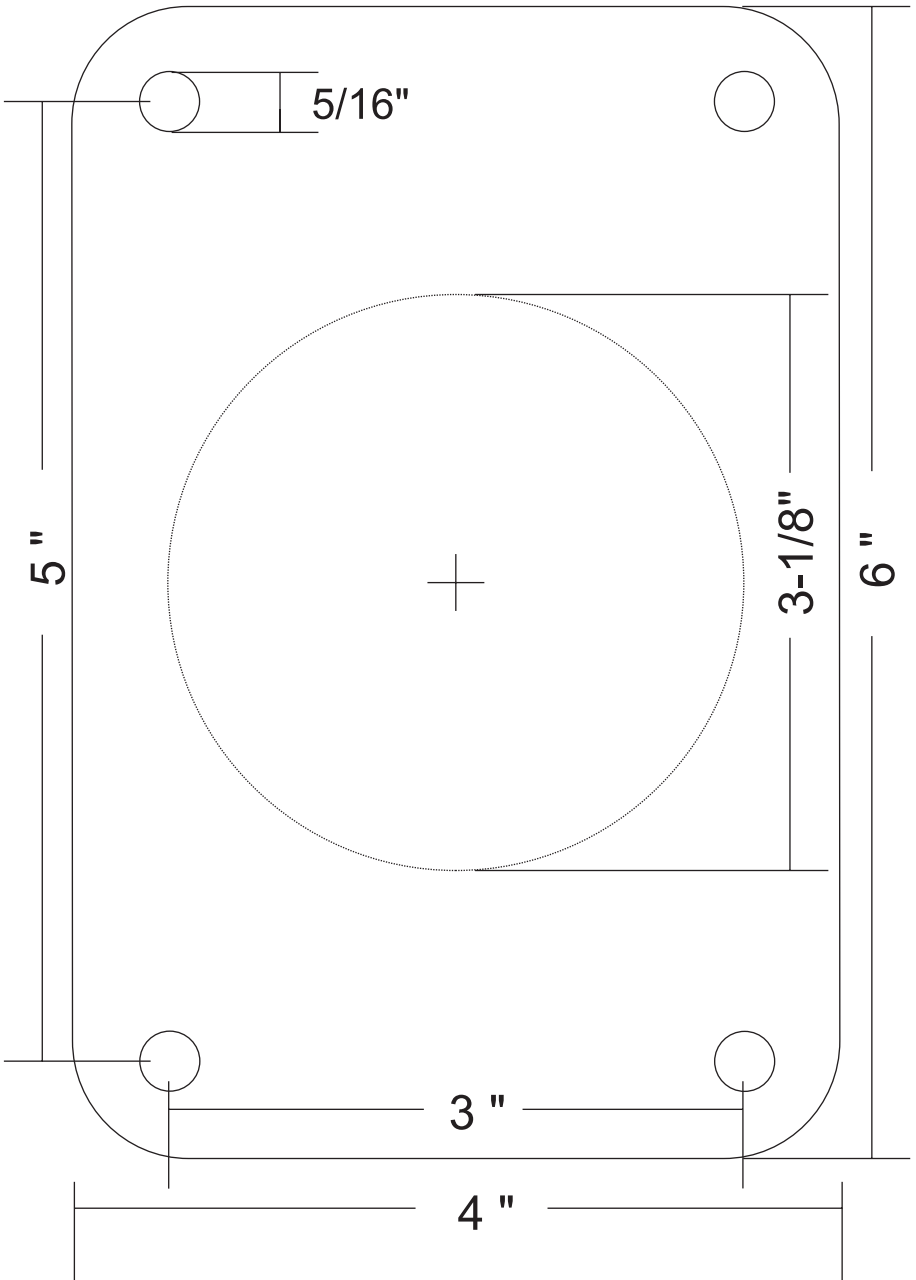



***TacoMarine.com is your “Go To”
place for tips & answers to questions
about Taco Marine products.***

TACO[®]
MARINE



info@tacomarine.com
TacoMarine.com