

GARMIN[®]

PANOPTIX™ LIVESCOPE™

LVS32-TH

INSTALLATION INSTRUCTIONS

Important Safety Information

⚠ WARNING

See the *Important Safety and Product Information* guide in the product box for product warnings and other important information.

The device must be installed with at least one of the included anti-rotation bolts. Failure to do so could result in the device rotating while the boat is moving and could cause damage to your vessel.

You are responsible for the safe and prudent operation of your vessel. Sonar is a tool that enhances your awareness of the water beneath your boat. It does not relieve you of the responsibility of observing the water around your boat as you navigate.

⚠ CAUTION

Failure to install and maintain this equipment in accordance with these instructions could result in damage or injury.

Always wear safety goggles, ear protection, and a dust mask when drilling, cutting, or sanding.

NOTICE

When drilling or cutting, always check what is on the opposite side of the surface.

To obtain the best performance and to avoid damage to your boat, you must install the Garmin[®] transducer according to these instructions.

Read all installation instructions before proceeding with the installation. If you experience difficulty during the installation, contact Garmin Product Support.

Registering Your Device

Help us better support you by completing our online registration today. Keep the original sales receipt, or a photocopy, in a safe place.

- 1 Go to my.garmin.com/registration.
- 2 Sign in to your Garmin account.

Software Update

You must update the software when you install this device.

If your Garmin chartplotter has Wi-Fi[®] technology, you should update the software using the ActiveCaptain™ app on a compatible Android™ or Apple[®] device. If your chartplotter does not have Wi-Fi technology, you should update the software using a memory card and a Windows[®] computer.

For more information, go to support.garmin.com.

Tools Needed

- Drill
- 3 mm bit (1/8 in.)
- 9 mm bit (3/8 in.)
- 12 mm bit (1/2 in.) (metal hull)
- 13 mm bit (1/2 in.) (fiberglass hull)

- 32 mm spade bit (1 1/4 in.) (fiberglass hull)
- 38 mm hole saw (1 1/2 in.) (metal hull)
- Bandsaw or table saw
- Slip-joint pliers or crescent wrench
- Masking tape
- Marine sealant
- Solvent wash
- Marine-grade epoxy or exposed core sealant that can be used on plastic (cored fiberglass hull)

About the Transducer

The transducer transmits and receives sound waves through the water, and relays sound-wave information to your Garmin sonar device.

Mounting Location Considerations

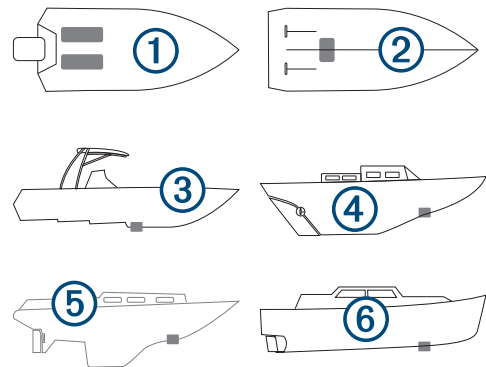

- On outboard and sterndrive vessels ①, the transducer should be mounted in front of and close to the engine or engines.
- On inboard vessels ②, the transducer should be mounted in front of and far away from the engine propeller and shaft.
- On step-hull vessels ③, the transducer should be mounted in front of the first step.
- On full-keel vessels ④, the transducer should be mounted at a slight angle that aims at the bow, not parallel to the centerline.
- On fin-keel vessels ⑤, the transducer should be mounted from 25 cm to 75 cm (from 10 to 30 in.) in front of the keel and a maximum of 10 cm (4 in.) to the side of the centerline.
- On vessels with displacement hulls ⑥, the transducer should be mounted approximately 1/3 aft of the waterline length of the vessel from the bow, and from 150 to 300 mm (from 6 to 12 in.) to the side of the centerline.
- The transducer should be mounted parallel to the bow-stern axis of your vessel.
- The transducer should not be mounted behind strakes, struts, fittings, water intake or discharge ports, or anything that creates air bubbles or causes the water to become turbulent. The transducer must be in clean (non-turbulent) water for optimal performance.
- The transducer should not be mounted in a location where it might be jarred when launching, hauling, or storing.
- On single-drive boats, the transducer must not be mounted in the path of the propeller. The transducer can cause cavitation that can degrade the performance of the boat and damage the propeller.
- On twin-drive boats, the transducer should be mounted between the drives, if possible.

Mounting Considerations

- You must install the sonar module in a location with adequate ventilation where it will not be exposed to extreme temperatures.
- You should mount the transducer in a location where it will not be jarred when launching, hauling, or storing.
- You should mount the transducer in a location where it is not behind strakes, struts, fittings, water intake or discharge ports, thru-hull transducers, or anything that creates air bubbles or causes the water to become turbulent. Turbulent water may interfere with the sonar beam.
- You should mount the transducer in a location where there are no bulkheads or stringers on the interior of the boat that impede a clear surface for the fairing block.
- You should mount the transducer as close to the center line of the boat as possible.
- When mounted farther from the center of the transom, a greater deadrise can cause the boat hull ① to interfere with the sonar beam ②, and can cause inconsistent detection on the opposite side of the boat ③. These illustrations show the transducer ifrom behind.

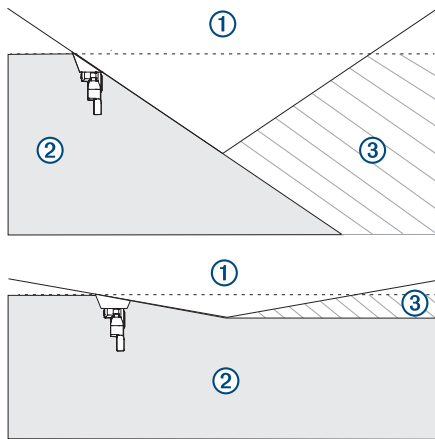

- On single-drive vessels, you must not mount the transducer in the path of the propeller.
- On twin-drive vessels, you should mount the transducer between the drives, if possible.
- You should mount the sonar module in a location where the LEDs are visible.
- You should mount the sonar module in a location where the cables can be easily connected.

Fairing Block Angle Cut

A fairing block positions your transducer parallel to the water line for increased sonar accuracy. You must measure the deadrise angle of your boat hull to determine if a fairing block is necessary to mount the transducer. If the deadrise angle of your mounting location exceeds 5°, you should use a fairing block to mount the transducer.

Deadrise Angle

Deadrise is the angle formed between a horizontal line and a boat hull at a single point. You can measure the deadrise angle with a smartphone application, an angle finder, a protractor, or a digital level. You can also ask your boat manufacturer for the deadrise angle of the specific point on your boat hull.

NOTE: A boat may have several deadrise angles depending on the shape of the hull. Measure the deadrise angle only at the location where you plan to install the transducer.

Cutting the Fairing Block

⚠ CAUTION

Always wear safety goggles, ear protection, and a dust mask when drilling, cutting, or sanding.

- 1 Using wood screws, attach the fairing block to a piece of wood. The wood becomes a cutting guide for the fairing block.
- 2 Measure the deadrise angle of the hull at the mounting location.
- 3 Tilt your table saw blade ① to match the deadrise angle and secure the cutting fence.

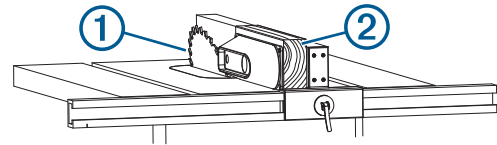

- 4 Position the fairing block on the table so the cutting guide rests against the fence ② and the angle matches the angle of the mounting location.
- 5 Adjust the cutting fence to ensure the fairing block ③ has a minimum thickness ④ of 2 mm (1/16 in.).

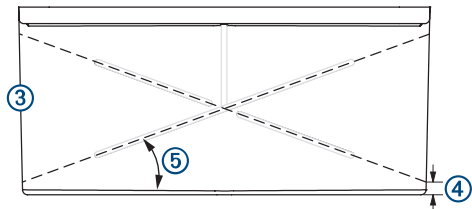

NOTE: The maximum cutting angle ⑤ of the fairing block is 25°.

- 6 Cut the fairing block.
- 7 Using a rasp or power tool, shape the fairing block to the hull as precisely as possible.
- 8 Use the remaining section of the fairing block as the backing block inside the hull.

Mounting the Sonar Module

Mounting the Panoptix LiveScope GLS 10 Device

NOTICE

If you are mounting the device in fiberglass, when drilling the pilot holes, it is recommended to use a countersink bit to drill a clearance counterbore through only the top gel-coat layer. This will help to avoid cracking in the gel-coat layer when the screws are tightened.

NOTE: Stainless-steel screws may bind when screwed into fiberglass and overtightened. It is recommended to apply an anti-seize lubricant to the screws before installing them.

NOTE: Screws are included with the device, but they may not be suitable for the mounting surface.

Before you mount the device, you must select a mounting location and determine what screws and other mounting hardware are needed for the surface.

- 1 Place the device in the mounting location and mark the location of the pilot holes.
- 2 Drill a pilot hole for one corner of the device.
- 3 Loosely fasten the device to the mounting surface with one corner and examine the other three pilot-hole marks.
- 4 Mark new pilot-hole locations if necessary, and remove the device from the mounting surface.

- 5 Drill the remaining pilot holes.
- 6 Secure the device to the mounting location.

Blink Codes

After the sonar module is installed, it turns on when the chartplotter is turned on. The color status LED on the sonar module indicates its operational status.

LED Color	State	Status
Green	Blinking	The sonar module is connected to a chartplotter and is operating properly. You should see sonar data on the chartplotter.
Red	Blinking	The sonar module is turned on, but is not connected to a chartplotter, or is waiting to connect to a chartplotter. If the sonar module is connected to the chartplotter and this code persists, check the wiring connections.
Orange	Blinking	A software update is in progress.
Red/Green	Blinking	Reserved
Red	Two blinks followed by a 3-second pause	Other sonar failure.
Red	Three blinks followed by a 3-second pause	The transducer is not detected by the sonar module. If this code persists, check the wiring connections.
Red	Five blinks followed by a 3-second pause	The sonar module input voltage exceeds the maximum input voltage.

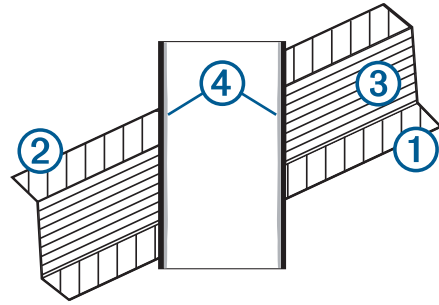

The hole must be perpendicular to the water surface.

- 4 Place masking tape over the pilot hole and surrounding area outside the hull to prevent damage to the fiberglass.
- 5 Using a 32 mm (1 1/4 in.) bit at the stem hole location, drill from outside the hull through the outer skin (1), inner skin (2), and the core (3).

The hole must be perpendicular to the water surface.

- 6 Sand and clean the inner skin, core, and outer skin around the hole.
- 7 Seal the exposed inner core with epoxy (4), and allow the epoxy to set thoroughly.
- 8 While holding a drill with a 9 mm (3/8 in.) bit plumb, drill the anti-rotation bolt hole through the hull from outside the hull. The hole must be perpendicular to the water surface.
- 9 Sand and clean the area around the hole with a solvent wash to remove dust particles.

Applying Marine Sealant to a Thru-Hull Transducer

You must apply marine sealant to the transducer to ensure a tight, waterproof seal between the fairing block and the hull. Do not apply sealant directly to the stem or anti-rotation bolt.

Apply marine sealant (1) around the base of the stem and anti-rotation bolt on the transducer.

Cored Fiberglass Boat Hull Installation Instructions

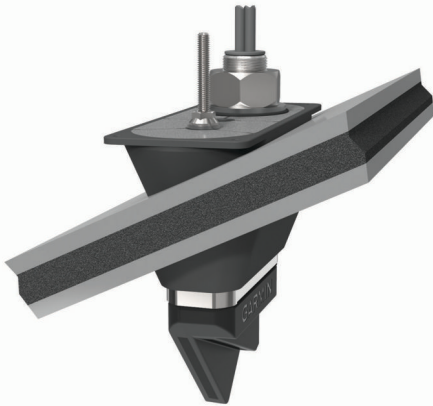

Installing a Thru-Hull Transducer with a Fairing Block

Drilling the Transducer Stem Hole and the Anti-Rotation Bolt Hole in a Cored Fiberglass Hull

Before you can drill the hole for the anti-rotation bolt, you must drill the hole for the transducer stem (*Drilling the Transducer Stem Hole and the Anti-Rotation Bolt Hole in a Cored Fiberglass Hull*, page 3) and you must cut the fairing block (*Cutting the Fairing Block*, page 2).

The core must be cut and sealed carefully to protect against water seepage.

- 1 Select a mounting location without surface irregularities or obstructions.
- 2 Using the template, mark the location of the stem hole and anti-rotation bolt.
- 3 Drill a 3 mm (1/8 in.) pilot hole through the template and hull at the stem hole location.

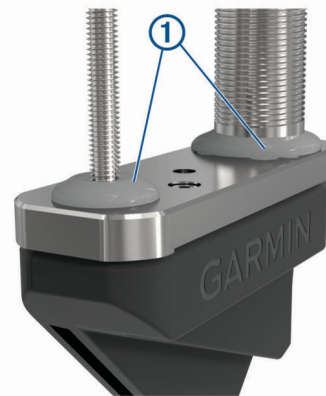

Installing the Transducer with a Fairing Block

It is recommended that two installers complete these instructions, with one positioned outside the boat and one inside the boat.

NOTE: When installing the transducer in a cored fiberglass hull, avoid over-tightening the nuts to prevent damaging the hull.

- 1 Apply marine sealant at the base of the anti-rotation bolt (1) and transducer stem (2).

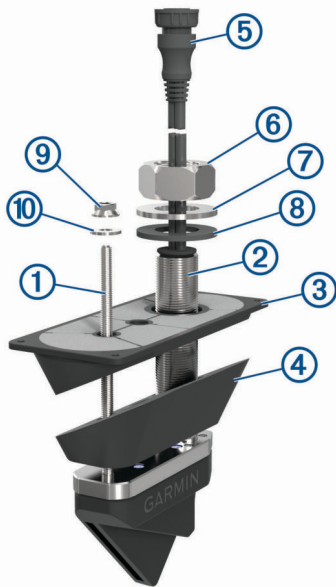

- 2 Seat the transducer housing firmly within the fairing block ③ recess.
- 3 Apply marine sealant to the face of the fairing block ④ that must contact the hull.
- 4 Apply marine sealant to the face of the backing block that must contact the inner hull.
- 5 From outside the hull, insert the transducer cable ⑤ and transducer stem through the mounting hole.
- 6 From inside the hull, slide the backing block onto the transducer stem and seat it firmly against the inner hull. The fairing and transducer must be parallel to the keel.
- 7 From inside the hull, apply the included anti-seize compound to the exposed transducer stem and anti-rotation bolt.
- 8 From inside the hull, use slip-joint pliers or a crescent wrench to secure the backing block to the transducer stem with the included 46 mm hull nut ⑥, nylon washer ⑦, and rubber washer ⑧. Do not over-tighten the hull nut.
- 9 From inside the hull, use slip-joint pliers or a crescent wrench to secure the backing block to the anti-rotation bolt with the included M8 nut ⑨ and 8 mm washer ⑩. Do not over-tighten the M8 nut.
- 10 Before the sealant hardens, remove all excess sealant on the outside of the fairing block and exterior hull to ensure smooth water flow over the transducer.

Non-cored/Fiberglass/Wooden Boat Hull Installation Instructions

Thru-Hull Transducer in a Non-cored/Fiberglass Hull with a Fairing Block

If the deadrise angle of your mounting location exceeds 5°, you should use a fairing block to mount the device.



Drilling the Transducer Stem Hole and the Anti-Rotation Bolt Hole in a Non-Cored or Fiberglass Hull

Before you can drill holes for the anti-rotation bolts, you must drill the hole for the transducer stem, and you must cut the fairing block ([Cutting the Fairing Block, page 2](#)).

You should follow these instructions when you are using a fairing block to mount the transducer on a boat that does not have a cored fiberglass hull.

- 1 Select a mounting location without surface irregularities or obstructions.
- 2 Using the template, mark the location of the stem hole and anti-rotation bolt.
- 3 Drill a 3 mm ($1/8$ in.) pilot hole through the hull at the stem hole location, from outside the hull. The hole must be perpendicular to the water surface.
- 4 If the vessel has a fiberglass hull, place masking tape over the pilot hole and surrounding area outside the hull to prevent damage to the fiberglass.
- 5 If you taped over the pilot hole, use a utility knife to cut out the hole in the tape.
- 6 While holding a 32 mm ($1 1/4$ in.) spade bit plumb, cut a hole from outside the hull at the stem hole location. The hole must be perpendicular to the water surface.
- 7 Sand and clean the area around the hole.
- 8 While holding a drill with a 9 mm ($3/8$ in.) bit plumb, drill the anti-rotation bolt hole through the hull. The holes must be perpendicular to the water surface.
- 9 Sand and clean the area around the holes with a solvent wash to remove dust particles.

Applying Marine Sealant to a Thru-Hull Transducer

You must apply marine sealant to the transducer to ensure a tight, waterproof seal between the fairing block and the hull. Do not apply sealant directly to the stem or anti-rotation bolt.

Apply marine sealant ① around the base of the stem and anti-rotation bolt on the transducer.



Installing the Transducer with a Fairing Block

It is recommended that two installers complete these instructions, with one positioned outside the boat and one inside the boat.

NOTE: When installing the transducer in a cored fiberglass hull, avoid over-tightening the nuts to prevent damaging the hull.

- 1 Apply marine sealant at the base of the anti-rotation bolt ① and transducer stem ②.

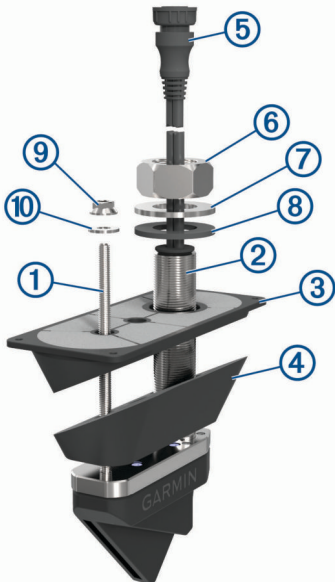

- 2 Seat the transducer housing firmly within the fairing block ③ recess.
- 3 Apply marine sealant to the face of the fairing block ④ that must contact the hull.
- 4 Apply marine sealant to the face of the backing block that must contact the inner hull.
- 5 From outside the hull, insert the transducer cable ⑤ and transducer stem through the mounting hole.
- 6 From inside the hull, slide the backing block onto the transducer stem and seat it firmly against the inner hull. The fairing and transducer must be parallel to the keel.
- 7 From inside the hull, apply the included anti-seize compound to the exposed transducer stem and anti-rotation bolt.
- 8 From inside the hull, use slip-joint pliers or a crescent wrench to secure the backing block to the transducer stem with the included 46 mm hull nut ⑥, nylon washer ⑦, and rubber washer ⑧.

Do not over-tighten the hull nut.

- 9 From inside the hull, use slip-joint pliers or a crescent wrench to secure the backing block to the anti-rotation bolt with the included M8 nut ⑨ and 8 mm washer ⑩.

Do not over-tighten the M8 nut.

- 10 Before the sealant hardens, remove all excess sealant on the outside of the fairing block and exterior hull to ensure smooth water flow over the transducer.

Thru-Hull Transducer in a Non-cored/Fiberglass Hull without a Fairing Block

If the deadrise angle of your mounting location does not exceed 5°, you can mount the device without a fairing block.



Drilling the Transducer Stem and Anti-Rotation Bolt Holes

You should follow these instructions if you are installing your transducer on a fiberglass boat and you are not using a fairing block or isolator plate.

- 1 Trim the included transducer template.
- 2 Select a mounting location without surface irregularities or obstructions.
- 3 Using the template, mark the location of the stem hole and anti-rotation bolt.
- 4 While holding a 32 mm (1 1/4 in.) spade bit plumb, drill the transducer stem hole from outside the hull. The hole must be perpendicular to the water surface.
- 5 While holding a drill with an 9 mm (3/8 in.) bit plumb, drill the anti-rotation bolt hole from outside the hull. The holes must be perpendicular to the water surface.
- 6 Sand and clean the inner skin, core, and outer skin around the holes.

Applying Marine Sealant to a Thru-Hull Transducer

You must apply marine sealant to the transducer to ensure a tight, waterproof seal between the fairing block and the hull. Do not apply sealant directly to the stem or anti-rotation bolt.

Apply marine sealant ① around the base of the stem and anti-rotation bolt on the transducer.

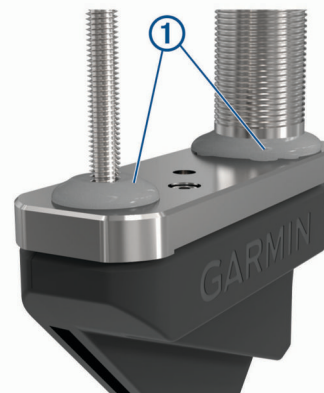

Installing the Transducer without a Fairing Block

It is recommended that two installers complete these instructions, with one positioned outside the boat and one inside the boat.

NOTE: When installing a transducer in a non-cored fiberglass hull, avoid over-tightening the nuts to prevent damaging the hull.

- 1 Apply marine sealant to the base of the transducer stem ①, anti-rotation bolt ②, and the sides of the transducer plate ③ that must contact the hull.

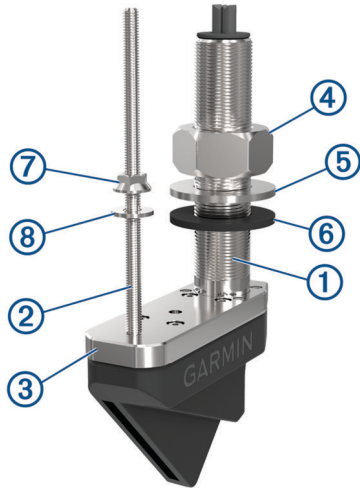

- 2 From outside the hull, insert the transducer through the mounting hole and seat it firmly against the hull.
- 3 From inside the hull, apply the included anti-seize compound to the exposed transducer stem and anti-rotation bolt.
- 4 From inside the hull, use slip-joint pliers or a crescent wrench to secure the included 46 mm hull nut ④, nylon washer ⑤, and rubber washer ⑥ to the transducer stem. Do not over-tighten the hull nut.
- 5 From inside the hull, use slip-joint pliers or a crescent wrench to secure the included M8 nut ⑦ and 8 mm nylon washer ⑧ to the anti-rotation bolt. Do not over-tighten the M8 nut.
- 6 Before the sealant hardens, remove all excess sealant on the outside of the exterior hull to ensure smooth water flow over the transducer.

Metal Boat Hull Installation Instructions

Thru-Hull Transducer in a Metal Hull with a Fairing Block

If the deadrise angle of your mounting location exceeds 5°, you should use a fairing block to mount the device.



Drilling the Transducer Stem Hole and the Anti-Rotation Bolt Hole in a Metal Hull

You should follow these instructions when you are using a fairing block to mount the transducer on a boat that has a metal hull.

- 1 Select a mounting location without surface irregularities or obstructions.
- 2 Using the template, mark the location of the stem hole and anti-rotation bolt.
- 3 Drill a 3 mm ($\frac{1}{8}$ in.) pilot hole through the hull at the stem hole location, from outside the hole. The hole must be perpendicular to the water surface.
- 4 Using a 38 mm ($1\frac{1}{2}$ in.) hole saw, cut the stem hole from outside the hull. The hole must be perpendicular to the water surface.
- 5 While holding a drill with a 13 mm ($\frac{1}{2}$ in.) bit plumb, drill the anti-rotation bolt hole through the hull from outside the hull.
- 6 Sand and clean the area around the holes.

Applying Marine Sealant to a Thru-Hull Transducer

You must apply marine sealant to the transducer to ensure a tight, waterproof seal between the fairing block and the hull. Do not apply sealant directly to the stem or anti-rotation bolt.

Apply marine sealant ① around the base of the stem and anti-rotation bolt on the transducer.

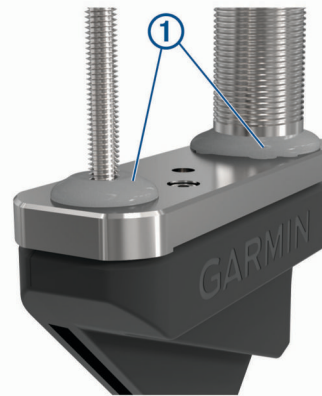

Installing the Transducer with a Fairing Block and Bushings

It is recommended that two installers complete these instructions, with one positioned outside the boat and one inside the boat.

- 1 Secure the bushings ① to the anti-rotation bolt ② and transducer stem ③.

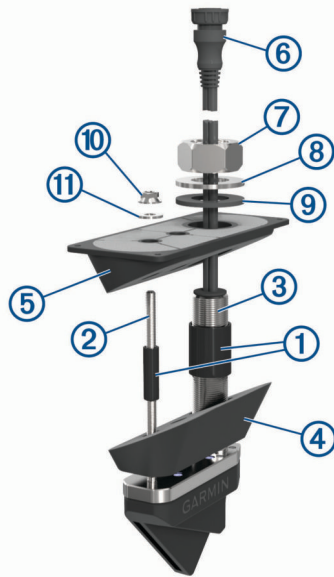

- 2 Apply marine sealant to the bushings, and at the base of the anti-rotation bolt and transducer stem.
- 3 Seat the transducer housing firmly within the fairing block ④ recess.
- 4 Apply marine sealant to the side of the fairing block that must contact the hull.
- 5 Apply marine sealant to the side of the backing block ⑤ that must contact the hull.
- 6 From outside the hull, insert the transducer cable ⑥ and transducer housing through the mounting hole.
- 7 From inside the hull, slide the backing block onto the transducer and seat it firmly against the hull.
- 8 Apply the included anti-seize compound to the exposed transducer stem and anti-rotation bolt.
- 9 From inside the hull, use slip-joint pliers to secure the backing block to the transducer stem with the included 46 mm hull nut ⑦, the nylon washer ⑧, and the rubber washer ⑨.
- 10 From inside the hull, use slip-joint pliers to secure the backing block to the anti-rotation bolts with the included M8 nut ⑩ and 8 mm washer ⑪.
- 11 Before the sealant hardens, remove all excess sealant on the outside of the fairing block and exterior hull to ensure smooth water flow over the transducer.

Thru-Hull Transducer in a Metal Hull without a Fairing Block

If the deadrise angle of your mounting location does not exceed 5 degrees, you can mount the device without a fairing block.



Drilling the Transducer Stem and Anti-Rotation Bolt Holes

You should follow these instructions if you are mounting your transducer on a metal hull boat and you are not using a fairing block.

- 1 Trim the included transducer template.
- 2 Select a mounting location without surface irregularities or obstructions.
- 3 Using the template, mark the location of the stem hole and anti-rotation bolt.
- 4 Drill a 3 mm ($\frac{1}{8}$ in.) pilot hole through the hull at the stem hole location, from outside the hull.
- 5 Using a 38 mm ($1\frac{1}{2}$ in.) hole saw, cut the stem hole from outside the hull.
The hole must be perpendicular to the water surface.
- 6 While holding a drill with a 12 mm ($\frac{1}{2}$ in.) bit plumb, drill the anti-rotation bolt hole from outside the hull.
The holes must be perpendicular to the water surface.
- 7 Remove the template from the mounting location.
- 8 Sand and clean the area around the holes with a solvent wash to remove dust particles.

Installing the Transducer in a Metal Hull without a Fairing Block

It is recommended that two installers complete these instructions, with one positioned outside the boat and one inside the boat.

NOTE: When installing a transducer in an aluminum or steel hull, you must use the included isolation plate.

- 1 Secure the bushings ① to the anti-rotation bolt ② and transducer stem ③.
- 2 Seat the isolation plate ④ firmly against the transducer.

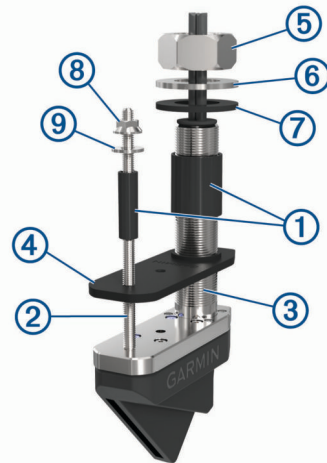

- 3 Apply marine sealant to the base of the transducer stem and anti-rotation bolt, and the side of the isolation plate that must contact the hull.
NOTE: Apply enough marine sealant on all surfaces to ensure bonding between the plate and the hull, including a tight perimeter seal.
- 4 From outside the hull, insert the transducer through the mounting hole and seat it firmly against the hull.
- 5 From inside the hull, apply the included anti-seize compound to the exposed transducer stem and anti-rotation bolts.
- 6 From inside the hull, use slip-joint pliers or a crescent wrench to secure the included 46 mm hull nut ⑤, nylon washer ⑥, and rubber washer ⑦ to the transducer stem.
- 7 From inside the hull, use slip-joint pliers to secure the included M8 nut ⑧ and 8 mm nylon washer ⑨ to the anti-rotation bolt.

- 8 Before the sealant hardens, remove all excess sealant on the outside of the exterior hull to ensure smooth water flow over the transducer.

Maintenance

Testing the Installation

NOTICE

You should check your boat for leaks before you leave it in the water for an extended period of time.

Because water is necessary to carry the sonar signal, the transducer must be in the water to work properly. You cannot get a depth or distance reading when out of the water. When you place your boat in the water, check for leaks around any screw holes that were added below the water line.

Anti-Fouling Paint

To prevent corrosion of metal and to slow the growth of organisms that can affect a vessel's performance, you should apply a water-based anti-fouling paint to the transducer every six months.

NOTE: Never apply ketone-based anti-fouling paint to your vessel, because ketones attack many types of plastic and could damage or destroy your transducer.

Cleaning the Transducer

Aquatic fouling accumulates quickly and can reduce your device's performance.

- 1 Remove the fouling with a soft cloth and mild detergent.
- 2 If the fouling is severe, use a scouring pad or putty knife to remove growth.
- 3 Wipe the device dry.

Specifications

Panoptix LiveScope LVS32-TH Specifications

Dimensions (L x H x W)	136.4 x 96.5 x 44.5 mm (5.37 x 3.8 x 1.75 in.)
Weight (transducer only)	850 g (1.87 lbs.)
Frequencies	From 530 to 1.1 MHz
Operating temperature	From 0 to 40°C (from 32 to 104°F)
Storage temperature	From -40 to 85°C (from -40 to 185°F)
Maximum depth/distance*	61 m (200 ft.)
Field of view	Front to back: 135 degrees Side-to-side: 20 degrees

*Dependent upon water salinity, bottom type, and other water conditions.

Panoptix LiveScope GLS 10 Sonar Module Specifications

Dimensions (W x H x D)	245 x 149 x 65 mm (9.7 x 5.9 x 2.6 in.)
Weight	1.96 kg (4.33 lbs.)
Operating temperature	From -15 to 70°C (from 5 to 158°F)
Storage temperature	From -40 to 85°C (from -40 to 185°F)
Power input	From 10 to 32 Vdc
Power usage	21 W typical, 24 mW min., 58 W max.
Compass-safe distance	178 mm (7 in.)
Data output	Garmin Marine Network

Open-Source Software License

To view the open-source software license(s) used in this product, go to developer.garmin.com/open-source/linux/.

© 2019 Garmin Ltd. or its subsidiaries

Garmin® and the Garmin logo are trademarks of Garmin Ltd. or its subsidiaries, registered in the USA and other countries. ActiveCaptain™, LiveScope™, Panoptix™, and SteadyCast™ are trademarks of Garmin Ltd. or its subsidiaries. These trademarks may not be used without the express permission of Garmin.

Android™ is a trademark of Google Inc. Apple® is a trademark of Apple Inc., registered in the U.S. and other countries. Wi-Fi® is a registered trademark of Wi-Fi Alliance Corporation. Windows® is a registered trademark of Microsoft Corporation in the United States and other countries. Other trademarks and trade names are those of their respective owners.

