

MODEL P1120 | 3-COLOR MARINE-GRADE LED SURFACE LIGHT

The Profile Tri-Light is an IP67 marine-grade LED surface light. With i2Systems patented and award winning i2Sync™ technology, users are able to change between 3 colors of light by simply toggling the power to the fixture. With stainless steel construction and the option for either titanium-coated PVD or mil-spec powder-coated finish, expect a premium finish that will withstand the elements of time.

US 8,013,538 | US 8,436,553
Additional Patents Pending

CUSTOMER COMPANY	CUSTOMER CONTACT
P.O. #	CUSTOMER PHONE #
SHIPPING ADDRESS	

FIXTURE BUILDER

P1120Z	-		1				OPTIONS
--------	---	--	---	--	--	--	----------------

FIXTURE TYPE

Profile Tri-Light



FINISH

PVD Titanium Coated

- 1** Polished Chrome
- 2** Polished Gold
- 4** Brushed Nickel

Powder Coated

- 3** White
- 5** Off-White

BEZEL SHAPE

- 1** Round

LED COLOR (PICK 3*)

- A** Cool White 6500°K
- C** Warm White 3000°K
- D** Green*
- E** Blue*
- G** Cyan*
- H** Red*

RETAIL PACKAGING

Products available in retail packaging are listed below.

**When specifying Tri-Light colors, the LED color order specified above is the order that the colors will cycle. Some color configurations may require a minimum order.*

ACCESSORIES

TOGGLE SWITCH

MOUNTING SPACER

PN	SWITCHES
MS24523-29	Sealed Toggle Switch
46000	Toggle Switch

PN	SPACER
<input type="checkbox"/> 5120147	Spacer for Wire Side Exit

Toggle switches are optional. For retrofits, provided you have a power on/off switch for your lights, no additional switches or equipment are required.

RETAIL PACKAGING

SHIPS FROM STOCK IN RETAIL BLISTER PACK

PART NUMBER	LED COLOR	FINISH
P1120Z-11HAE	Red, Cool White, Blue	Chrome
P1120Z-31HAE	Red, Cool White, Blue	White
P1120Z-11HCE	Red, Warm White, Blue	Chrome
P1120Z-41HCE	Red, Warm White, Blue	Brushed Nickel
P1120Z-51HCE	Red, Warm White, Blue	Off-White

QUICK SPECS

Input Voltage	9-30V DC
Input Power	1.5 Watts
Beam Angle	120° Full Angle
Operating Temp	-20°C to 40°C
Max. Case Temp	50°C
IP Rating	IP67
Wiring	18" Twisted 18 AWG
Housing	Stainless Steel
Lens	Polycarbonate w/ Diffuser

DIMENSIONS

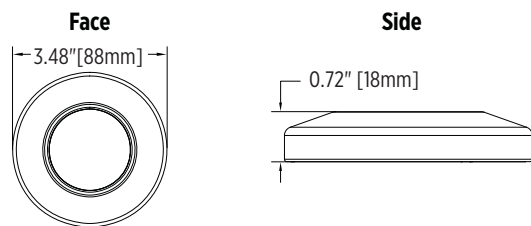

MOUNTING

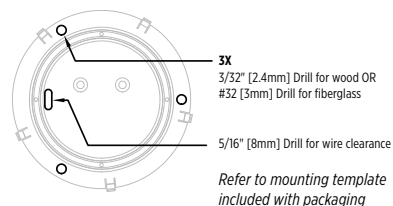

WIRE FUNCTION

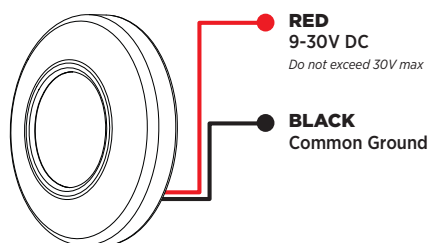

Using Tri-Light Fixtures

To cycle through colors: using your on/off switch or a normally closed momentary switch, turn the fixture(s) off, then back on again quickly (i.e. less than 1 second). When the power returns, the fixture(s) will power on the next color.

Color order is: Color 1, Color 2, Color 3, Off, Color 1, Color 2, etc.

When using multiple fixtures, should the fixtures ever fail to synchronize, turn the fixtures off for a prolonged period (i.e. more than 3 seconds). When power returns, all fixtures will default back to their initial state.

Upon initial power on, fixtures default to the off-state.

PATENTED TECHNOLOGY

PROTECTION FEATURES

- Electrical Protection**
 - Transient Protection
 - Reverse Polarity Protection

WIRING EXAMPLE

12/24V DC WITH MOMENTARY SWITCH

