

EN	Holding Tank System Instruction manual.	8
DE	Schmutzwassertank-System Einbauanleitung.	17
FR	Système de réservoir d'eaux noires Mode d'emploi	25
ES	Sistema de depósito de retención Manual de instrucciones.	34
NL	Vuilwatertank-systeem Gebruiksaanwijzing.	43
IT	Impianto del serbatoio di ritenzione Manuale di istruzioni	51
FI	Keräyssäiliöjärjestelmä Ohjekirja.	59
SV	Avloppstank system Bruksanvisning	67
DA	Lagertanksystem Instruktionsvejledning	75
NO	Oppbevaringstank-system Brukerhåndbok	83

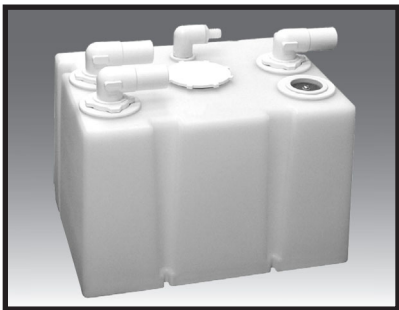

DHT-L Series Holding Tanks

1

DHT42L

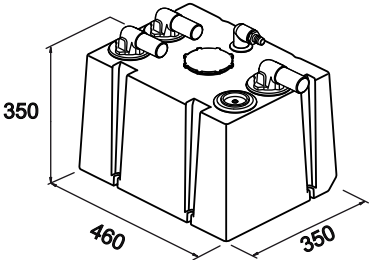

DHT61L

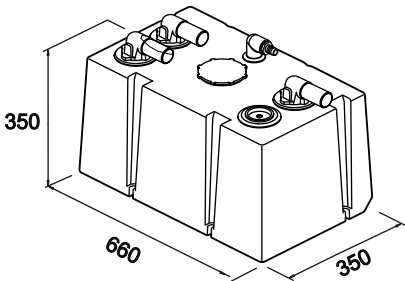

DHT88L

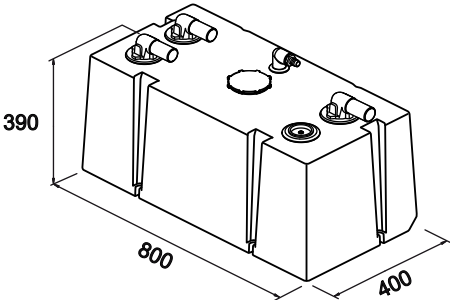

DHT110L

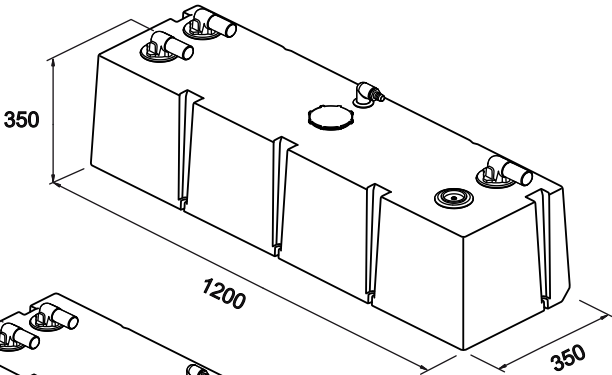

DHT137L

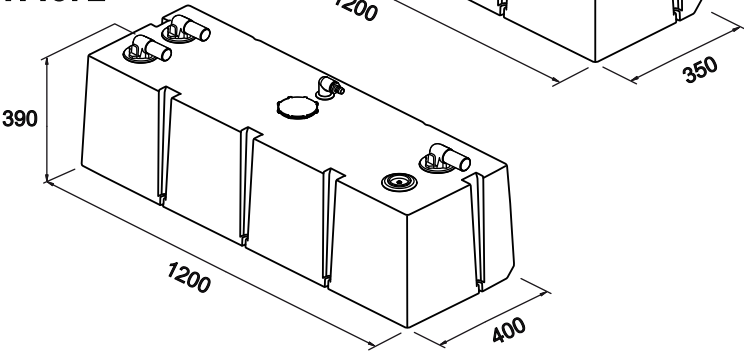

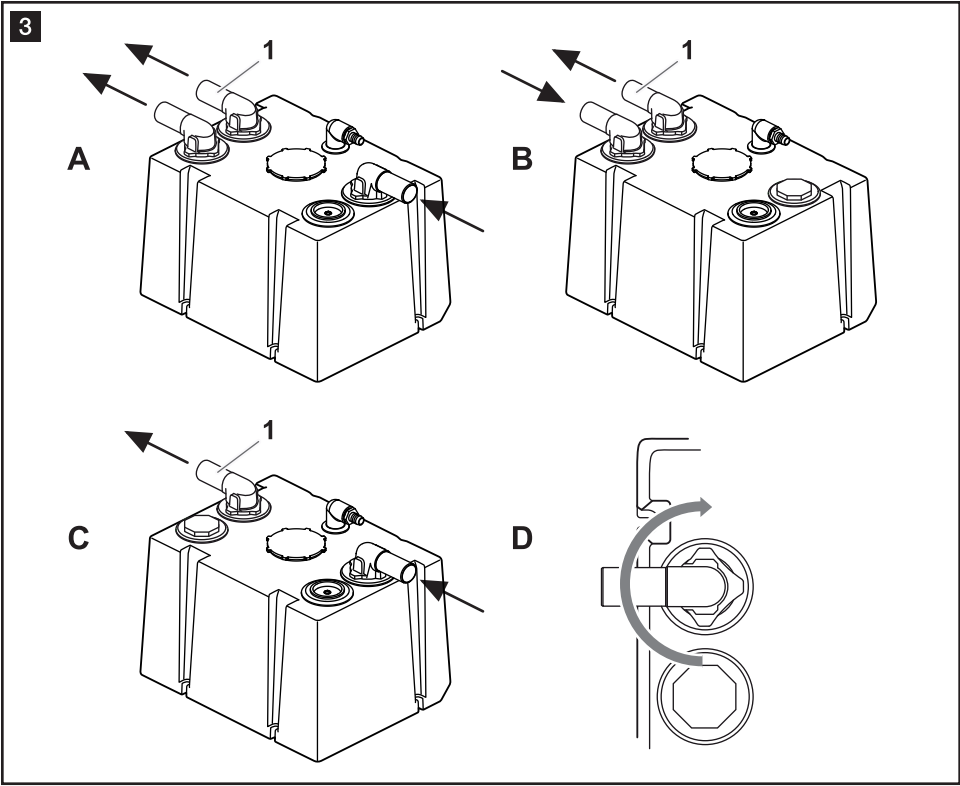
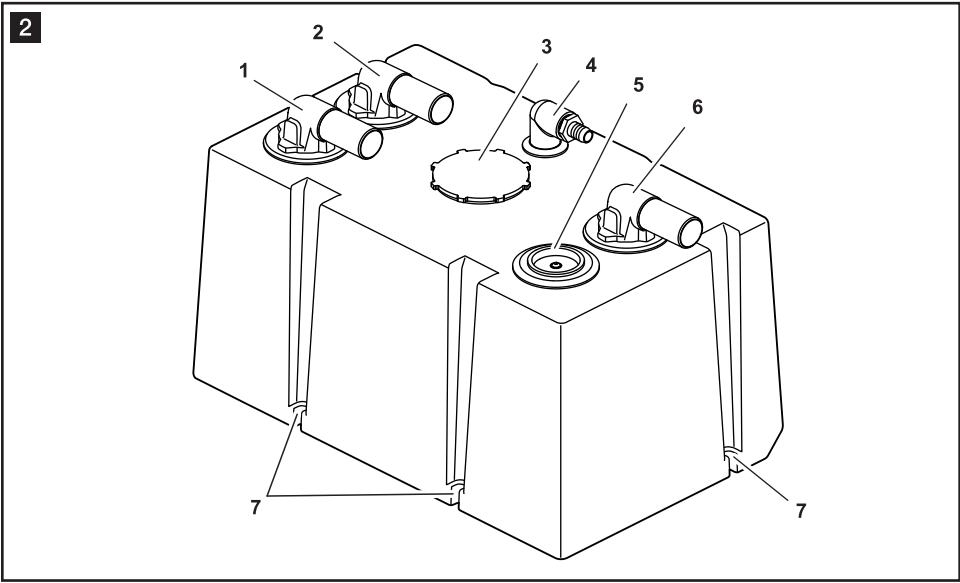

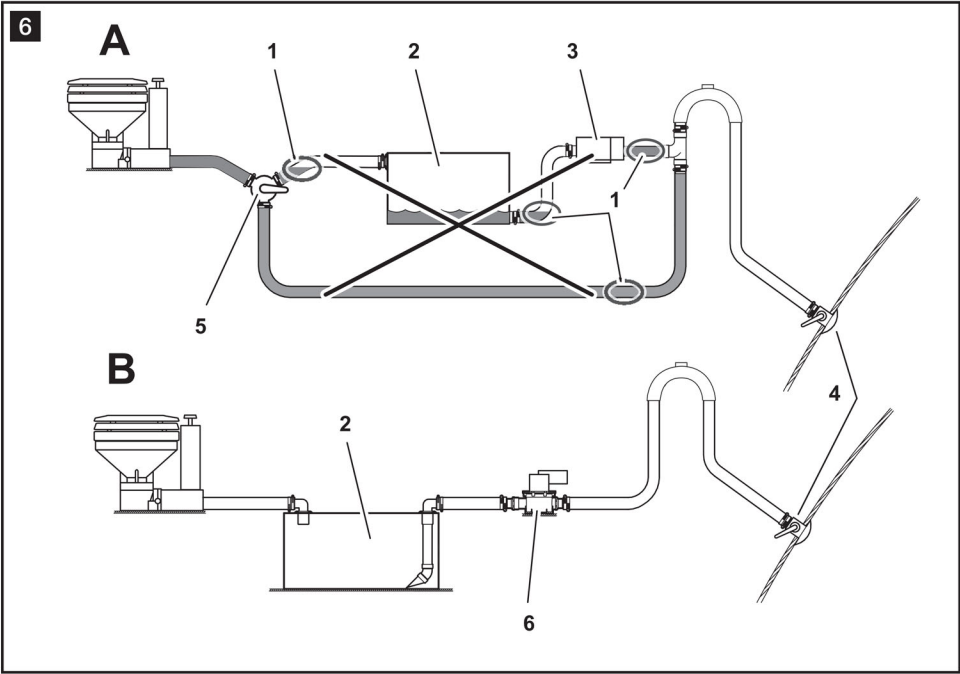
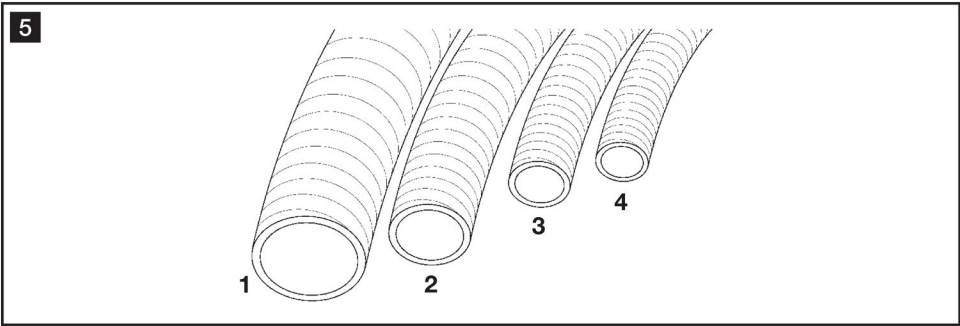
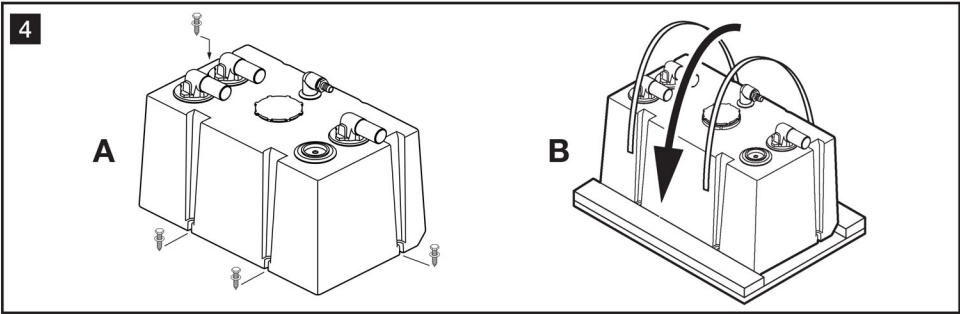

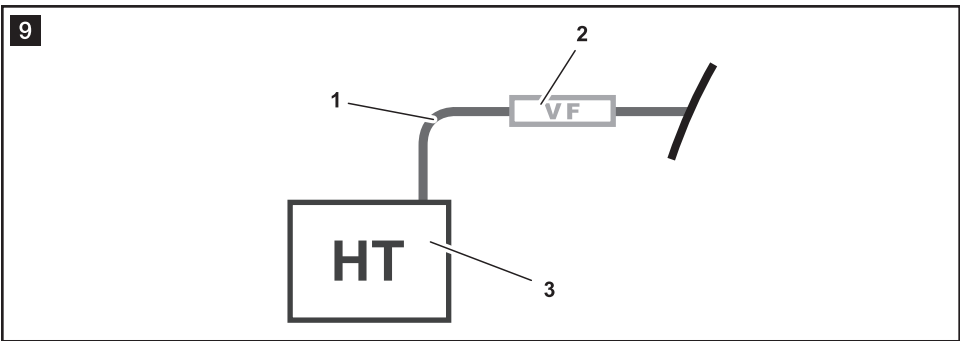
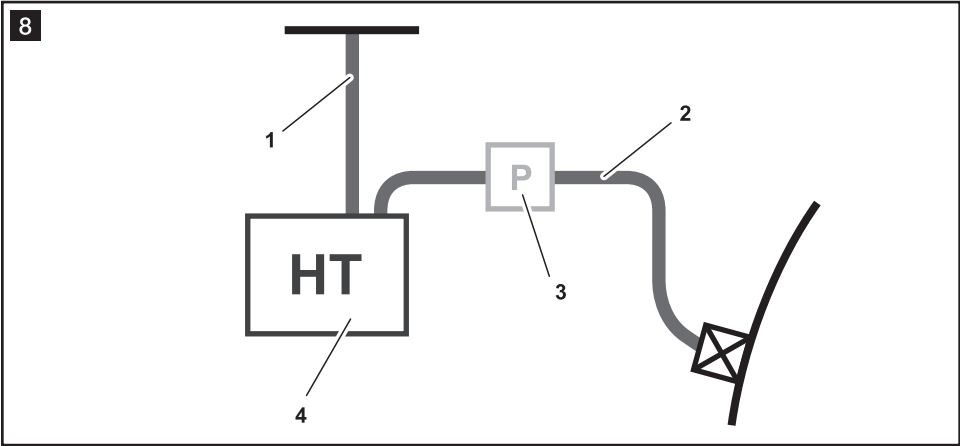
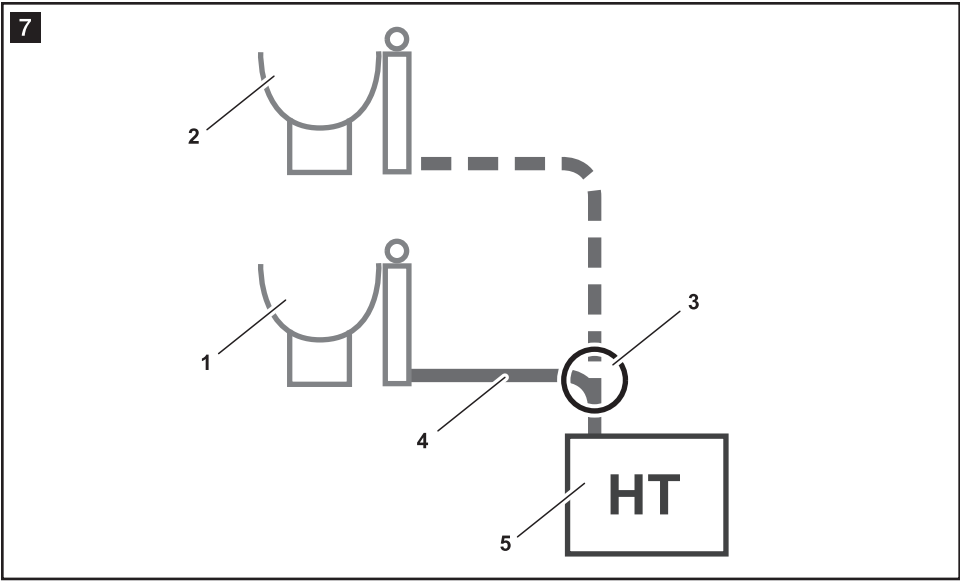

10

A

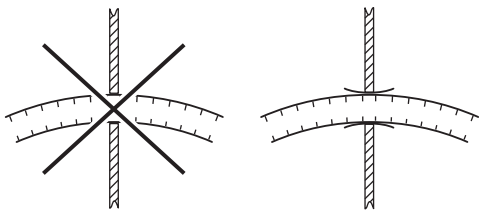

B

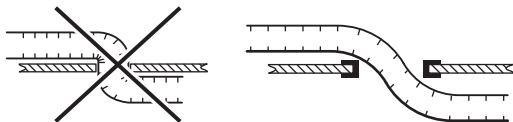

C

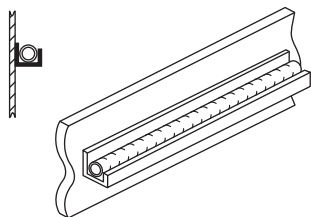

11

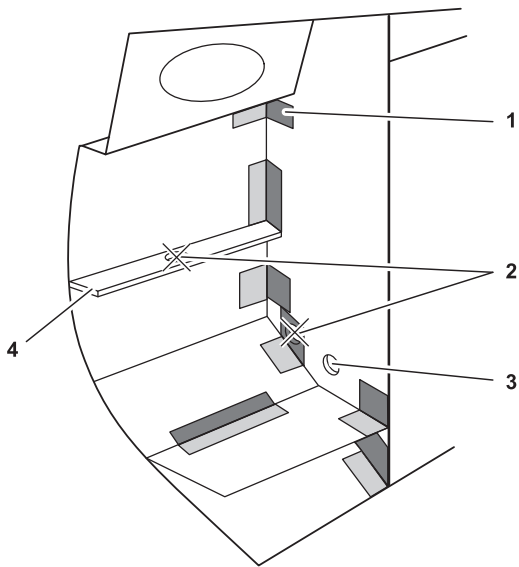

12

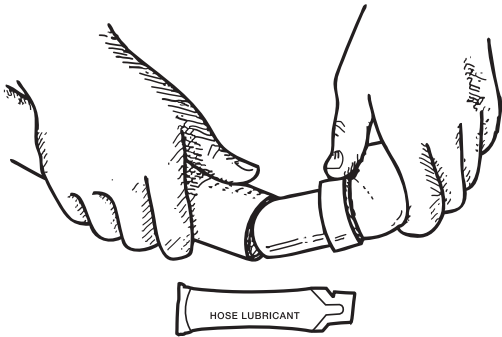

13

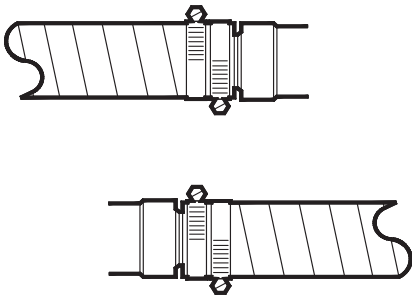



Table of contents	EN
-------------------	----

1	Notes on using the manual	8
2	General safety instructions	8
3	Intended use	9
4	Components and Functions	9 - 10
5	Tank Installation.	10 - 11
6	Hose Installation	11 - 14
7	Cleaning and Winterizing.	14
8	Specifications	14
9	Warranty and Product Liability	15 - 16

1 Notes on using the manual

 **Caution!**
Safety Instruction: Failure to observe this instruction can cause material damage and impair the function of the device.

 **Note**
Supplementary information for operating the device.

fig. 2 1, page 3 : This refers to an element in an illustration. In this example, item 1 in figure 2 on page 3.

2 General safety instructions

The manufacturer will not be held liable for claims for damage resulting from the following:

- Faulty assembly or connection
- Damage to the system or any components from mechanical influences, misuse or abuse
- Alterations to the holding tank system without express permission from the manufacturer
- Use for purposes other than those described in the operating manual

When using electrical devices to install this system, observe the following safety information to protect against:

- Electric shock
- Fire hazards
- Injury

 **Caution!**
Before working on any part of an existing or newly installed component of a sanitary system, be sure all electrical power to system is turned off and all seacocks are in CLOSED or OFF position. Failure to do so can result in flooding, which can cause the loss of life or property.

3 Intended use

Dometic holding tank systems provide high-quality, long-lasting equipment to store toilet waste-water onboard a vessel, efficiently discharge the effluent at approved disposal facilities or in unrestricted waters, and prevent sewage from spoiling sensitive waters, such as marinas, near swimming beaches or over shellfish beds.

Dometic holding tanks may also be used for greywater use (water from showers, basins, clothes washers, etc.), provided that greywater is the only type of water entering the tank.



Note

Each fixture that discharges greywater into a holding tank must have a water trap seal to prevent odor from entering the living space.



Caution!

Boat operator must know local sewage discharge regulations.

3.1 Benefits of Dometic Holding Tanks

Leakproof design. Dometic holding tank fittings are connected on top of the tank, eliminating the possibility of leaking due to faulty connections below the level of the tank contents.

Odor-free, long-lasting performance. Tanks are made of linear low density polyethylene, the best material for holding tank construction because of its resistance to corrosion and odor permeation. It will last longer than the life of a typical hull.

Implosion protection. Heavy-duty tank and vacuum relief valve combine to prevent potential damage from dockside pumps that may operate at high levels of vacuum.

4 Components and Functions

Items in fig. 2 page 3	Description
1	38 mm (1.5 in.) ID outlet hose connection to deck fitting or seacock
2	38 mm (1.5 in.) ID outlet hose connection to deck fitting or seacock
3	inspection port or location for optional level indicator probe cap
4	16 mm (0.625 in.) ID ventilation hose connection
5	vacuum relief valve
6	38 mm (1.5 in.) ID inlet hose connection from toilet
7	integrated mounting feet (4 locations)



Note

Only one outlet fitting (1 or 2) can be converted to an inlet fitting if required. One outlet must remain in original location on tank. Inlet fitting on opposite side of tank (6) should not be converted to outlet fitting.

4.1 Features

- Pre-installed inlet and two outlets for dockside and seacock connections
- Inlet and outlet fittings rotate to facilitate hose connection from virtually any direction (fig. **3** D, page 3)
- Discharge tubes have special non-clogging design
- Vacuum relief valve protects tank from over-pressure collapse
- Extra fittings allow tank conversion to various inlet and outlet configurations
 - one inlet, two outlets (fig. **3** A, page 3)
 - one inlet, one outlet on same side of tank (fig. **3** B, page 3)
 - one inlet, one outlet on different sides of tank (fig. **3** C, page 3)
- Meets ISO 8099 requirements

5 Tank Installation

5.1 Choose a location for the holding tank

A holding tank should be positioned as low in the hull as possible. Most connecting hoses and pipes should slope downward toward the tank to permit gravity drainage and prevent possible hose odor permeation. Hose connected to an overboard discharge pump should drain away from the tank.

**Caution!**

The holding tank should not be exposed to temperatures above 45°C (120°F). Do not place tank near heat sources such as engine manifolds, water heaters, generators, etc.

In addition to dimensions of tank (fig. **1**, page 2), allow 16 cm (about 6 inches) above tank to easily make plumbing connections.

SERVICE ACCESS – Because Dometic holding tanks may require minimal service in normal operation, the tank must be installed so that there is easy access to the inspection port.

5.2 Prepare a mounting surface

Determine properly located surface that will support the entire area of the tank. If a mounting surface needs to be fabricated, use marine grade plywood at least 13 mm thick. If installing with restraining straps, include toe blocks on mounting surface (fig. **4** B, page 4).

5.3 Install tank on mounting surface

Integrated Mounting Feet Installation (fig. **4** A, page 4)

In the four mounting feet locations around bottom of tank, use at least 6 mm dia. (#12) fasteners with 19 mm maximum dia. (0.75 in.) washers to fasten tank to surface.

Restraining Strap Installation (fig. **4** B, page 4)

With restraining straps of 31 mm (1.25 in.) maximum width, fasten straps over top of tank to mounting surface on both sides of tank, positioning the straps within the channels on the tank.

**Caution!**

Do not install tank on projections, such as fastener heads, which could puncture the tank. Do not allow holding tank to block free flow of bilge water.



Note
Fasteners (lag bolts, screws, washers, etc.) and restraining straps are not supplied with Dometic holding tank.

6 **Hose Installation**

6.1 **Hose selection**

Dometic holding tanks are pre-assembled with 38 mm (1.5 in.) and 16 mm (0.625 in.) ID hose connection fittings. If your sanitation system uses hoses other than these sizes, you may either use fitting adapters to convert from the Dometic fitting sizes to your current hose, or install new hose to match the Dometic tank fittings.

If installing new hose, Dometic OdorSafe® Plus sanitation hose provides the best protection against hose odor permeation for toilet and holding tank discharge lines, and is available in 38 mm (1.5 in.) ID only. Dometic MaxFlex™ hose is available in all the sizes that are listed in the Sanitation, Vent Hose Size Guide (right), and provides high-quality odor-resistance.

Sanitation, Vent Hose Size Guide (fig. **5**, page 4)

Item	Description
1	38 mm (1.5 in.) ID sanitation hose
2	25 mm (1 in.) ID sanitation hose
3	19 mm (0.75 in.) ID vent hose
4	16 mm (0.625 in.) ID vent hose

6.2 **Hose layout**

Key to (fig. **6 , page 4)**

Ref.	Description	Ref.	Description
A	complicated plumbing layout	3	macerator pump
B	simple plumbing layout	4	seacock (overboard discharge)
1	problem hose	5	wye valve
2	holding tank	6	discharge pump

Diagram A indicates an incorrect installation with multiple hose runs that can retain trapped liquids and cause hose odor permeation. Diagram B shows a simplified, highly efficient plumbing system that can be achieved with Dometic’s specially integrated holding tank system design.

Different marine toilet manufacturers use different sizes of outlets. Check outlet size of toilet(s) or size of toilet discharge hose(s) that will connect to holding tank.

- If connecting previous toilet discharge hose to new tank, use adapter fitting to connect to 38 mm tank inlet fitting, if necessary.
- If installing new hose from toilet to tank, use 38 mm ID Dometic OdorSafe Plus hose. Use adapter fitting between toilet and hose, if necessary.
- Use 90° elbow fittings to make bends when radius is less than 210 mm.
- A second inlet fitting is provided with the Dometic holding tank if a separate inlet fitting is preferred and only one outlet fitting is required.
- OdorSafe Plus hose or rigid pipe should be installed on hose runs that may retain sewage.
- Some existing seacocks and through-hull discharge fittings may be 25 mm in diameter. If so, use a 38 mm x 25 mm reducer and 25 mm MaxFlex sanitation hose.



Note
A valve with a lockable handle must be on all through-hull fittings that emit sewage.



Note
Maintenance valves must be installed in any piping runs which retain liquid and are connected to components which require periodic servicing.



Caution – Flooding Hazard!
If the toilet, holding tank or any components are connected to **any** through-hull fittings, properly installed seacocks **must** be installed in all piping connected to the through-hull fittings. Seacocks **must** be easily accessible to all users of the system. All valves **must** be full-bore valves and of marine (corrosion resistant) quality. Screw-to-close gate valves are not recommended. Failure to do so can result in flooding, which can cause the loss of life and property.



Caution – Flooding Hazard!
Some marine practices and/or standards require the installation of a properly positioned ventilated (vented) loop in the discharge piping to prevent back-siphonage of seawater into the holding tank. It is up to the system installer and boat owner to select appropriate means of preventing backflow into the holding tank.

Marine Toilet to Holding Tank (fig. 7 , page 5)

Item	Description
1	First marine toilet (25, 38, or 40 mm discharge)
2	Second marine toilet (25, 38, or 40 mm discharge)
3	Wye or Tee fitting (must be installed in direction of flow)
4	Hose from toilets to holding tank
5	Holding tank

Discharge Hoses (fig. 8 , page 5)

Item	Description
1	Discharge hose to deck fitting (38 mm ID)
2	Discharge hose to seacock and discharge fitting (38 mm ID)
3	Discharge pump
4	Holding tank

Vent Hose (fig. 9 , page 5)

Item	Description
1	Vent hose
2	Vent filter
3	Holding tank

- Vent fitting on Dometic holding tank will accommodate 16 mm ID vent hose.
- Install a Dometic vent filter in the vent line to absorb malodorous gases, letting only freshened air out of the vent.



Note
Vent line must not have any low runs that can create a liquid trap.

6.3 Recommended hose installation methods

Do not restrict the ability to pull the hose or pipe (fig. 10 A, page 6).
Avoid binding corners and sharp bends (fig. 10 B, page 6).
Do not use wire ties to secure hose or pipe. Support flexible hose every 0.3 m (12 inches) and support rigid pipe every 1.5 m (5 feet).
Where possible use a support trough under the hose or pipe (fig. 10 C, page 6).

Bulkhead Penetrations (fig. 11 , page 6)

Check each side of a bulkhead to ensure that there will be no cutting into:

- fuel or water tanks
- wiring or pipes
- reinforcement stringers (4) that support the hull

When creating new holes, avoid tabs (1) and stringers (4) that hold bulkheads or partitions in place. Provide additional reinforcement so that structural integrity is not compromised.

- avoid (2)
- possible (3)

Hose and Heat Sources

The operating temperature of flexible hose prohibits exposure to sources of high or direct heat, such as light bulbs or engine manifolds. If any part of the hose system must be run close to a heat source, use rigid pipe instead of hose.

6.4 Connecting hose to plastic fittings

When connecting flexible hose to plastic fittings (fig. 12 , page 7), use special hose lubricant which is supplied with the Dometic holding tank. Apply lubricant around end of fitting and inside end of hose that connects to fitting. The Dometic lubricant makes connections easier. Do not use any other lubricant, sealant or adhesive.

Hose Clamps (fig. 13 , page 7)

Each hose connection should be secured with two hose clamps to prevent possibility of leaks. Position the clamp screws 180° apart from each other and tighten the clamp. Do not over-tighten clamps or they may cut into the hose. If over-tightening is the only way to stop a leak, the hose-to-fitting connection is not sized correctly, and an adapter or different size fitting is required.

Avoid clamps with nickel-plated screws that are susceptible to corrosion. Use 100 percent stainless steel clamps.



Note

If a clamp screw is slightly magnetic, it may be either a lower grade of stainless steel or nickel plated.

7 Cleaning and Winterizing

7.1 Cleaning

A small amount of water remains in holding tanks at all times, so it is good practice to rinse a holding tank completely after contents have been discharged.

1. After initial pump-out, add holding tank deodorant or cleaner to toilet bowl, and flush with water.
2. Continue flushing and pumping out tank until holding tank discharge is clear.

7.2 Winterizing

Use only propylene glycol freshwater antifreeze to winterize the holding tank. **Make sure the antifreeze does not contain alcohol.**

1. Pump out the holding tank.
2. Thoroughly flush system with fresh water before adding propylene glycol freshwater antifreeze to the holding tank.

8 Specifications

Materials

- Holding tank:polyethylene; 6.3 mm nominal wall thickness. Natural color.
- Fittings:polyvinyl chloride, ABS. White color.
- Sealing grommets:cross-linked EPDM rubber/polypropylene. White color.

Model	Capacity L / US gal.	Empty Weight Kg / lb.	Full Weight Kg / lb.	Dimensions mm / in.
DHT42L	42 / 11	5.4 / 12	47.9 / 105.5	460 x 350 x 348 / 18.1 x 13.8 x 13.7
DHT61L	61 / 16	7.7 / 17	69.4 / 153	660 x 350 x 348 / 26.0 x 13.8 x 13.7
DHT88L	88 / 23	10.2 / 22.5	98.9 / 218	800 x 400 x 388 / 31.5 x 15.7 x 15.3
DHT110L	110 / 29	14 / 30.9	125.9 / 277.4	1200 x 350 x 348 / 47.2 x 13.8 x 13.7
DHT137L	137 / 36	14.5 / 32	153.3 / 338	1200 x 400 x 388 / 47.2 x 15.7 x 15.3

Dometic DHT-L series holding tanks are pressure-tested to 30 kPa (0.3 bar, 4 PSI).

9 Warranty and Product Liability

Europe:

Warranty and Customer Service

Warranty arrangements are in accordance with EC Directive 44/1999/CE and the normal conditions applicable for the country concerned. For warranty or other service, please contact our Dometic/Waeco Service department listed elsewhere in this manual. Any damage due to improper use is not covered by the warranty.

The warranty does not cover any modifications to the product or the use of non-original Dometic parts; the warranty does not apply if the installation and operating instructions are not adhered to and no liability shall be entertained.

Product Liability

Product liability of Dometic Group and its subsidiary companies does not include damages which may arise from: faulty operation; improper alterations or intervention in the equipment; adverse effects from the environment which may impact the equipment itself or the direct vicinity of the equipment or persons in the area.

To obtain warranty service, first contact your local dealer from whom you purchased this product or go to <http://www.dometic.com> to locate a dealer near you.

North America and Rest of the World:

Manufacturer's Limited Warranty

Dometic Corporation, Sanitation Division warrants to the original purchaser only that this product, if used for personal, family or household purposes, is free from defects in material and workmanship for a period of one year from the date of purchase.

If this Dometic product is placed in commercial or business use, it will be warranted to the original purchaser only to be free of defects in material and workmanship for a period of ninety (90) days from the date of purchase.

Dometic reserves the right to replace or repair any part of this product that proves, upon inspection by Dometic, to be defective in material or workmanship. All labor and transportation costs or charges incidental to warranty service are to be borne by the purchaser-user.

EXCLUSIONS

IN NO EVENT SHALL DOMETIC BE LIABLE FOR INCIDENTAL OR CONSEQUENTIAL DAMAGES, FOR DAMAGES RESULTING FROM IMPROPER INSTALLATION, OR FOR DAMAGES CAUSED BY NEGLIGENCE, ABUSE, ALTERATION OR USE OF UNAUTHORIZED COMPONENTS. ALL IMPLIED WARRANTIES, INCLUDING ANY IMPLIED WARRANTY OF MERCHANTABILITY OR FITNESS FOR ANY PARTICULAR PURPOSE, ARE LIMITED TO A PERIOD OF ONE YEAR FROM DATE OF PURCHASE.

(continued on next page)

IMPLIED WARRANTIES

No person is authorized to change, add to, or create any warranty or obligation other than that set forth herein. Implied warranties, including those of merchantability and fitness for a particular purpose, are limited to one (1) year from the date of purchase for products used for personal, family or household purposes, and ninety (90) days from the date of purchase for products placed in commercial or business use.

OTHER RIGHTS

Some states do not allow limitations on the duration of an implied warranty and some states do not allow exclusions or limitations regarding incidental or consequential damages; so, the above limitations may not apply to you. This warranty gives you specific legal rights, and you may have other rights which vary from state to state.

To obtain warranty service, first contact your local dealer from whom you purchased this product or go to <http://www.dometic.com> to locate a dealer near you.