



rammount.com
1.800.497.7479
support@rammount.com

RAM® Twist-Lock™ Suction Cup Base

Part Index

*not to scale

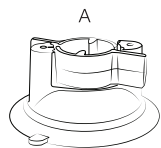

x 1



x 2

- 1 Connect Ball base or adapter plate to the suction cup base, driving the self-tapping screws into the holes.

*For best results, non-powered screwdriver is recommended. Do not over tighten.

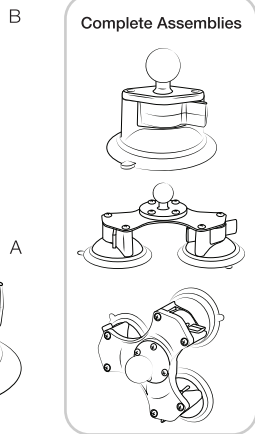
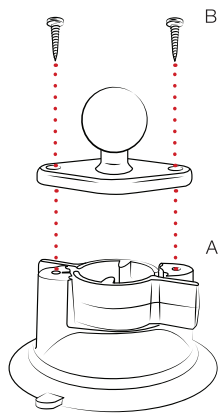

- 2 Clean surface thoroughly. Align the suction cup to surface. While holding the lever to the OFF position, push the plastic base onto the surface flush with the silicon base and switch the lever to the lock position. Suction cup base must be locked flush with the silicon for a successful hold.

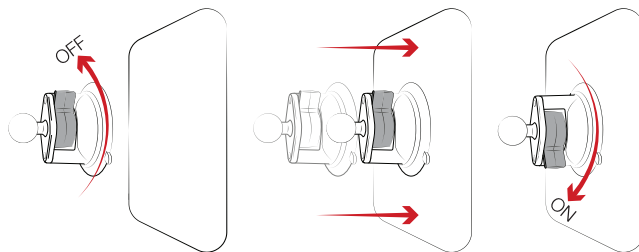

RAM® Twist-Lock™ Suction Cups are only compatible with smooth, non-porous surfaces (no rough or textured surfaces). Clean surface thoroughly before applying suction. When left unattended in extreme temperatures, it is recommended to remove and stow suction cups. Suction cups are considered a general wear item and are not covered under any warranty.

RPR-INS-224-1



Safety Precaution

Do not install this product near or over an airbag deployment area or in a location that obstructs the driver's vision or interferes with vehicle operation. National Products, Inc does not assume responsibility or liability for any such personal injury, death or property damage.



rammount.com
1.800.497.7479
support@rammount.com

RAM® Action Camera Universal Ball Adapter

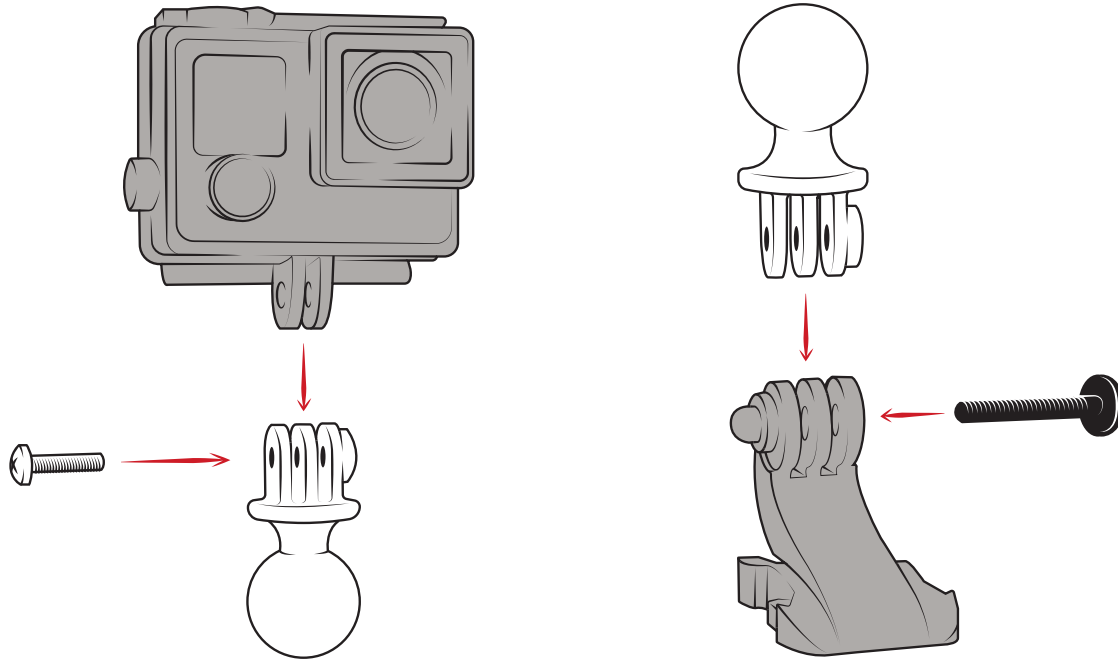

RMR-INS-GOP1