

# **SEAVIEW**

**ELEVATE YOUR ELECTRONICS**

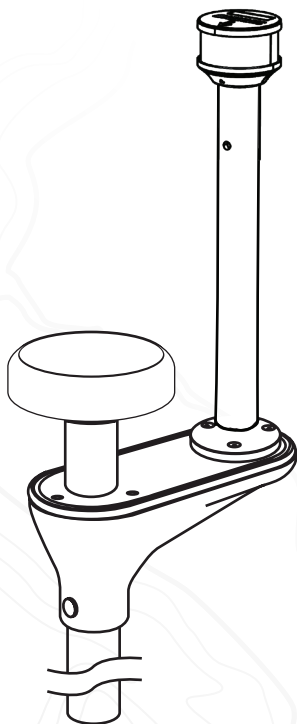

## **INSTALLATION INSTRUCTIONS**

For Seaview Light Bar Top:

**LTBU1ALED12**

Refer to website for most up to  
date instructions and videos.

**[WWW.SEAVIEWGLOBAL.COM](http://WWW.SEAVIEWGLOBAL.COM)**

# PARTS INCLUDED

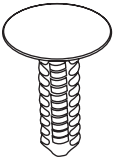

**x2**  
(LTBRVT)

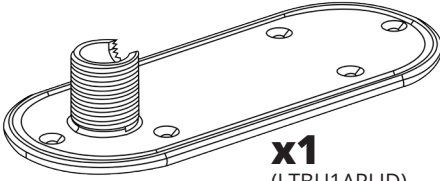

**x1**  
(LTBU1APLID)



**x3**  
(1058PFHSMS)

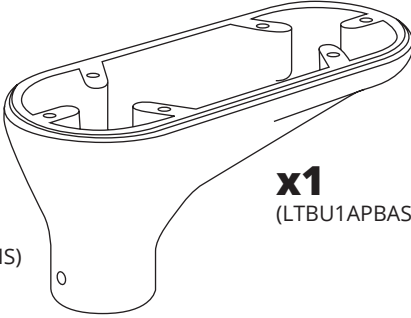

**x1**  
(LTBU1APBASE)

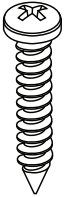

**x3**  
(101PPHSMS)



**x3**  
(10NW)

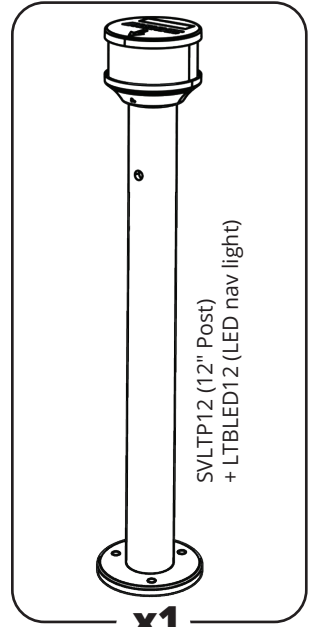

SVLTP12 (12" Post)  
+ LTBLED12 (LED nav light)

**x1**

# TOOLS NEEDED



Sudbury Elastomeric Marine Sealant is recommended. To purchase call 800-655-7922 or visit [www.seaviewglobal.com](http://www.seaviewglobal.com)



1/16 inch = 5mm

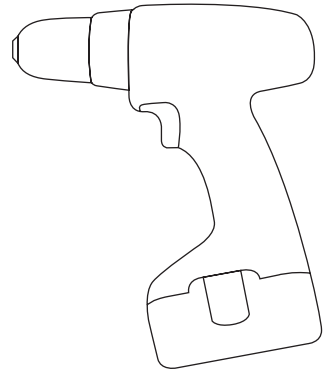

**1** Drill a hole to run cables for the light. This may have already been done for you.

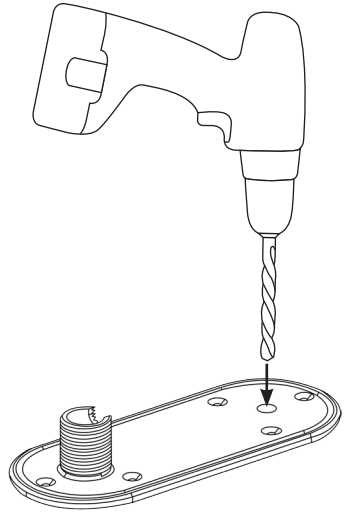

**2** Apply marine adhesive sealant around the top of the light bar as shown, then slide on to the light bar.

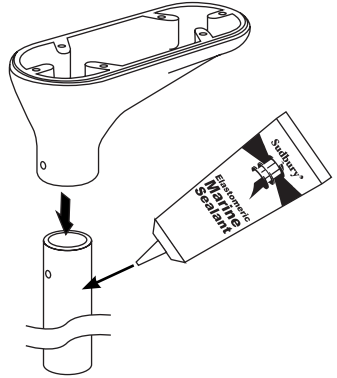

**3** Apply marine adhesive sealant to the mounting holes. Then insert the two plastic rivets into holes as shown.

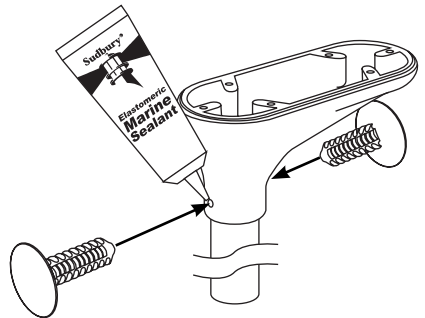

**4** Apply marine adhesive sealant into the groove as shown.

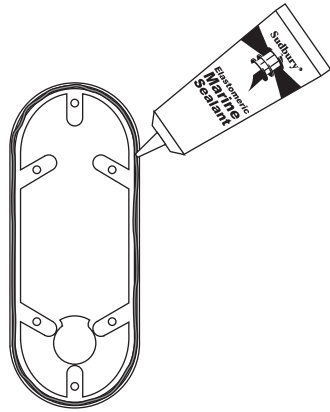

**5** Make sure the GPS & light wires are running through the lid and down the hole into the light bar. Apply marine sealant to the bottom of the light post and then screw this to the lid and base (use screws 101PPHMS). Make sure the light post is facing the forward position (arrow on top of the light is facing forward and the rivet hole on the light post is facing forward). Screw the lid to the base with the 3 screws provided (1058PFHMS). Thread the GPS to the 1-14 threads on the lid. It is recommended to apply marine sealant to all the screws.

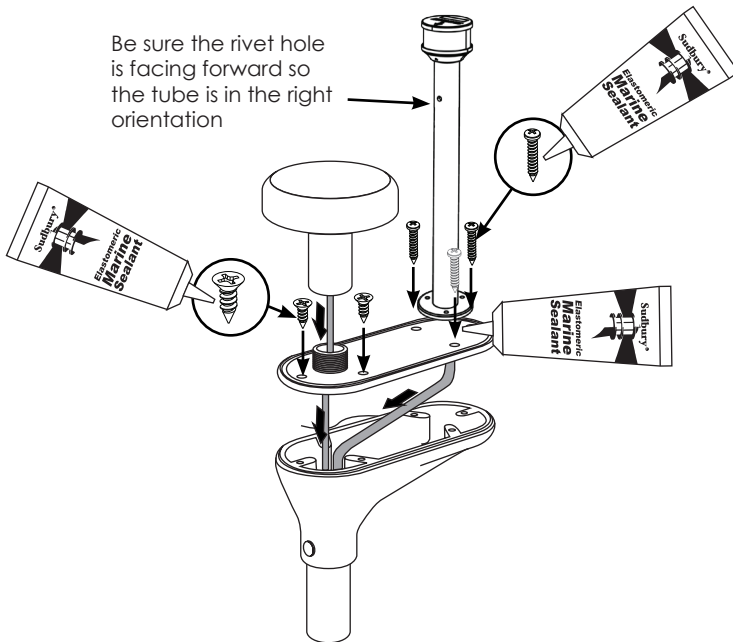

# OPTIONAL ACCESSORIES

Call 800-655-7922 or visit [www.seaviewglobal.com](http://www.seaviewglobal.com) for available accessories.

## SPREADER KIT

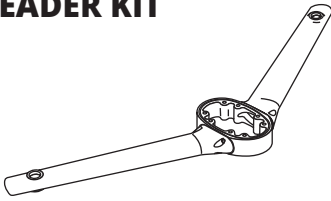

### SP1-MOD

Allows user to mount GPS units or antennas onto a Seaview Modular Mount.

## WEDGES

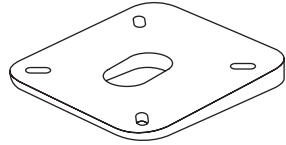

Compensates for plane angle.  
Available in 2, 4 or 6 degree wedges.

## HINGES

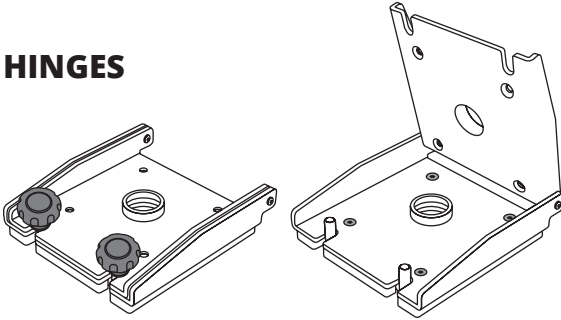

Seaview Hinge Adapters fold in any direction necessary for added height clearance.



## LTLED12 LED Combination Masthead and All-Round White (Anchor) Light

The above light is designed for use on sail or power driven vessels under 20 meters (65.6 ft.) in length operating on a nominal 12 volt system. In order to comply with '72 COLREGS and U.S. Inland Rules, the following must be adhered to:

**MOUNTING INFORMATION**  
Read all instructions before proceeding.

- 1) These instructions show the orientation of each light. For proper light selection, positioning and configuration, refer to A.B.Y.C. Standard A-16\*, the '72 COLREGS and the U.S. Inland Navigation Rules\*. These lights are supplied complete with 12 volt LED's. LED lights have no user serviceable parts.
- 2) These lights are designed to be mounted on a horizontal surface.
- 3) These lights are furnished for mounting such that the long dimension of the mounting base is parallel to the fore-aft centerline of the boat.
- 4) This light is furnished with a 3/4 inch tube and is designed to be mounted vertically into a 3/4 inch hole.
- 5) **WIRING:** Please choose from the configurations that meet your current wiring.

Attach supply connections to the light making sure to wire in accordance with both A.B.Y.C. Standard E4\* and U.S. Coast Guard Safety Standards for Boat Electrical Systems (33 CFR 183)\*.

The connection wires are coded as follows:

WHITE: Steaming: Forward compartment only (masthead light) positive lead supply.  
 RED: Anchor: Forward compartment and aft compartment (anchor light) positive lead supply.  
 BLACK: Ground: Negative lead supply.

Electrical connections are to be made such that only the forward compartment (masthead light) is energized with the other running lights (sidelights, stern lights etc.) while underway. Both compartments are energized simultaneously by themselves to create the all-round (anchor) light.

- 6) Make sure the top of the light is vertical during operation (see illustration) and the arrow on the top cover points ahead (not astern), with the reference mark parallel to the fore-aft centerline of the boat.

\*The above referenced standards can be obtained from:  
 (1). American Boat & Yacht Council, Inc.  
 613 Third Street, Suite 10  
 Annapolis, MD 21403  
 (2). U.S. Coast Guard  
 Washington D.C. 20593  
 (or your local C.G. office)

### WIRING DIAGRAMS

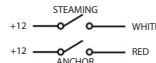

**Diagram A**  
(Rotary Switch)



White	Red	Light Status
0	0	OFF
+12	0	Steaming
0	+12	Anchor

**Diagram B**  
(Two Switches)



White	Red	Light Status
0	0	OFF
+12	0	Steaming
0	+12	Anchor
+12	+12	Anchor

**Diagram C**  
(SPDT Toggle Switch)

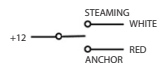

White	Red	Light Status
0	0	OFF
+12	0	Steaming
0	+12	Anchor
+12	+12	Anchor

### CONFIRM LIGHT MOUNTING

Arrow should be pointing forward (Ahead)



### APPROPRIATE WIRE INSTALLATION

Using Waterproof Butt Connectors (not included)

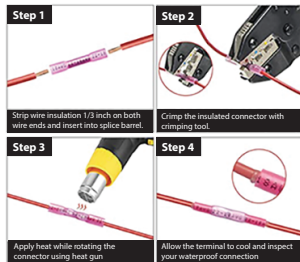

**Prop. 65 Warning for California Residents**  
 WARNING: This product may contain chemicals known to the State of California to cause cancer, birth defects, or other reproductive harm.

A background of a topographic map with contour lines, rendered in a light gray color. The map shows various landmasses and water bodies, with the lines indicating elevation or depth.

***SEAVIEW***///  
***ELEVATE YOUR ELECTRONICS***

***SEAVIEW***///

Tel: 800-655-7922  
[www.seaviewglobal.com](http://www.seaviewglobal.com)

***EUROPEAN OFFICE***

Tel: +33 4 94 53 27 70  
[www.seaviewprogress.com](http://www.seaviewprogress.com)

1-03122023