



APOLLO™ RA770/RA800 RETROFIT KIT

INSTALLATION INSTRUCTIONS

Important Safety Information

WARNING

Failure to follow these warnings and cautions could result in personal injury, damage to the vessel, or poor product performance.

See the *Important Safety and Product Information* guide in the stereo box for product warnings and other important information.

This device must be installed according to these instructions.

Disconnect the vessel's power supply before beginning to install this product.

CAUTION

Always wear safety goggles, ear protection, and a dust mask when drilling, cutting, or sanding.

NOTICE

When drilling or cutting, always check what is on the opposite side of the surface.

You must read all installation instructions before beginning the installation. If you experience difficulty during the installation, go to support.garmin.com.

What's In the Box

- Two mounting plates
- Four M4 Phillips screws
- Two screw covers
- Template

Tools Needed

- Rotary cutting tool, utility knife, or file
- Phillips screwdriver
- Silicone-based marine sealant (optional)

Mounting Considerations

You can use this kit to install a FUSION® Apollo RA770 or RA800 stereo in a single-DIN opening or if you are replacing a previous FUSION stereo, such as a MS-UD/AV650/755 stereo.

The metal brackets in this kit hold the stereo in place from behind the mounting surface. To allow for clearance of the screws from the stereo to the mounting plates, you may need to remove some existing material from the dashboard by following these installation instructions.

NOTE: The dust cover included with the Apollo RA770 or RA800 is not compatible when using larger screw covers included in this kit.

Installing the Stereo Using the Mounting Kit

- 1 If necessary, remove the existing stereo from the dashboard, and clean the surface of any existing gaskets or marine sealant.
- 2 Place the included template over the opening and observe the location of the Apollo RA770 or RA800 stereo mounting holes in relation to the existing opening on the dashboard.
- 3 Select an option:
 - If the existing opening allows clearance for the stereo mounting holes, remove the template and proceed to step 7.
 - If the existing opening does not allow clearance for the stereo mounting holes, proceed to the next step.
- 4 Using the template as a guide, remove material from the dashboard around the screw locations ① with a rotary cutting tool, utility knife, or a file.

NOTICE

Make sure you remove only enough material to allow the screws clearance, because there is not significant space between the screws and the edge of the stereo. Removing excess dashboard material may be visible after installation, and could allow for unwanted water ingress.

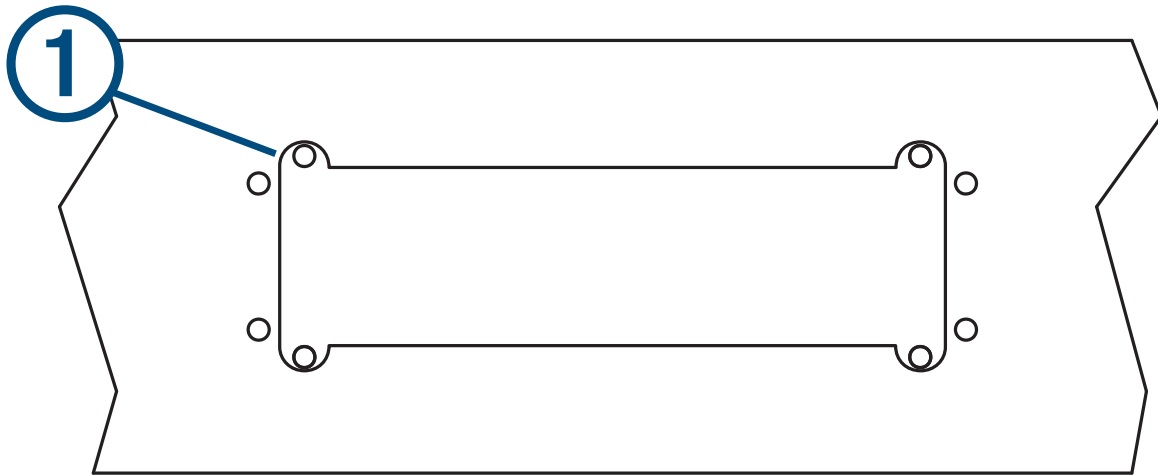

- 5 Place the stereo in the opening to test the screw clearance.
When you can look through all four mounting holes on the stereo and not see any dashboard material, you have prepared the dashboard correctly.
- 6 If necessary, use a file to refine the shape or size of the screw clearance area.

7 Select an option:

- If you are installing the stereo in a dry location, place the mounting gasket ② (included in the stereo box) on the back of the stereo.
- If you are installing the stereo in a location that is exposed to water, apply silicone-based marine sealant on the mounting surface around the cutout.

NOTICE

Do not install the mounting gasket if you applied sealant to the mounting surface. Using sealant and the mounting gasket may reduce water resistance.

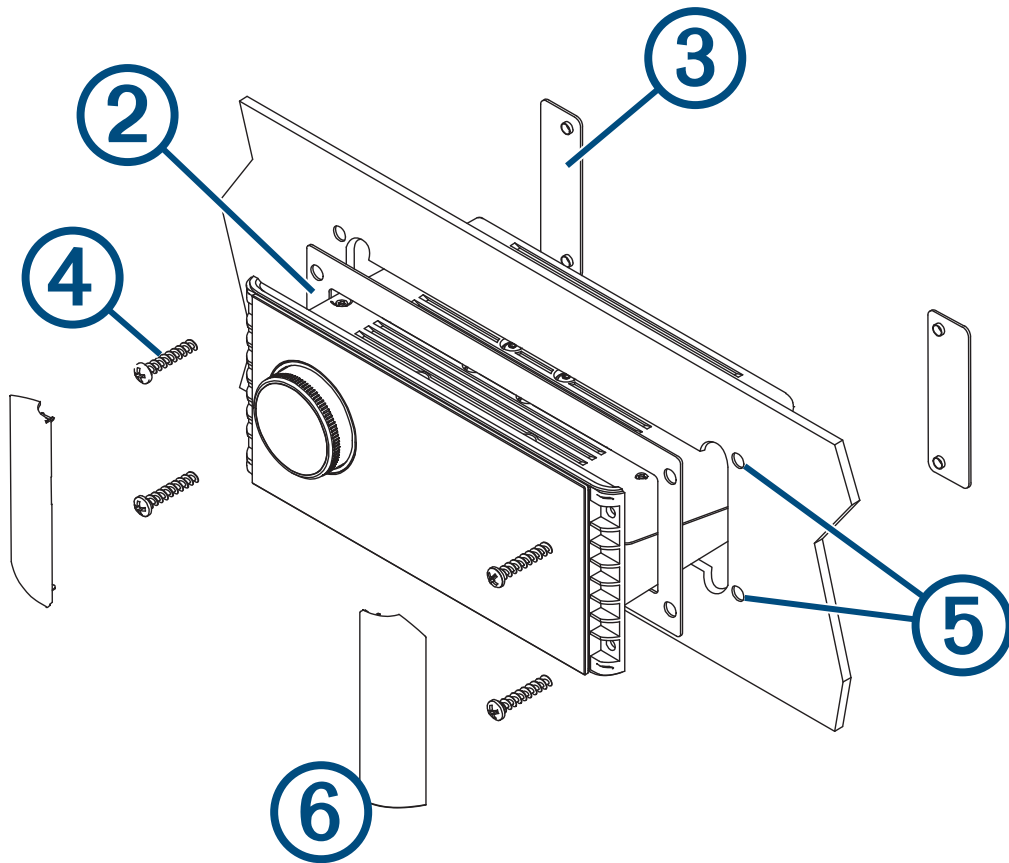

- 8 Follow the installation instructions included with the stereo to make the necessary wiring connections through the dashboard.
- 9 Secure the stereo to the included mounting plates ③ behind the dashboard using the screws included in the kit ④.

You must use the screws provided in the kit instead of the screws provided with the stereo. The screws included in the kit are designed for use with the mounting plates.

- 10** If you are replacing a previous stereo, fill the screw holes from the previous stereo installation ⑤ with marine sealant.

NOTICE

Failure to completely fill the previous screw holes with marine sealant may allow for water ingress behind the dashboard.

- 11** Snap the screw covers ⑥ into place on the sides of the stereo.

NOTE: If you are replacing a previous stereo, you must use the included screw covers when installing the stereo using this kit. The screw covers included with the stereo are smaller, and do not visually cover the screw holes from the previous stereo installation.

© 2025 Garmin Ltd. or its subsidiaries

Garmin®, FUSION®, and the Fusion logo are trademarks of Garmin Ltd. or its subsidiaries, registered in the USA and other countries. Apollo™ is a trademark of Garmin Ltd. or its subsidiaries. These trademarks may not be used without the express permission of Garmin.