



SWIFT. SILENT. SECURE.

## M-BRACE PONTOON BRACKET SALES SHEET

### Adapter Plate Selection

Measure the distance between the outside edges of the M-Brace to determine what bracket best fits your pontoon model. **Fig. 1**

The measurement "X" correlates to the numbers in the item code.

There are 4 width options:

- 13" - 14 1/2"
- 14 1/2" - 16"
- 16" - 17 1/2"
- 17 1/2" - 19"

**NOTE:** If an m-brace measures exactly 14 1/2", 16", or 17 1/2" across, use the smaller plate size.

**IMPORTANT:** This adapter plate was **not** designed to fit boats that have a curved m-brace.  
**Fig. 1-A**

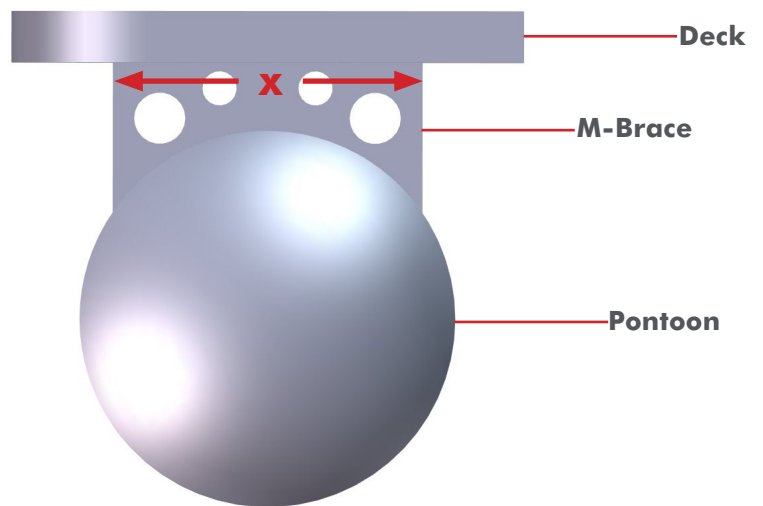

Figure 1

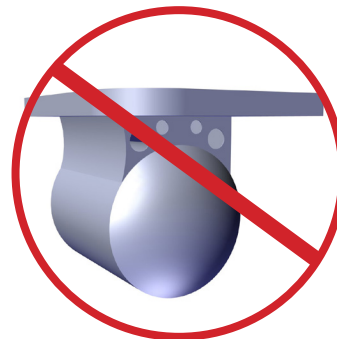

Figure 1-A

Need help? Contact our Technical Support Team at **1 + 813.689.9932 Option 2**



SWIFT. SILENT. SECURE.

# M-BRACE PONTOON BRACKET SALES SHEET

## Deck Clearance

**Fig. 2** shows the maximum length the deck can extend past the pontoon without interfering with Power-Pole Anchor.

**NOTE:** Adapter plates are designed to make Power-Pole Anchors sit vertical once mounted. However, our 11° wedge (**AW-11deg-BK**) may be required for clearance. This will cause the Power-Pole Anchor to sit at a slight angle.

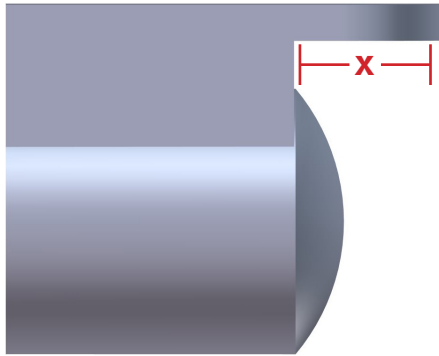

Figure 2

### Maximum Deck Overhang (X):

- BLD 8'/10': 16"
- Pro 2/SPN 2: 16.5"
- BLD 8'/10' With 11° Wedge: 18.5"
- PRO 2/SPN 2 With 11° Wedge: 19"

## M-Brace Cuts

If the back of the M-Brace is covered, a hole may need to be cut to fit the backer plates behind the pontoon mounting surface. Follow accompanying diagrams for mounting suggestions. **Fig. 3-A** and **Fig. 3-B**

**WARNING!** Check before cutting to ensure there are no hoses or wires behind the m-brace. Also check with manufacturer to ensure your boat's warranty won't be voided when cutting to install the M-Brace Pontoon Bracket.

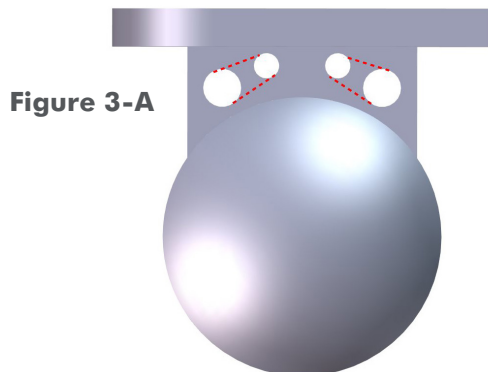

Figure 3-A

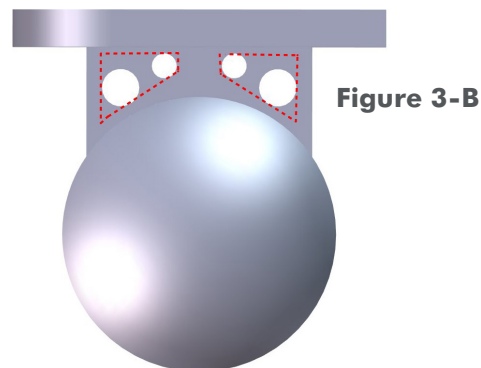

Figure 3-B

Need help? Contact our Technical Support Team at **1 + 813.689.9932 Option 2**



9010 Palm River Road, Tampa, Florida 33619  
phone 813.689.9932 • fax 813.689.8883 • power-pole.com  
©2018 all rights reserved. Power-Pole Shallow Water Anchor U.S. Patent No. 6,041,730