



## CARE AND USE GUIDE

### HYDRATION BOTTLES

#### GENERAL CARE

- Before first use, wash all parts with warm, soapy water. Rinse all parts thoroughly and allow time to dry.
- Contents should not be left in the container for longer than 24 hours. As soon as possible after each and every use, wash all parts with warm, soapy water. Rinse all parts thoroughly with clean water. Allow all parts to dry completely prior to next use or storage
- DO NOT use abrasive cleaners or scrubbers since they may dull the finish.
- DO NOT use bleach or cleaners containing chlorine on any parts of the product.
- This product is top-rack dishwasher safe; however, hand washing is recommended as the dishwasher uses harsher detergents and hot water that may affect the appearance of your product.
- Residual liquids, foods, or other contents may become trapped between product components, such as lid parts, container parts, gaskets (flexible band around lid and/or stopper), or straws (if present in the product). Although this product is top-rack dishwasher safe, hand washing is recommended to ensure that all parts of the product are thoroughly cleaned.

#### ASSEMBLY & USE

##### Hard Spout Lid with Push Button and Slide Lock:

1. Remove lid (A) by twisting counterclockwise.
2. Unlock the slide lock (B) by sliding the lever to the “unlocked” position. Press the push-button (C) on the lid (A) to open lid cover (D).
3. Pull out O-ring gasket (A1) from underside of lid (A) and spout gasket (D1) from underside of lid cover (D).
4. Wash all parts separately and re-assemble. a. Ensure gaskets are properly seated to minimize leaking.
5. Fill container with contents. Do not overfill: Leave space for lid (A) to avoid overflow.
6. Replace the lid (A) by twisting it clockwise.
7. To drink, Unlock the slide lock (B) by sliding the lever to the “unlocked” position. Push the button (C) located on the lid (A), which will release the lid cover (D) and reveal the drink spout (E).
8. When finished drinking, close and lock the lid cover (D) by pushing the lid cover firmly down and lock the product by switching the slide lock (B) to the “locked” position.
9. The rotating intake meter (F) (if present) can be used to manually track how many bottles of liquid that are consumed. To use the intake meter, manually rotate the meter to the number “1” position as shown and after each bottle of liquid is consumed, rotate the meter counterclockwise to the next higher number to track your consumption.

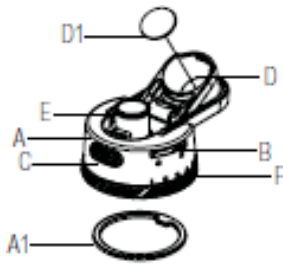

Image for reference only. Actual product may vary.

#### Hard Spout Lid with Twist Drink Spout Cover:

1. Remove lid (A) by twisting counterclockwise.
2. Unlock the drinking spout cover (B) by twisting spout cover counterclockwise until the cover fully stops twisting (about 1/4 turn). Pull up on spout cover to open and expose drinking spout (C).
3. Pull out O-ring gasket (A1) from underside of lid (A) and spout cover gasket (B1) from underside of spout cover (B).
4. Wash all parts separately and re-assemble.
  - a. Ensure gaskets are properly seated to minimize leaking.
5. Fill container with contents. Do not overfill: Leave space for lid (A) to avoid overflow.
6. Replace the lid (A) by twisting it clockwise.
7. To drink, unlock the drinking spout cover (B) by twisting spout cover counterclockwise until the spout cover fully stops twisting (about 1/4 turn). Pull up on spout cover to open and expose drinking spout (C).
8. When finished drinking, close and lock the spout cover (B) by twisting spout cover clockwise until the spout cover fully stops twisting (about 1/4 turn).

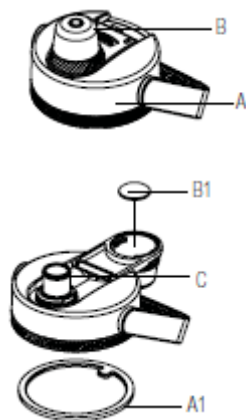

Image for reference only. Actual product may vary.

#### Flip-Up Straw Lid (If Present):

1. Remove lid (A) by twisting counterclockwise.
2. Pull on the straw tab (B1) on the sipper straw (B) to open.
3. Pull the straw stem (D) out of bottom of the lid (A).
4. Pull out O-ring gasket (A1) from underside of lid (A).

5. Wash all parts separately and re-assemble.
  - a. Ensure gaskets are properly seated to minimize leaking.
6. Fill container with contents. Do not overfill: Leave space for the lid (A) and straw stem (D), to avoid overflow.
7. Replace lid (A) by twisting clockwise.
8. To drink, pull on the straw tab (B1) on the sipper straw (B) to open.
9. When finished drinking, press the sipper straw (B) down to closed position.
10. The rotating intake meter (C) (if present) can be used to manually track how many bottles of liquid that are consumed. To use the intake meter, manually rotate the meter to the number “1” position as shown and after each bottle of liquid is consumed, rotate the meter counterclockwise to the next higher number to track your consumption.

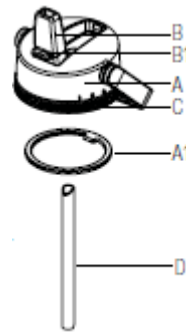

Image for reference only. Actual product may vary.

#### Solid Top Lid (If Present):

1. Remove lid (A) by twisting counterclockwise.
2. Pull out O-ring gasket (A1) from underside of lid (A).
3. Wash all parts separately and re-assemble.
4. Fill container with contents. Do not overfill: Leave space for lid (A) to avoid overflow.
5. Replace the lid (A) by twisting it clockwise.

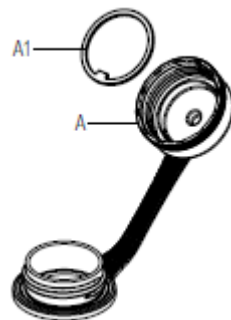

Image for reference only. Actual product may vary.

#### WARNINGS

- DO NOT use product in microwave, on stove-top, or in any type of oven.
- NOT FOR USE WITH HOT LIQUIDS: For cold liquids only. Hot liquids may burn or scald user.
- Always test temperature of contents before consuming.
- DO NOT overfill the container: Leave space at top of container for lid to avoid overflow.

- Check periodically to make sure any gasket (flexible band around lid and/or stopper) is present and properly positioned to prevent contents from passing through stopper when stopper is closed (if applicable to product). Missing, worn or misaligned gaskets may cause product to leak.
- In general, contents should not be left in container for longer than 24 hours. However, the rate at which contents spoil depends on several factors. Certain contents that include, for example, dairy and/or tomato may start to spoil sooner. Proceed with caution when using the product with quick spoiling contents.
- If contents are left in container longer than 24 hours, or you suspect spoilage, use caution when opening container. Contents spoilage can cause pressure inside container to build, possibly leading to forceful ejection of stopper or contents. In such circumstances, before attempting to open container, ENSURE THE OPENING IS POINTED AWAY FROM THE USER OR OTHER PERSONS TO AVOID INJURY.
- DO NOT use tools or devices to force container to open.
- If you are unable to open container by hand, do not open it and dispose of it at your local waste facility.
- DO NOT use to store or carry carbonated drinks or dry ice. This may cause lid/stopper and contents to eject forcefully or leak.

#### LIMITED WARRANTY

Thermos L.L.C. warrants this Genuine Thermos Brand product to be free from defects in material or workmanship for five year from date of purchase. This warranty does not cover ordinary wear and tear or color fading, or any condition affected by abuse, neglect, alteration, accident or improper use or maintenance.

We will, at our option, repair or replace any product component part that fails to conform to this warranty within 30 days after its receipt by our factory service department. IN NO EVENT WILL THERMOS BE LIABLE FOR INCIDENTAL, CONSEQUENTIAL OR SPECIAL DAMAGES.

Some jurisdictions do not allow the exclusion of incidental, consequential or special damages, so the preceding exclusion may not apply to you.

This is a factory guarantee.

Please do not return this product to the retailer.

Send defective unit or component along with written explanation of defect directly to:

Thermos L.L.C. - Warranty Service  
 355 Thermos Road Batesville, MS 38606, USA  
 1-800-831-9242  
[www.thermos.com](http://www.thermos.com)

In Canada:

1-800-669-7065  
[www.thermosbrand.ca](http://www.thermosbrand.ca)

This warranty gives you specific legal rights and you may also have other rights, which vary from state to state or province to province.

THE FOREGOING WARRANTY IS EXCLUSIVE AND IN LIEU OF ALL OTHER WARRANTIES, REPRESENTATIONS OR CONDITIONS OF QUALITY AND PERFORMANCE, WHETHER WRITTEN, ORAL OR IMPLIED, INCLUDING ANY IMPLIED WARRANTIES OF MERCHANTABILITY OR FITNESS FOR A PARTICULAR PURPOSE. SUCH IMPLIED WARRANTIES, REPRESENTATIONS AND CONDITIONS ARE HEREBY DISCLAIMED. THE REMEDIES STATED HEREIN CONSTITUTE PURCHASER'S EXCLUSIVE REMEDIES AND THERMOS'S ENTIRE LIABILITY FOR ANY BREACH OF WARRANTY.

© 2019 Thermos L.L.C. All rights reserved.

THERMOS is a registered trademark in over 115 countries.